

W REDOUBT AVE

HALCYON VILLAS

440

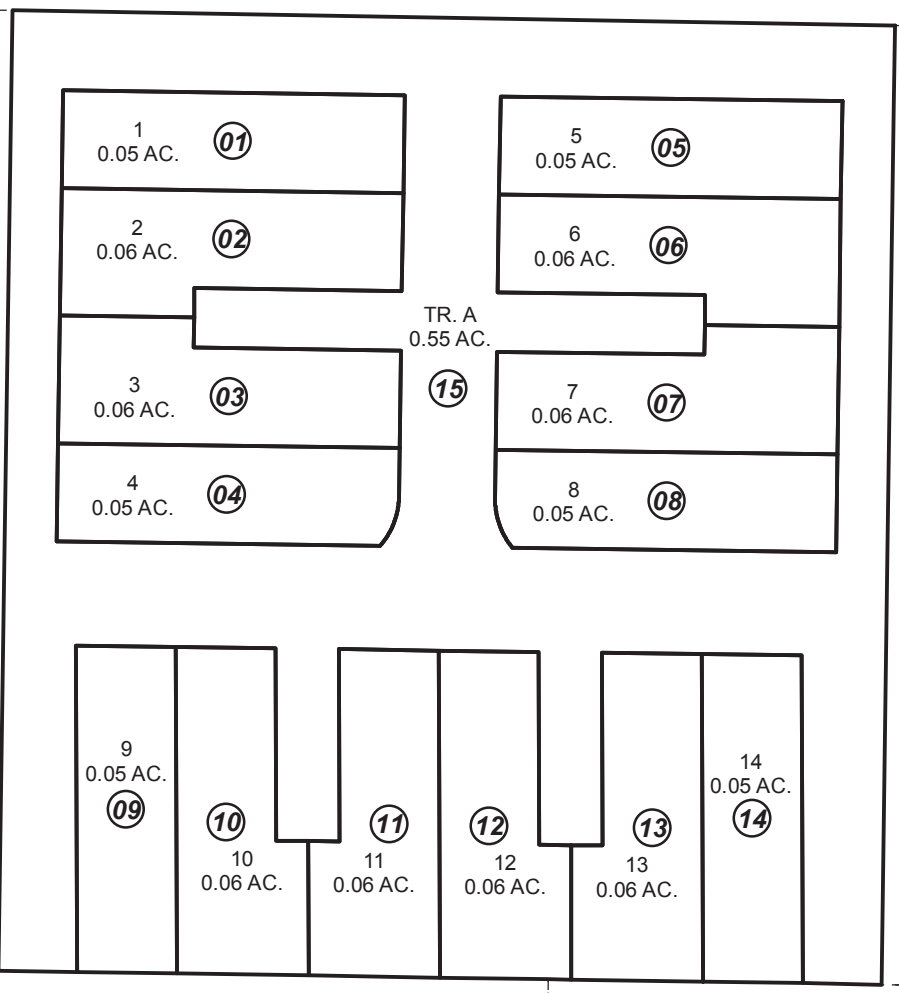

440

(7)

(6)

440

(2)

DECEMBER 5, 2017

For 2018 assessment roll		
Delete	Add	Revise
To		
NEW PAGE		

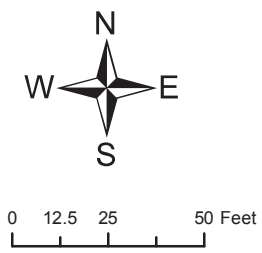

Assessor's Map
Kenai Peninsula Borough

HAKCYON VILLAS SUB KN2017061

This map is prepared for Kenai Peninsula Borough Assessing Dept. use only and is not intended for conveyance nor is it a survey.

Note- Assessor's block Numbers Shown in Elipses
Assessor's Parcel Numbers Shown in Circles