

15

15

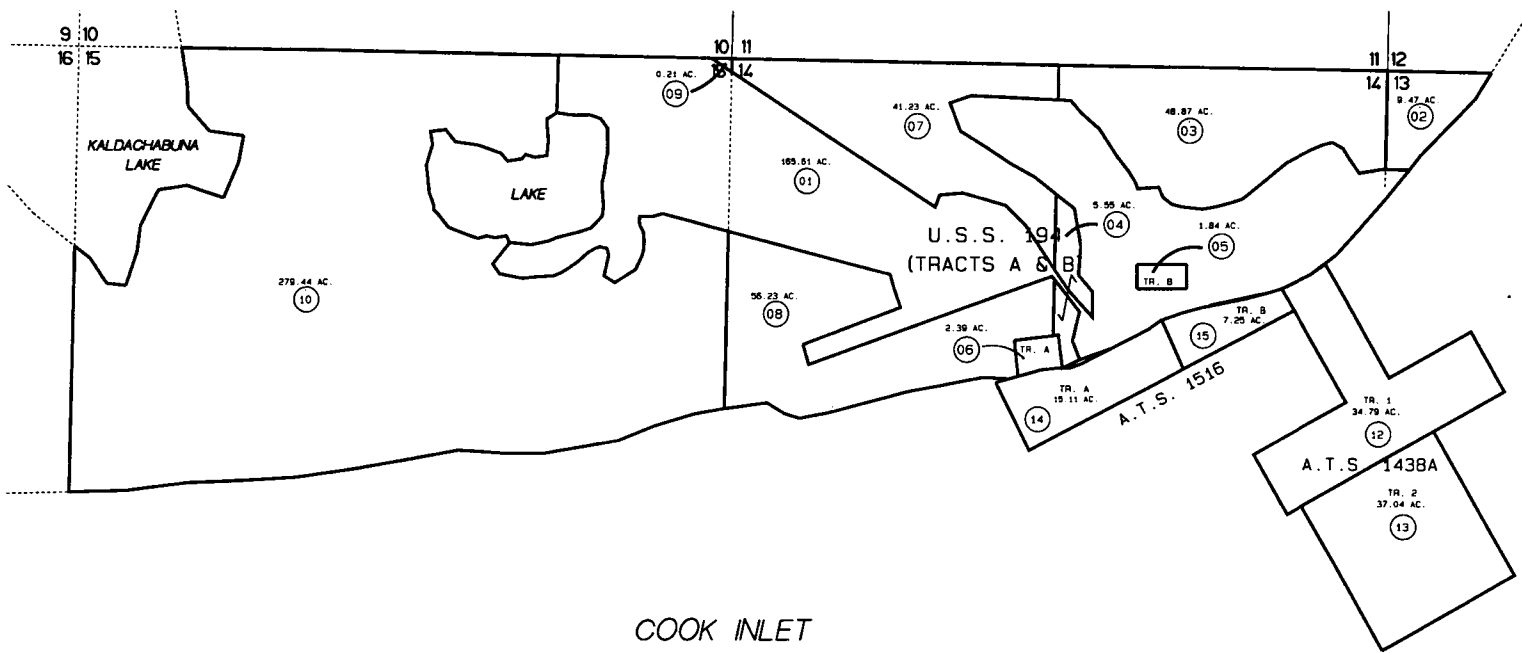

COOK INLET



DATE: JULY 13, 1999

FOR 2000 ASSESSMENT ROLL

DELETE	ADD	REVISED

TO  
14,15

U.S.S. 0194	ANU00194
U.S.S. 1885	ANU01885
A.T.S. 1438	AN940012
A.T.S. 1438A	AN950043
A.T.S. 1516	AN990022

Assessor's Map  
Kenai Peninsula Borough

THIS MAP IS PREPARED  
FOR KENAI PENINSULA  
BOROUGH ASSESSING DEPT.  
USE ONLY AND IS NOT  
INTENDED FOR CONVEYANCE.  
NOR IS IT A SURVEY

NOTE - Assessor's Block Numbers Shown In Ellipses  
Assessor's Parcel Numbers Shown In Circles