

BK
035

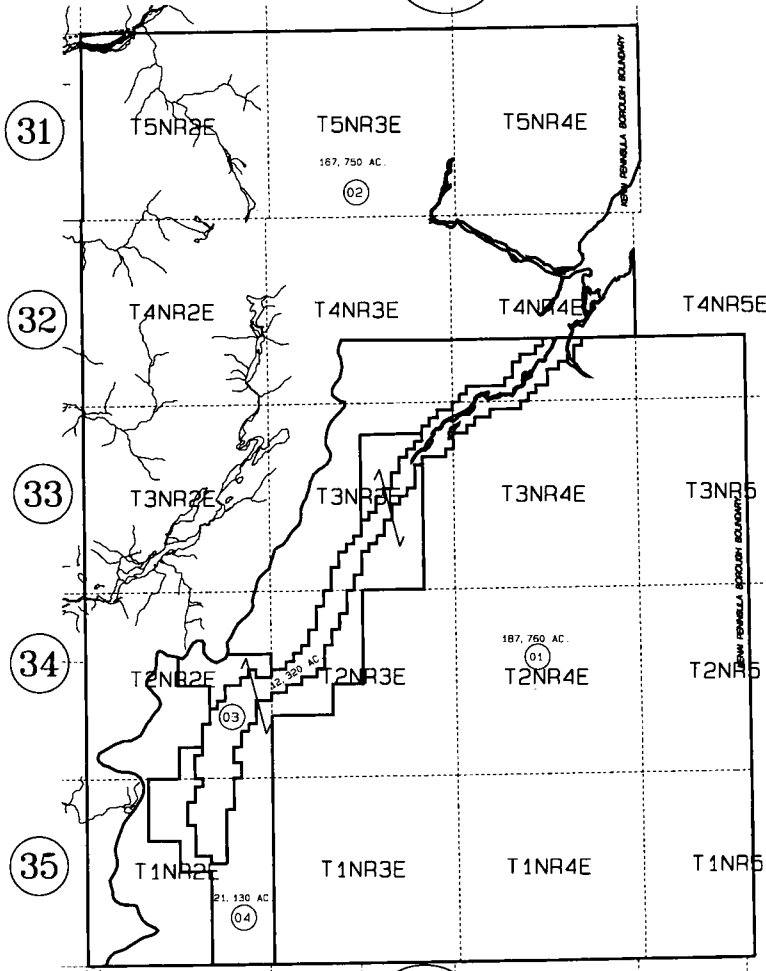

DATE: JUNE 14, 1999
 FOR 2000 ASSESSMENT ROLL
 DELETE ADD REVISED
 TO
 NEW
 PAGE

Assessor's Map
 Kenai Peninsula Borough

BK
189

THIS MAP IS PREPARED
 FOR KENAI PENINSULA
 BOROUGH ASSESSING DEPT.
 USE ONLY AND IS NOT
 INTENDED FOR ANY
 OTHER USE OR REPRESENTATION

NOTE - Assessor's Block Numbers Shown In Ellipses
 Assessor's Parcel Numbers Shown In Circles