

For 2010 assessment roll		
Delete	Add	Revise
To		
01		

SEPTEMBER 3, 2010

Assessor's Map
Kenai Peninsula Borough

This map is prepared for Kenai Peninsula Borough Assessing Dept. use only and is not intended for conveyance nor is it a survey.
Note- Assessor's block Numbers Shown in Ellipses
Assessor's Parcel Numbers Shown in Circles

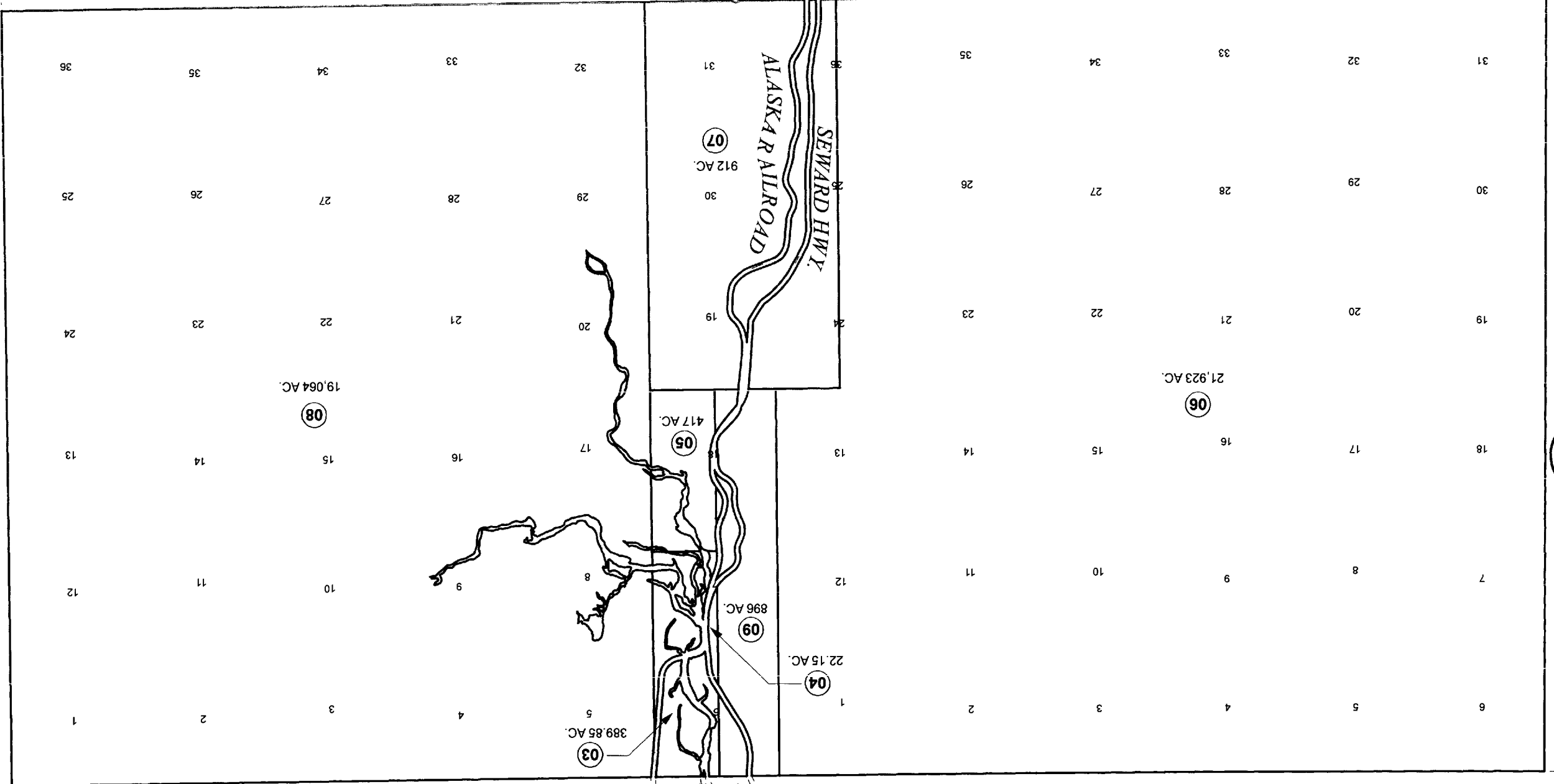

BK 1919

330

350

T02N, R01W AND T02N, R01E S.M.

125-340

420