

POR. SW1/4 SEC. 21, T06S, R13W, S.M.

179-180

AUGUST 16, 2010

For 2011 assessment roll

Delete	Add	Revise
	To	
181-14 to	13	
181-30		(ADDED CONDOMINIUM REFERENCES)

BAY VIEW SUB HM0000839
 THE LANDINGS SUB NO 2 HM0800066
 THE LANDINGS SUB CONDOMINIUMS HM0800088
 BAY VIEW SUB HM0830003
 BAY VIEW SUB NO 5 HM0930027
 BAY VIEW SUB NO 12 HM2002078
 BAY VIEW LAMENDOLA-SITENGA REPLAT HM2005105
 BAY VIEW SUB ADAIR REPLAT HM2006049
 BAY VIEW SUB TULIN ADDN HM2007055



BELUGA LAKE

THE LANDINGS

NO. 5

'THE LANDINGS' DETAIL

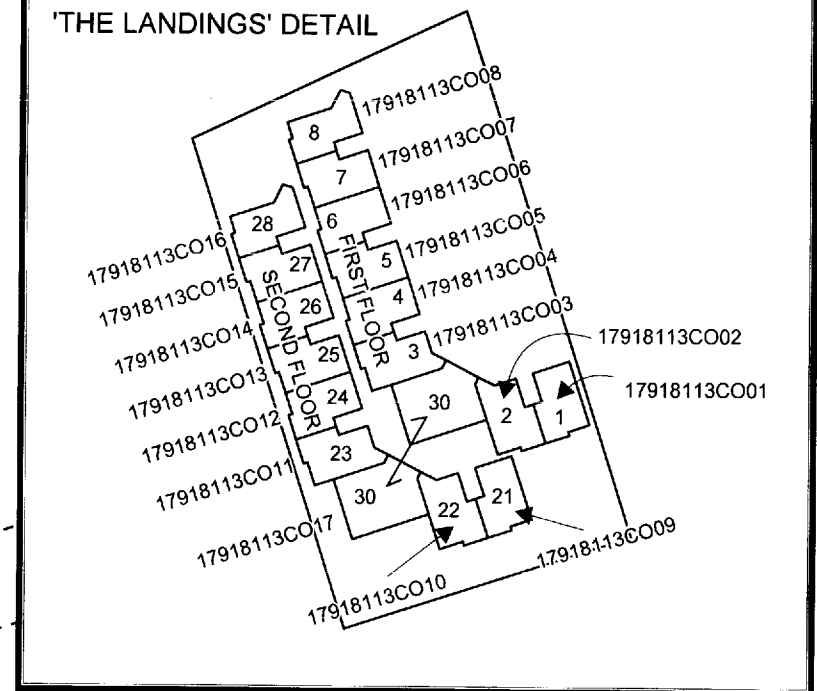

BAYVIEW SUBDIVISION

LAMENDOLA-SITENGA REPLAT

NO. 12

ADAIR REPLAT

OCEAN DR

Assessor's Map
 Kenai Peninsula Borough

This map is prepared for Kenai Peninsula Borough Assessing Dept. use only and is not intended for conveyance nor is it a survey.
 Note- Assessor's block Numbers Shown in Elipses
 Assessor's Parcel Numbers Shown in Circles

