

POR. SEC. 31, T05N, R10W, S.M.

060-150

W. RIVERVIEW AVE.

W. RIVERVIEW AVE.

PORCUPINE CT.

KOBUK CT.

Kenai River

SMALL CIR.

KOBUK ST.

CONDOMINIUM DETAIL  
PARCELS 060-150-20 AND -21

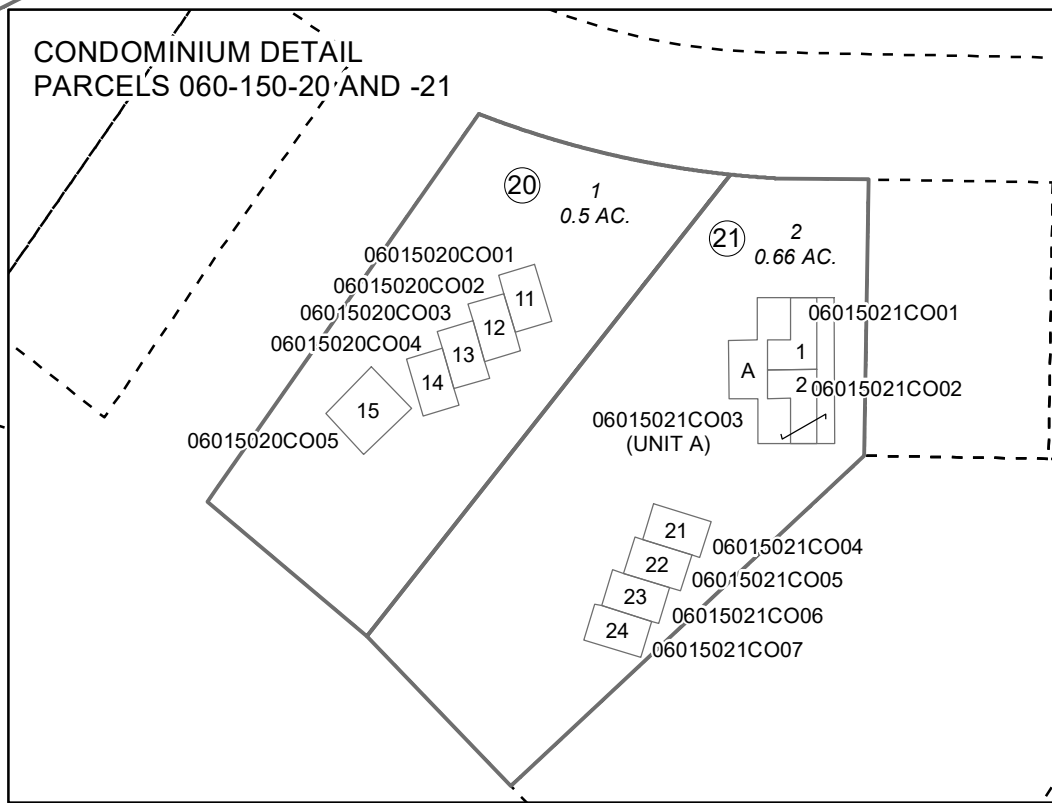

- RIVER VIEW SUB AMENDED KN0001433
- RIVER VIEW SUB AMENDED 1970 ADDN NO 2 KN0001752
- RIVERVIEW SUB RESUB LOT M KN0790035
- SMITH ACRES SUB KN0790053
- SHOLIN SUB A REPLAT OF RIVER VIEW SUB KN0790185
- RIVERVIEW DELUXE SUB KN0810040
- RIVERVIEW SUB & SMALL CIRCLE STREET KN0830034
- SMITH ACRES SUB NO 2 AMENDED KN0830231
- RIVER VIEW SUB NO 3 KN0840220
- RIVER VIEW SUB AMENDED SCOULER ADDN KN0850113
- RIVER VIEW SUB AMENDED CARVER ADDN KN0850182
- RIVERVIEW DELUXE SUB HUNTER ADDN KN0860105
- RIVER VIEW SUB SCOULER REPLAT #2 KN2002112
- RIVERVIEW SUB SCOULER REPLAT #3 KN2009065
- KENAI RIVER PRIVATE RESIDENCE CONDOMINIUMS KN2013053
- RIVERVIEW SUB COGHILL REPLAT KN2017057
- RIVERVIEW SUB FRALEY REPLAT KN2017075
- RIVERVIEW SUB FRALEY 2019 REPLAT KN2019035
- RIVERVIEW DELUXE SUB 2022 REPLAT KN2022025

011

470

440

030

140

420

012



0 25 50 100 Feet

JULY 15, 2022

For 2023 assessment roll		
Delete	Add	Revise
To		
54,55	66	

Assessor's Map  
Kenai Peninsula Borough

This map is prepared for Kenai Peninsula Borough Assessing Dept. use only and is not intended for conveyance nor is it a survey.

Note- Assessor's block Numbers Shown in Ellipses  
Assessor's Parcel Numbers Shown in Circles