

ALASKA STATE LAND SURVEY 70-061 SW900017
 ALASKA STATE LAND SURVEY 70-173 SW920003
 ALASKA STATE LAND SURVEY 80-068 SW930031
 ALASKA STATE LAND SURVEY 85-130 SW970007
 ALASKA STATE LAND SURVEY 86-175 SW980015
 ALASKA STATE LAND SURVEY 90-269 SW930009
 ALASKA STATE LAND SURVEY 91-091 SW950009

POR. SEC. 1 & 2, T2S, R2E, SEWARD MERIDIAN

189-330

DAY
HARBOR

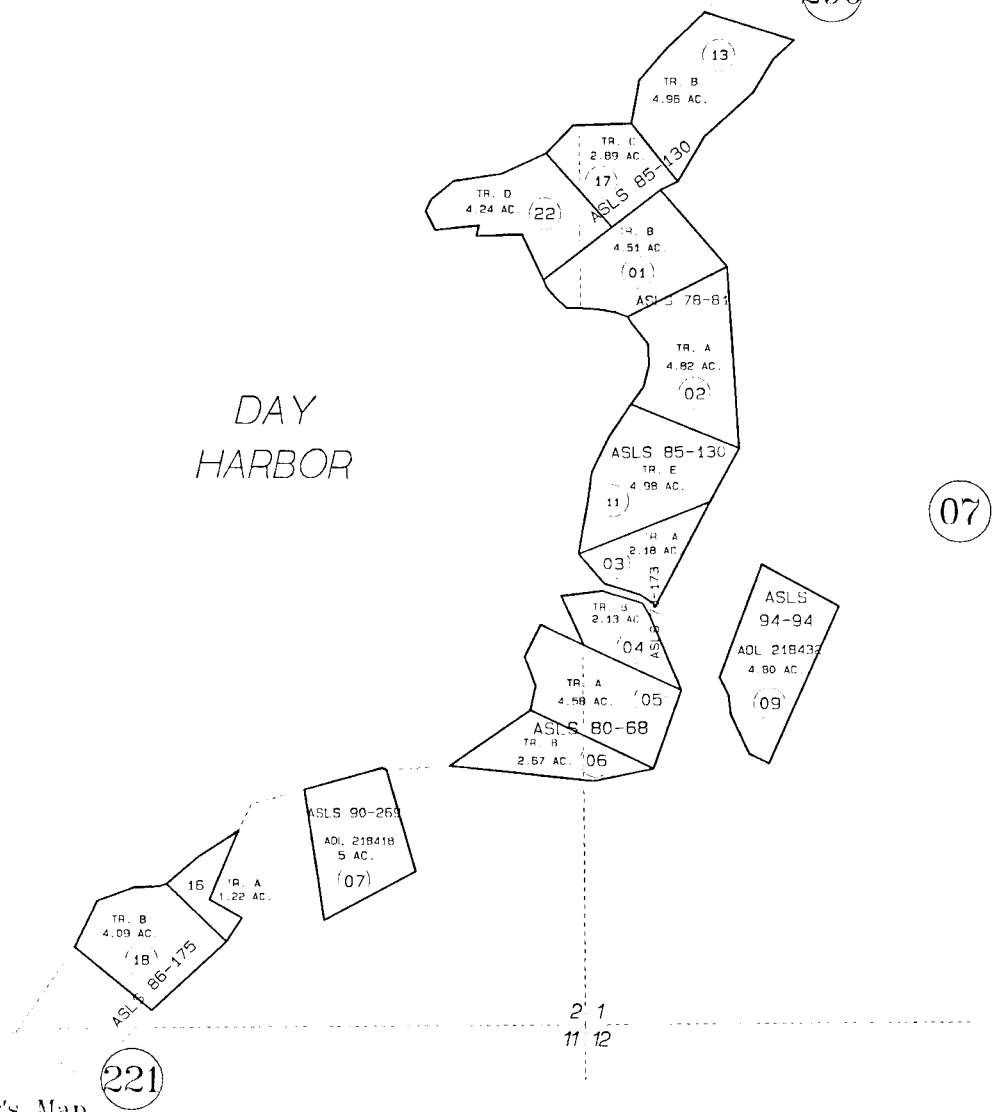

DATE: DEC. 19, 1995
 FOR 1996 ASSESSMENT ROLL
 DUE TO ADJ. REVISED
 10 TO
 09 Assessor's Map
 Kenai Peninsula Borough

THIS MAP IS PREPARED FOR KENAI PENINSULA BOROUGH ASSESSING DEPT. USE ONLY AND IS NOT INTENDED FOR ANY OTHER USE OR REPRESENTATION.
 NOTE - Assessor's Block Numbers Shown In Ellipses
 Assessor's Parcel Numbers Shown In Circles