

9

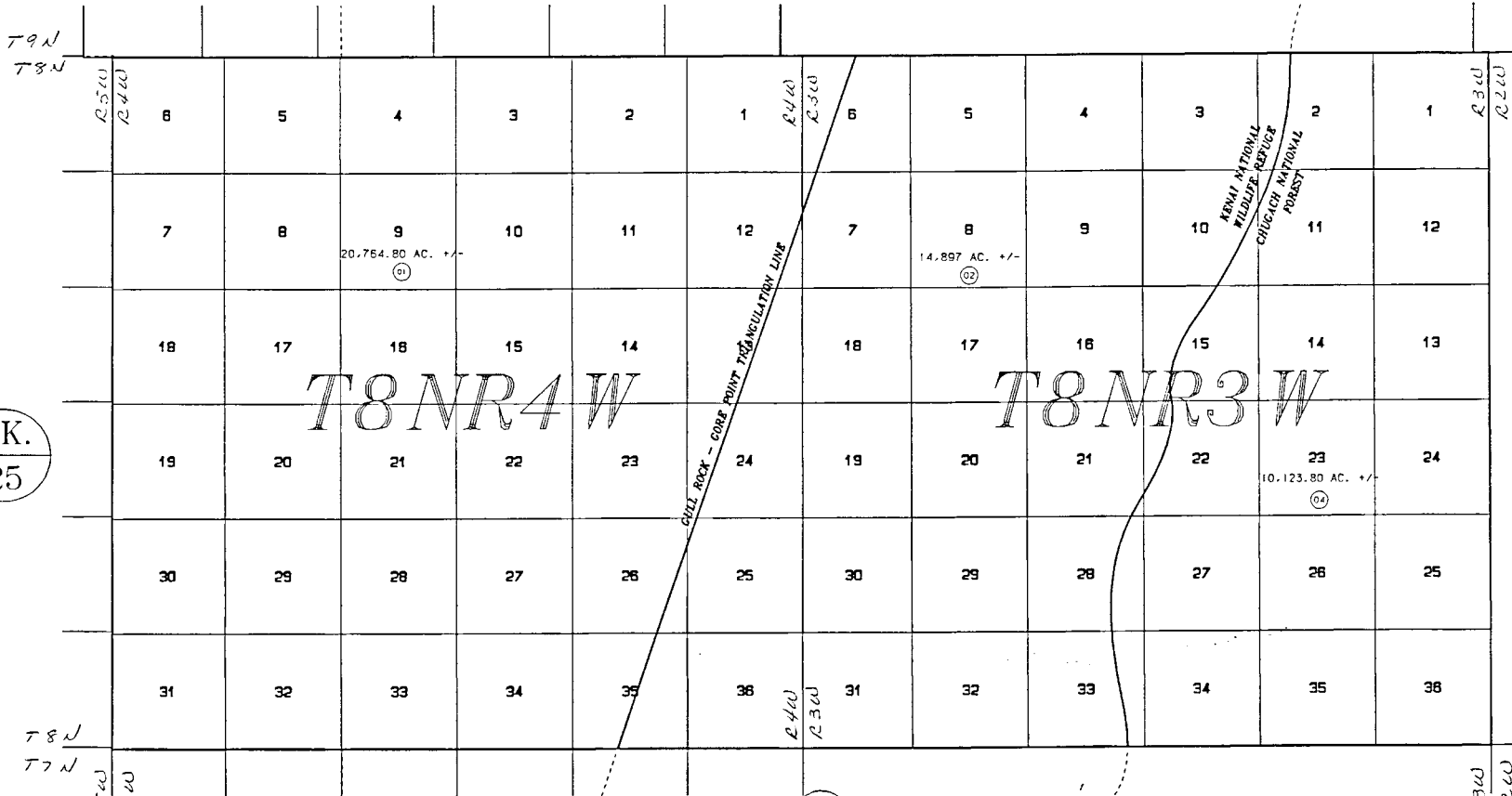

BK.  
25

2

17



DATE: JUNE 7, 1993

FOR 19 94 ASSESSMENT ROLL	
DELETE 03 ADD	REVISED
TO 04	
	1,2

NOTE - Assessor's Block Numbers Shown In Ellipses  
 Assessor's Parcel Numbers Shown In Circles

Assessor's Map  
 Kenai Peninsula Borough

THIS MAP IS PREPARED  
 FOR KENAI PENINSULA  
 BOROUGH ASSESSING DEPT.  
 USE ONLY AND IS NOT  
 INTENDED FOR ANY  
 OTHER USE OR REPRESENTATION