

CHINITNA BAY

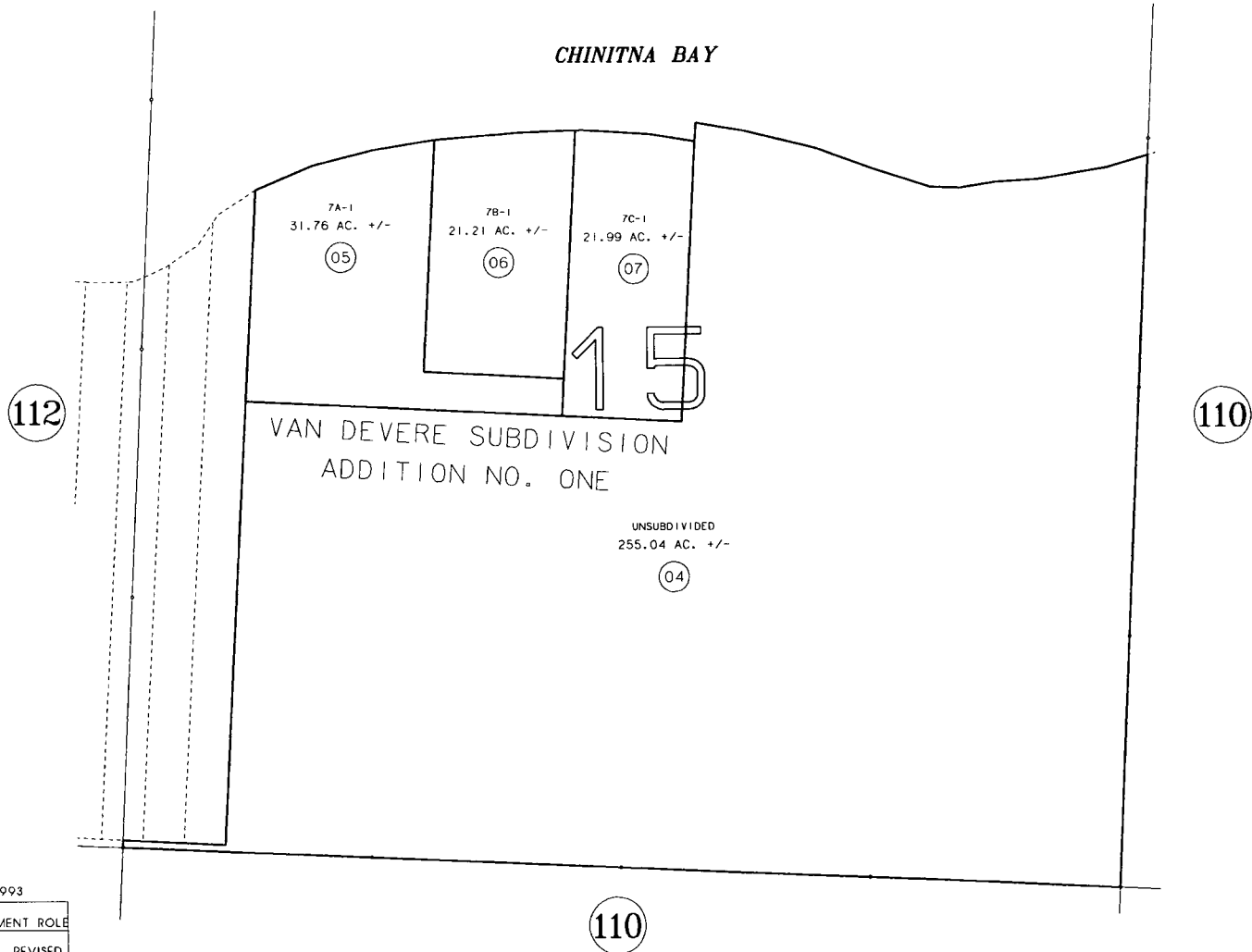

112

110

110

VAN DEVERE SUBDIVISION  
ADDITION NO. ONE

UNSUBDIVIDED  
255.04 AC. +/-  
04

NOTE - Assessor's Block Numbers Shown In Ellipses  
Assessor's Parcel Numbers Shown In Circles

Assessor's Map  
Kenai Peninsula Borough



DATE: JUNE 15, 1993

FOR 19 94 ASSESSMENT ROLE		
DELETE	ADD	REVISED
1,2,3	TO	5,6,7

THIS MAP IS PREPARED  
FOR KENAI PENINSULA  
BOROUGH ASSESSING DEPT.  
USE ONLY AND IS NOT  
INTENDED FOR ANY  
OTHER USE OR REPRESENTATION