

POR. SEC. 21, T11S, R15W, S.M.

191-061

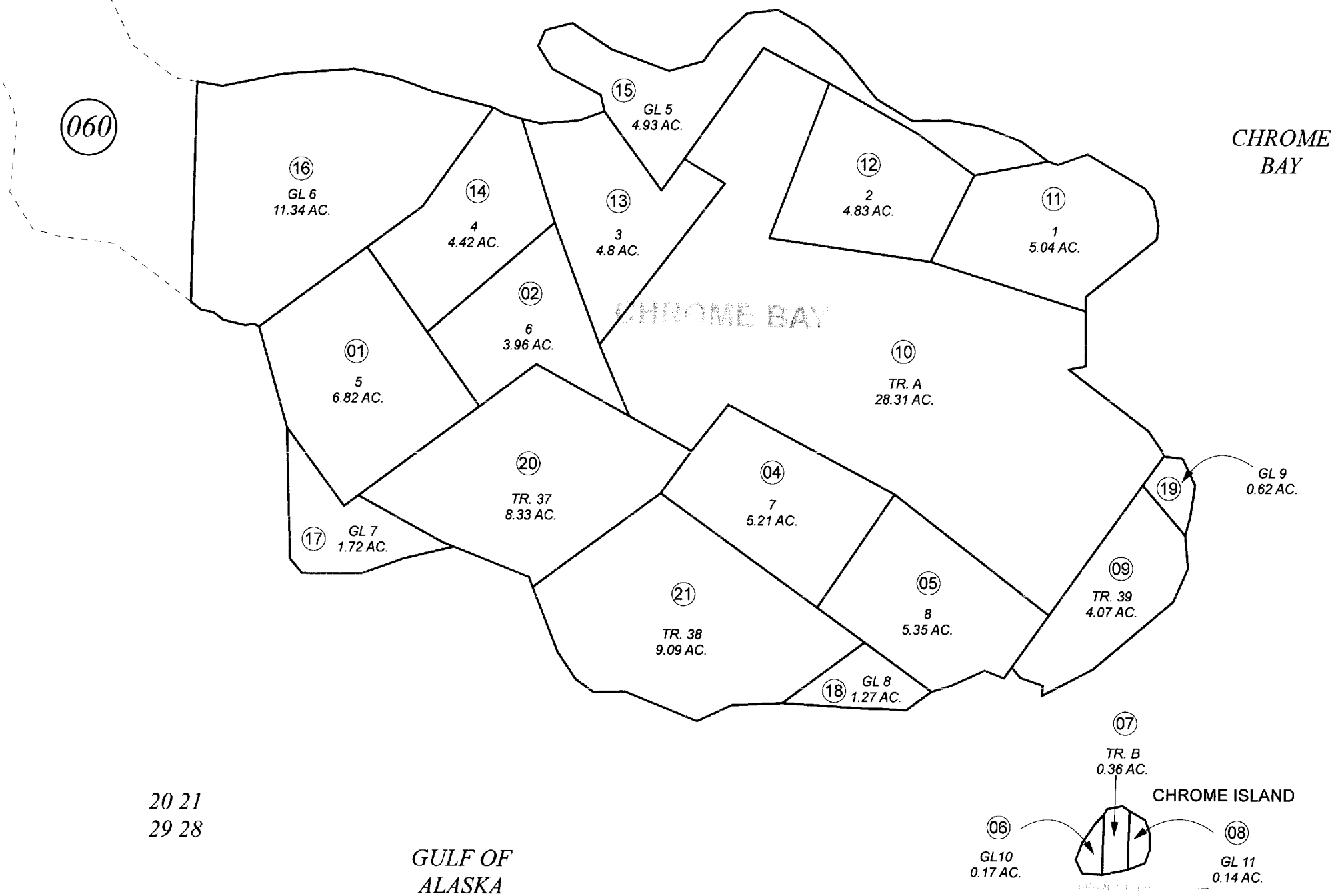

20 21
29 28

GULF OF ALASKA

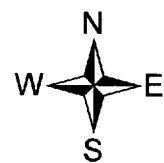

JULY 9, 2010

For 2011 assessment roll		
Delete	Add	Revise
To		
3	15-21	

Assessor's Map
Kenai Peninsula Borough

CHROME BAY SUB SL0880005

This map is prepared for Kenai Peninsula Borough Assessing Dept. use only and is not intended for conveyance nor is it a survey.

Note- Assessor's block Numbers Shown in Ellipses
Assessor's Parcel Numbers Shown in Circles