

T3S, R5W & R6W, SEWARD MERIDIAN

185-140

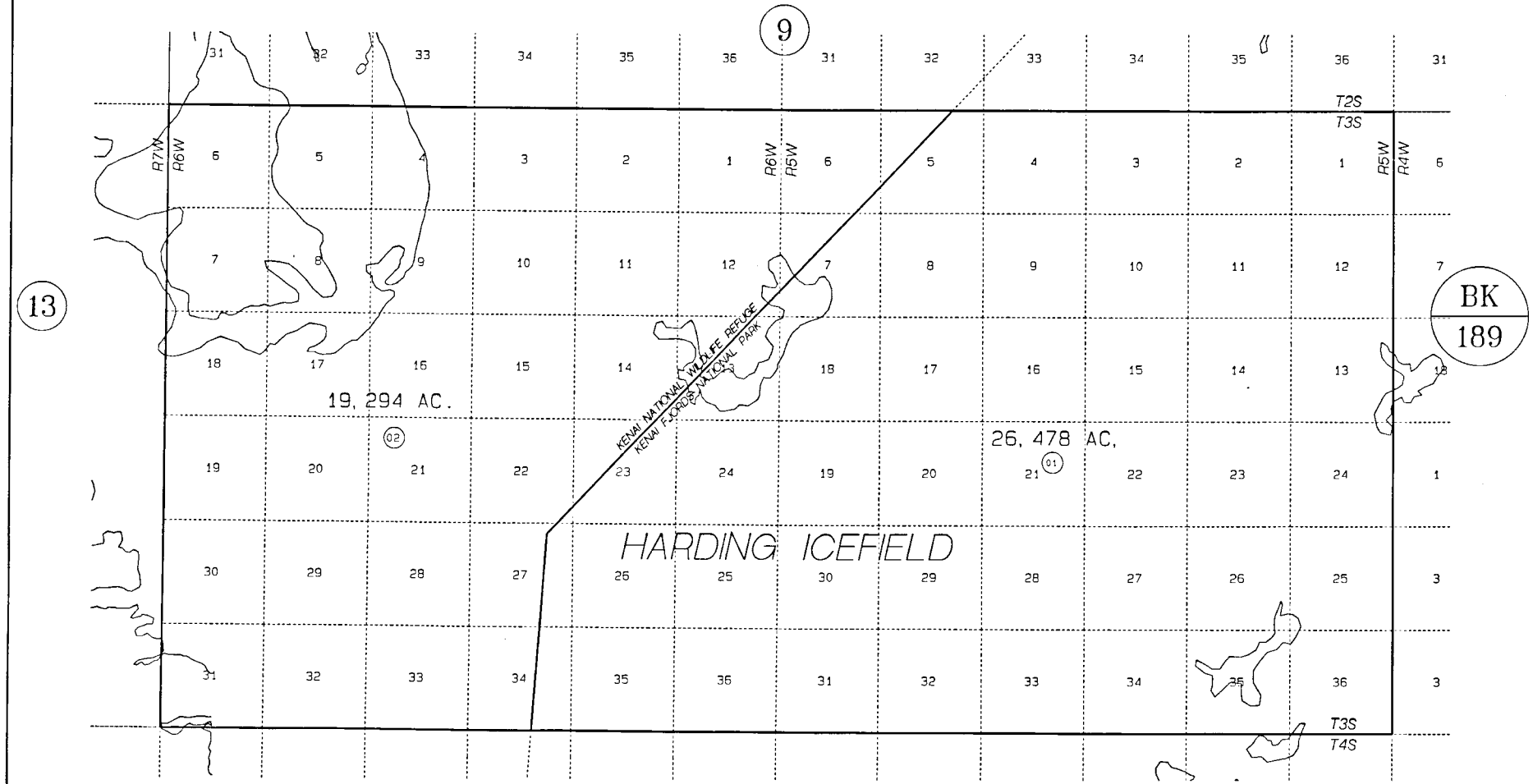

DATE: JUNE 30, 1998

FOR 19 99 ASSESSMENT ROLL

DELETE	ADD	REVISED

TO 2

1

Assessor's Map
Kenai Peninsula Borough

18

THIS MAP IS PREPARED FOR KENAI PENINSULA BOROUGH ASSESSING DEPT USE ONLY AND IS NOT INTENDED FOR ANY OTHER USE OR REPRESENTATION
NOTE - Assessor's Block Numbers Shown In Ellipses
Assessor's Parcel Numbers Shown In Circles