

T7N, R21W - R23W, SEWARD MERIDIAN

221-320

31

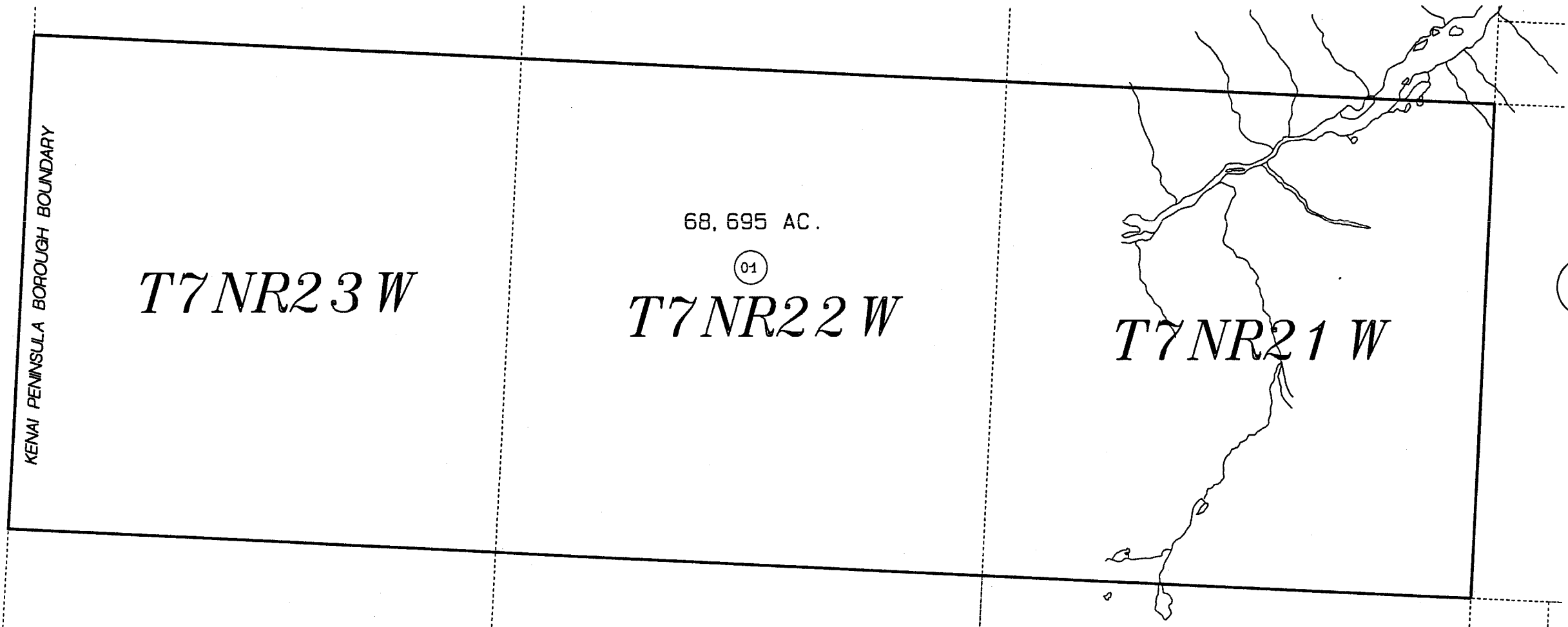

DATE: MAY 5, 1999  
 FOR 19\_00 ASSESSMENT ROLL  
 DELETE    ADD    REVISED  
 TO  
 NEW  
 PAGE

Assessor's Map  
 Kenai Peninsula Borough

32

THIS MAP IS PREPARED  
 FOR KENAI PENINSULA  
 BOROUGH ASSESSING DEPT.  
 USE ONLY AND IS NOT  
 INTENDED FOR ANY  
 OTHER USE OR REPRESENTATION

NOTE - Assessor's Block Numbers Shown In Ellipses  
 Assessor's Parcel Numbers Shown In Circles