

T7N, R1W, R2W, SEWARD MERIDIAN

035-180

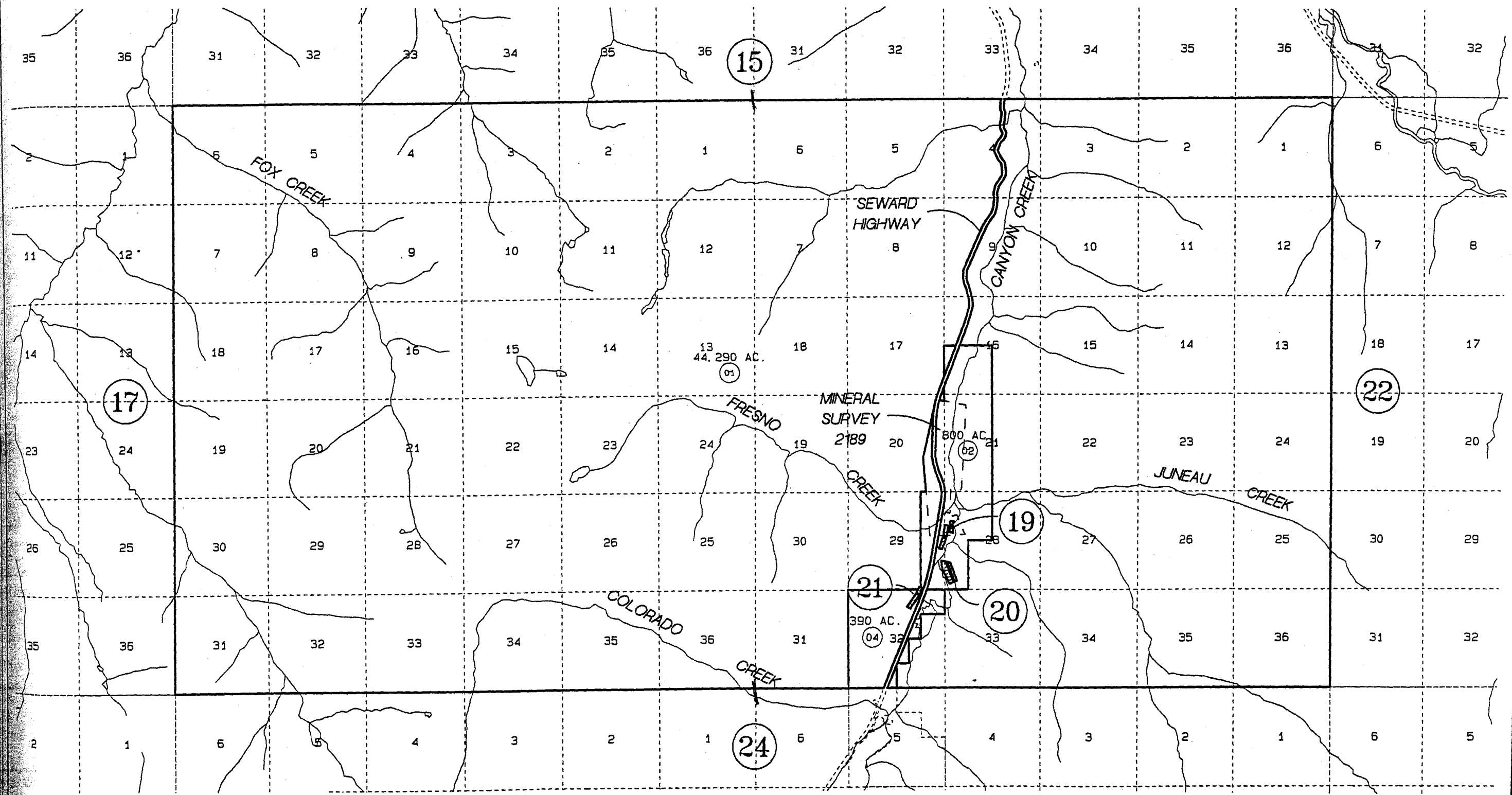

DATE:

FOR 19 97 ASSESSMENT ROLL		
DELETE	ADD	REVISED
OCT. 21, 1996		1,2
FEB. 21, 1997		4 1

Assessor's Map  
Kenai Peninsula Borough

THIS MAP IS PREPARED  
FOR KENAI PENINSULA  
BOROUGH ASSESSING DEPT.  
USE ONLY AND IS NOT  
INTENDED FOR ANY  
OTHER USE OR REPRESENTATION

NOTE - Assessor's Block Numbers Shown In Ellipses  
Assessor's Parcel Numbers