

S1/2 SE1/4 SEC. 34, T01S, R14W, S.M.

157-180

170

ASPEN AVE.

KINGSLEY RD.

MARION ST.

CECELIA ST.

240

100

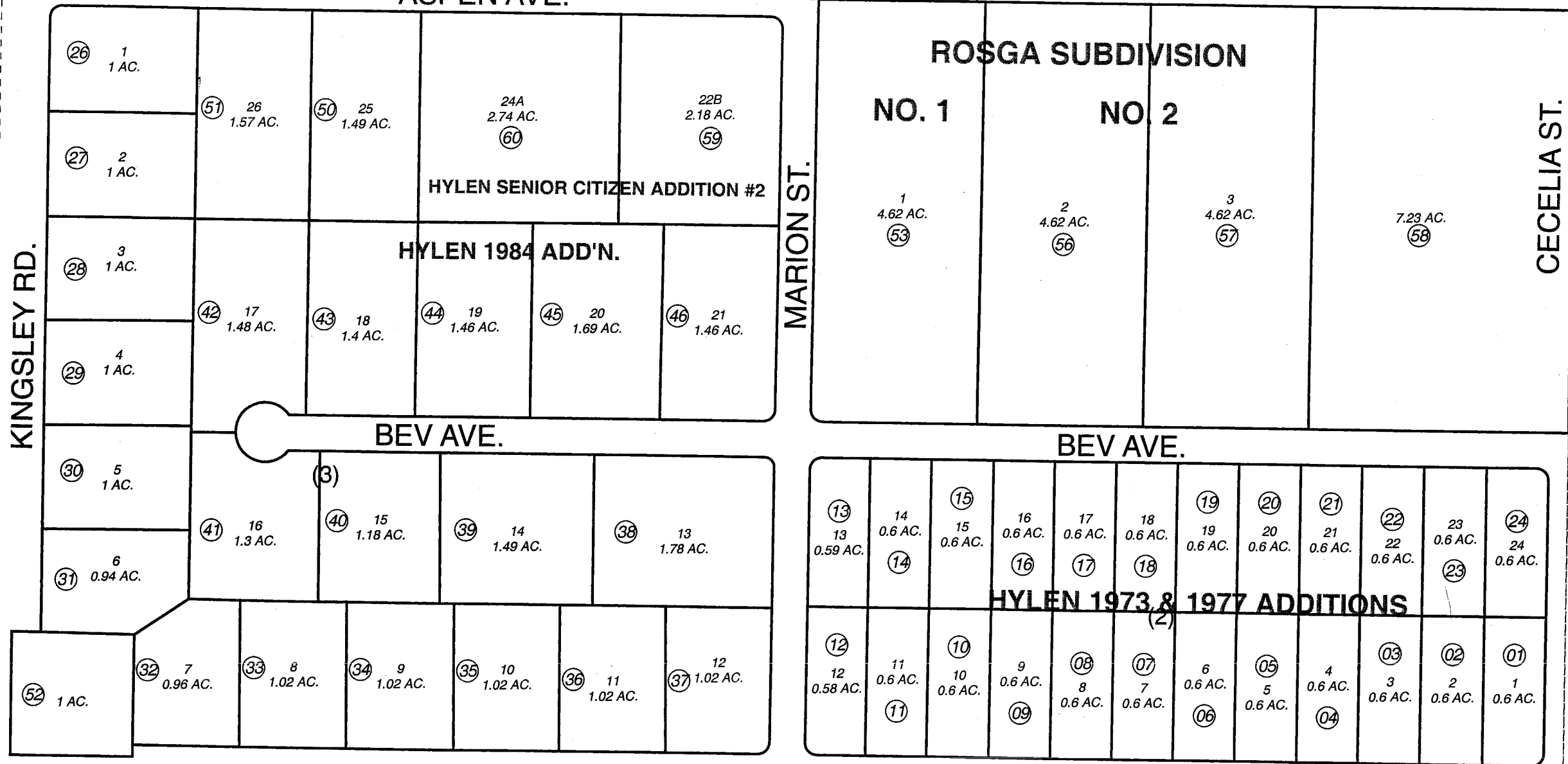

NOVEMBER 9, 2006

For 2007 assessment roll

Delete	Add	Revise
To		
49,55	59,60	

BK
159



Assessor's Map
Kenai Peninsula Borough

HYLEN SUB 1973 ADDN □ HM0730607
 HYLEN 1977 ADDN RESUB LOTS 1 & 12 □ HM0780024
 HYLEN SUB 1984 ADDN AMENDED □ HM0840050
 HYLEN 1984 ADDN AMENDED □ HM0840073
 HYLEN SUB 1984 ADDN AMENDED □ HM0840073
 ROSGA SUB NO 1 □ HM0920056
 ROSGA SUB NO 2 □ HM2004034
 HYLEN SENIOR CITIZEN ADDN #2 □ HM2006071

This map is prepared for Kenai Peninsula Borough Assessing Dept. use only and is not intended for conveyance nor is it a survey.

Note- Assessor's block Numbers Shown in Ellipses
Assessor's Parcel Numbers Shown in Circles