

POR. SEC. 10, T01S, R01W, S.M.

148-160

130

140

MONROE ST

FIFTH AVE

SIXTH AVE

180

TIX REPLAT

MADISON ST

150

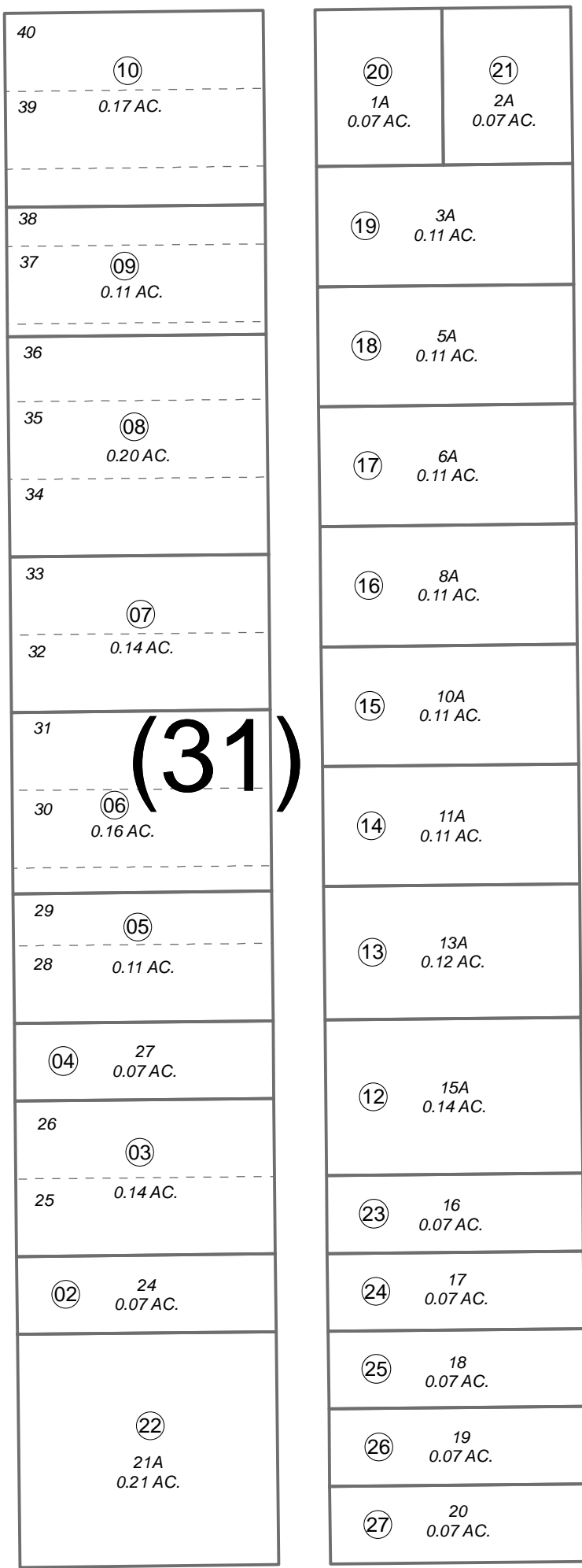

0 25 50 Feet

AUGUST 28, 2013

For 2014 assessment roll	
Delete	Add
	Revise
To	
11	23-27

This map is prepared for Kenai Peninsula Borough Assessing Dept. use only and is not intended for conveyance nor is it a survey.

Note- Assessor's block Numbers Shown in Ellipses Assessor's Parcel Numbers Shown in Circles

SW00000027

SW0990006

ORIGINAL TOWNSITE OF SEWARD SW00000001

ORIGINAL TOWNSITE OF SEWARD REPLAT OF BLOCKS 31 & 32

ORIGINAL TOWNSITE OF SEWARD TIX REPLAT SW0990006

Assessor's Map Kenai Peninsula Borough