

PORTION OF SW1/4 SW1/4 SEC. 16, T6S, R13W, SEWARD MERIDIAN

179-064

- 1 SPACE 01
- 2 SPACE 02
- 3 SPACE 03
- 4 SPACE 04
- 5 SPACE 05
- 6 SPACE 06
- 7 SPACE 07
- 8 SPACE 08
- 9 SPACE 09

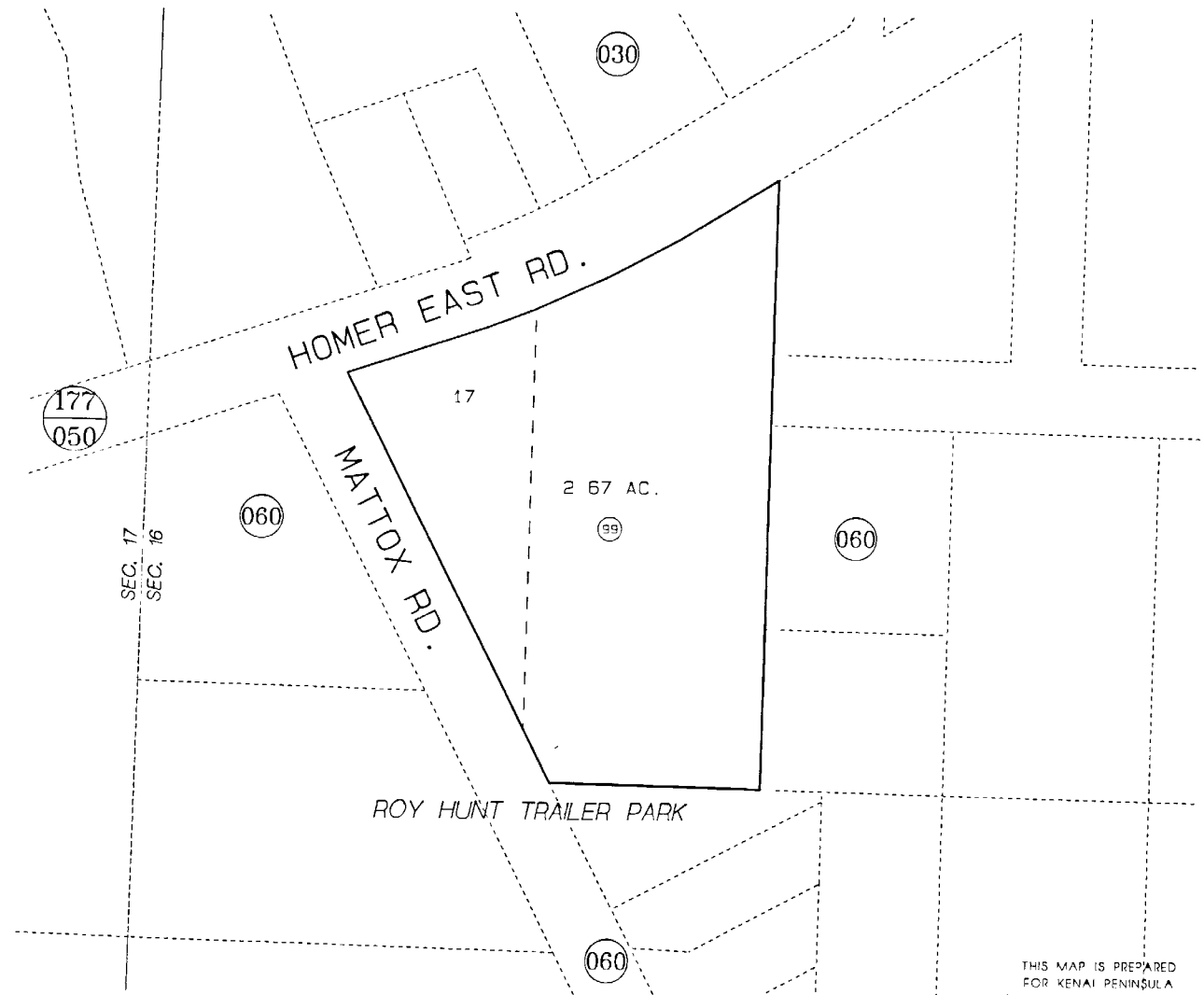

DATE OCT. 31, 1996		
FOR 1997 ASSESSMENT ROLL		
DELETE	ADD	REVISED
TO		
NEW PAGE		

Assessor's Map
Kenai Peninsula Borough

MATTOX SUB LOT 17 HM003017

THIS MAP IS PREPARED FOR KENAI PENINSULA BOROUGH ASSESSING DEPT. USE ONLY AND IS NOT INTENDED FOR ANY OTHER USE OR REPRESENTATION

NOTE - Assessor's Block Numbers Shown in Ellipses
Assessor's Parcel Numbers Shown in Circles