

T01S, R03E, R04E, R05E, S.M.

189-040

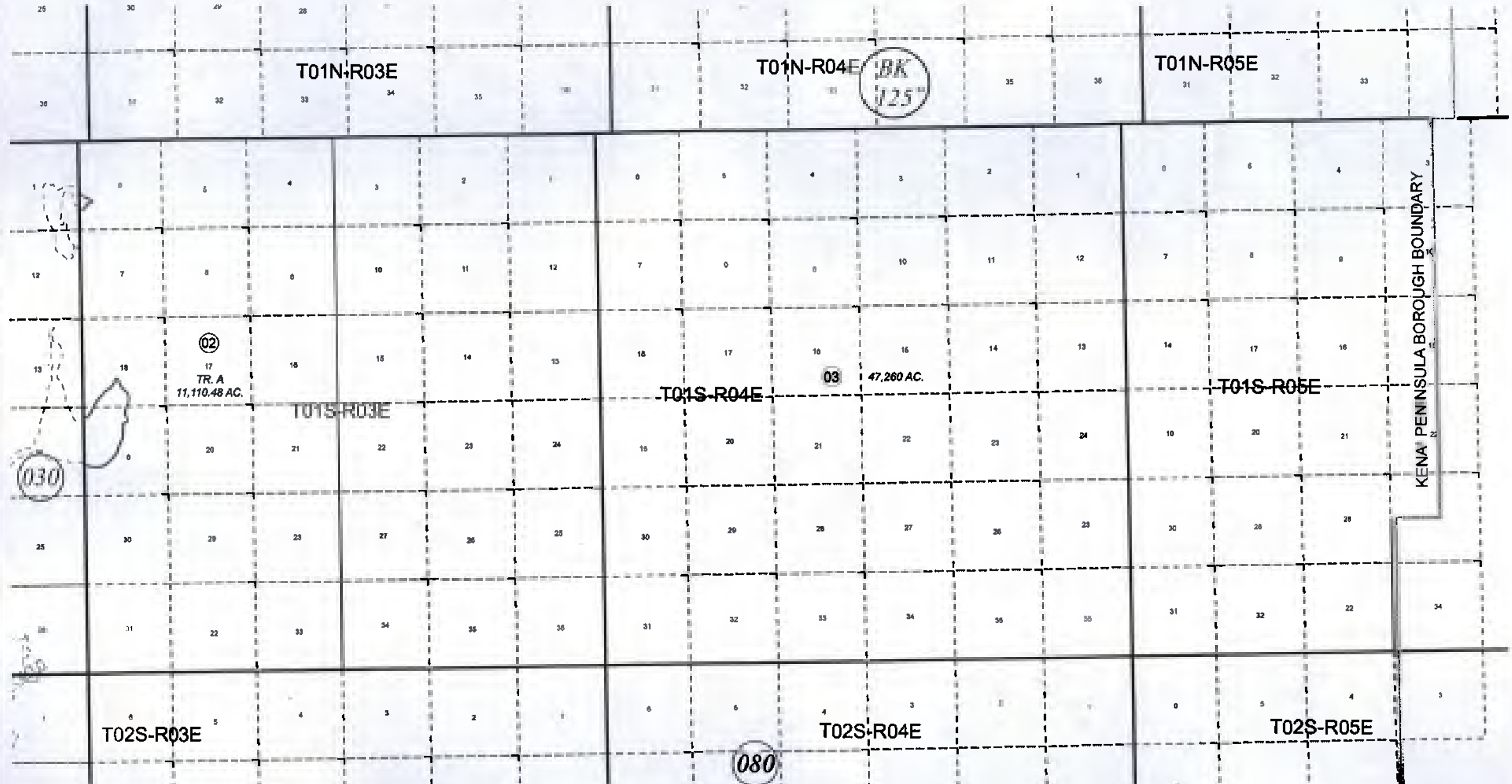

OCTOBER 9, 2012

For 2013 assessment roll		
Delete	Add	Rev se
To		02

Assessor's Map
Kenai Peninsula Borough

This map is prepared for Kenai Peninsula Borough Assessing Dept. use only and is not intended for conveyance nor is it a survey.
Note- Assessor's block Numbers Shown in Ellipses
Assessor's Parcel Numbers Shown in Circles