

12

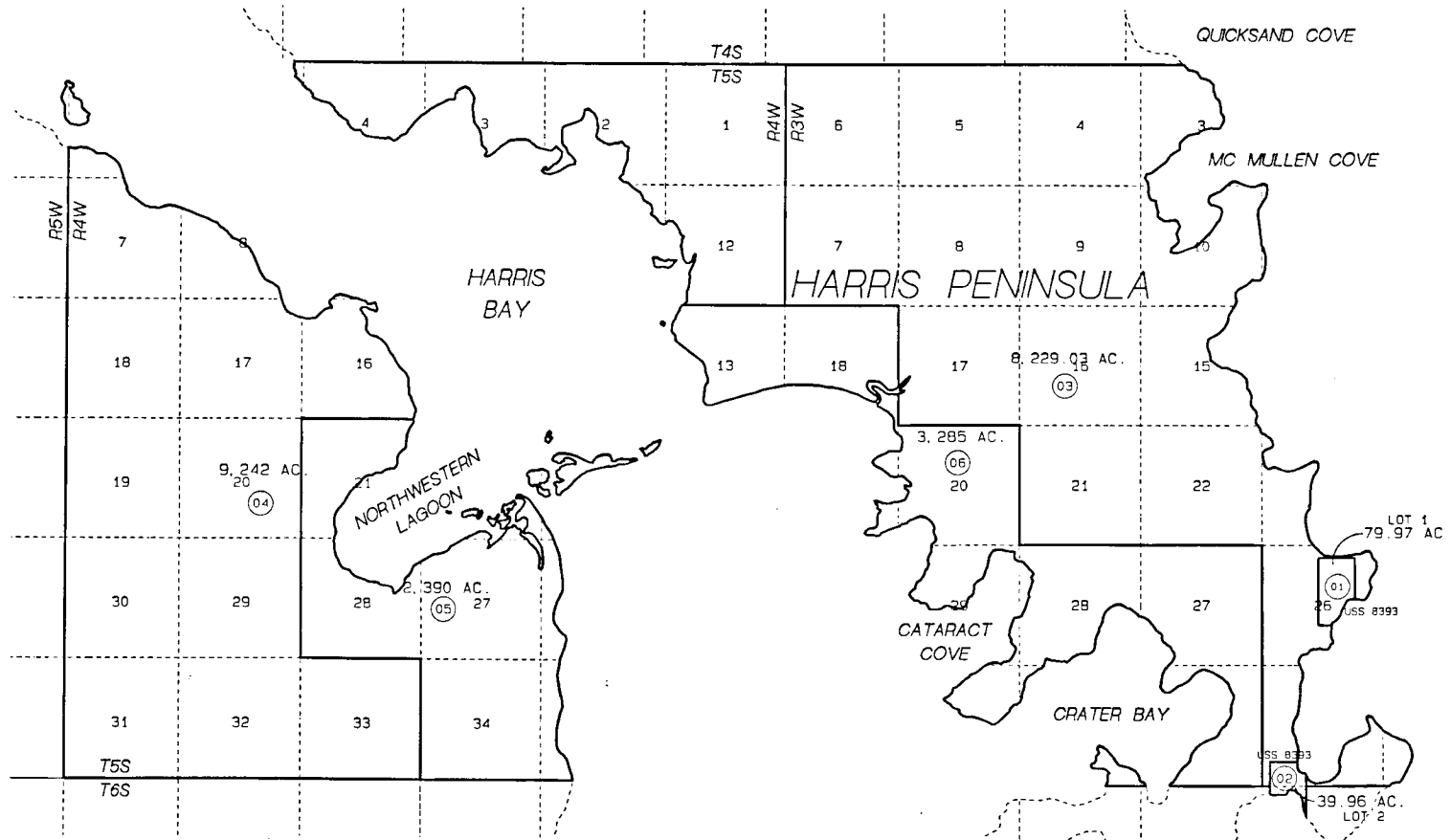

BK
191

15

16

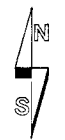

DATE: DEC. 6, 1998

FOR 19 98 ASSESSMENT ROLL		
DELETE	ADD	REVISED
	TO	
	6	
		3.4
(ACREAGE CHANGE)		

Assessor's Map
Kenai Peninsula Borough

U.S.S. 8393 SWL08393

THIS MAP IS PREPARED FOR KENAI PENINSULA BOROUGH ASSESSING DEPT. USE ONLY AND IS NOT INTENDED FOR ANY OTHER USE OR REPRESENTATION

NOTE - Assessor's Block Numbers Shown In Ellipses
Assessor's Parcel Numbers Shown In Circles