

POR. SEC. 32, T08S, R14W, S.M.

192-070

SELDOVIA BAY

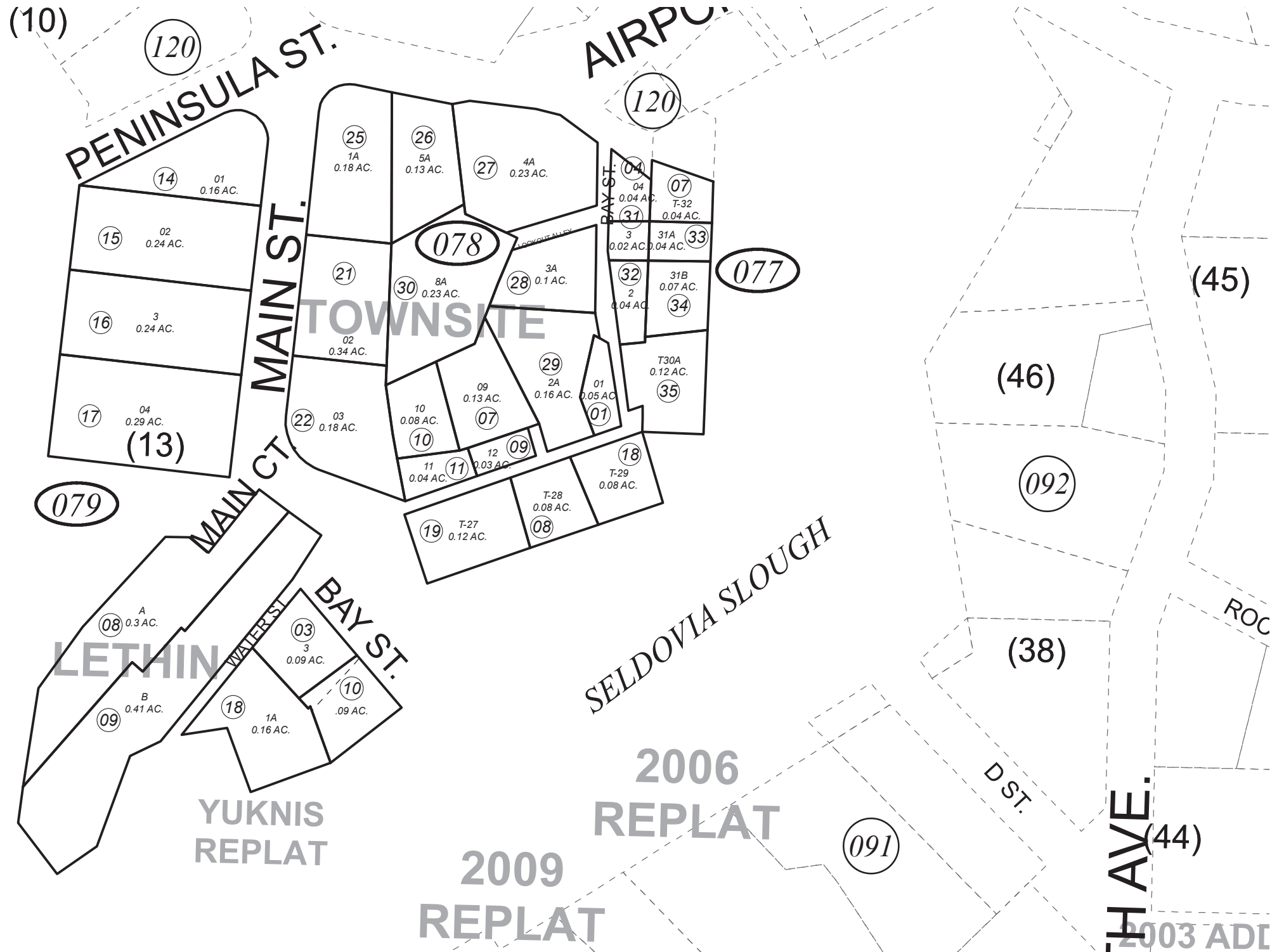

OCTOBER 25, 2017

For 2018 assessment roll		
Delete	Add	Revise
To		
07701		
07705	07735	

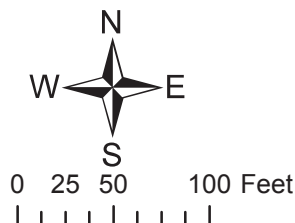

Assessor's Map  
Kenai Peninsula Borough

TOWNSITE OF SELDOVIA USS 1771 SL0001771  
 ALASKA TIDELANDS SURVEY 219 - SELDOVIA SL0640013  
 WATERFRONT RESUB NO 1 SL0670030  
 LETHIN SUB SL0800008  
 SELDOVIA TOWNSITE US SURVEY 1771 SL0920008  
 SELDOVIA TOWNSITE YUKNIS REPLAT SL2008002  
 STRANIK SUB SL2017007

This map is prepared for Kenai Peninsula Borough Assessing Dept. use only and is not intended for conveyance nor is it a survey.  
 Note- Assessor's block Numbers Shown in Ellipses  
 Assessor's Parcel Numbers Shown in Circles