

ALASKA STATE LAND SURVEY 85-032 11.860001
ALASKA STATE LAND SURVEY 86-190 11.880002

SEC. 34, T4N, R18W, 186 SEWARD MERIDIAN

221-187

28' 27"
33' 34"

27' 26"
34' 35"

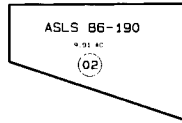
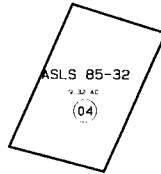

170

180

180

REDOUBT CREEK



DATE: NOV. 1, 1995

FOR 1996 ASSESSMENT ROLL

DELETE ADD REVISED

TO

13.5

33' 34"
4' 3"

Assessor's Map
Kenai Peninsula Borough

220

NOTE

34' 35"

Assessor's Block Numbers Shown in Ellipses
Assessor's Parcel Numbers Shown in Circles

THIS MAP IS PREPARED
FOR KENAI PENINSULA
BOROUGH ASSESSING DEPT
USE ONLY AND IS NOT
INTENDED FOR ANY
OTHER USE OR REPRESENTATION