

T2S, R25W, SEWARD MERIDIAN

231-210

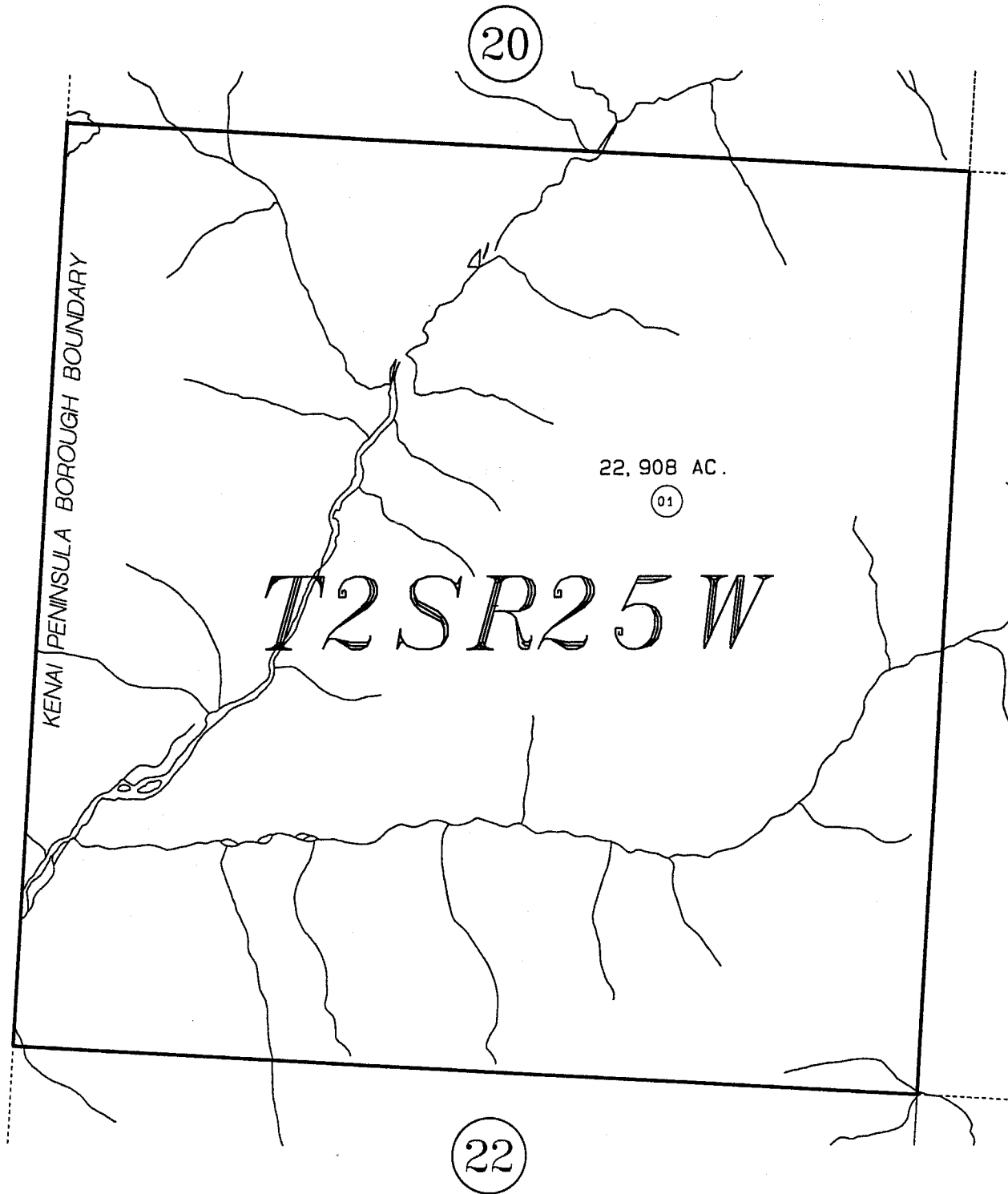

DATE: MAY 5, 1999

FOR 19 00 ASSESSMENT ROLL

DELETE	ADD	REVISED
--------	-----	---------

TO

NEW PAGE

Assessor's Map
Kenai Peninsula Borough

THIS MAP IS PREPARED
FOR KENAI PENINSULA
BOROUGH ASSESSING DEPT.
USE ONLY AND IS NOT
INTENDED FOR ANY
OTHER USE OR REPRESENTATION

NOTE - Assessor's Block Numbers Shown In Ellipses
Assessor's Parcel Numbers Shown In Circles