

T06S, T07S, R25W, S.M.

231-170

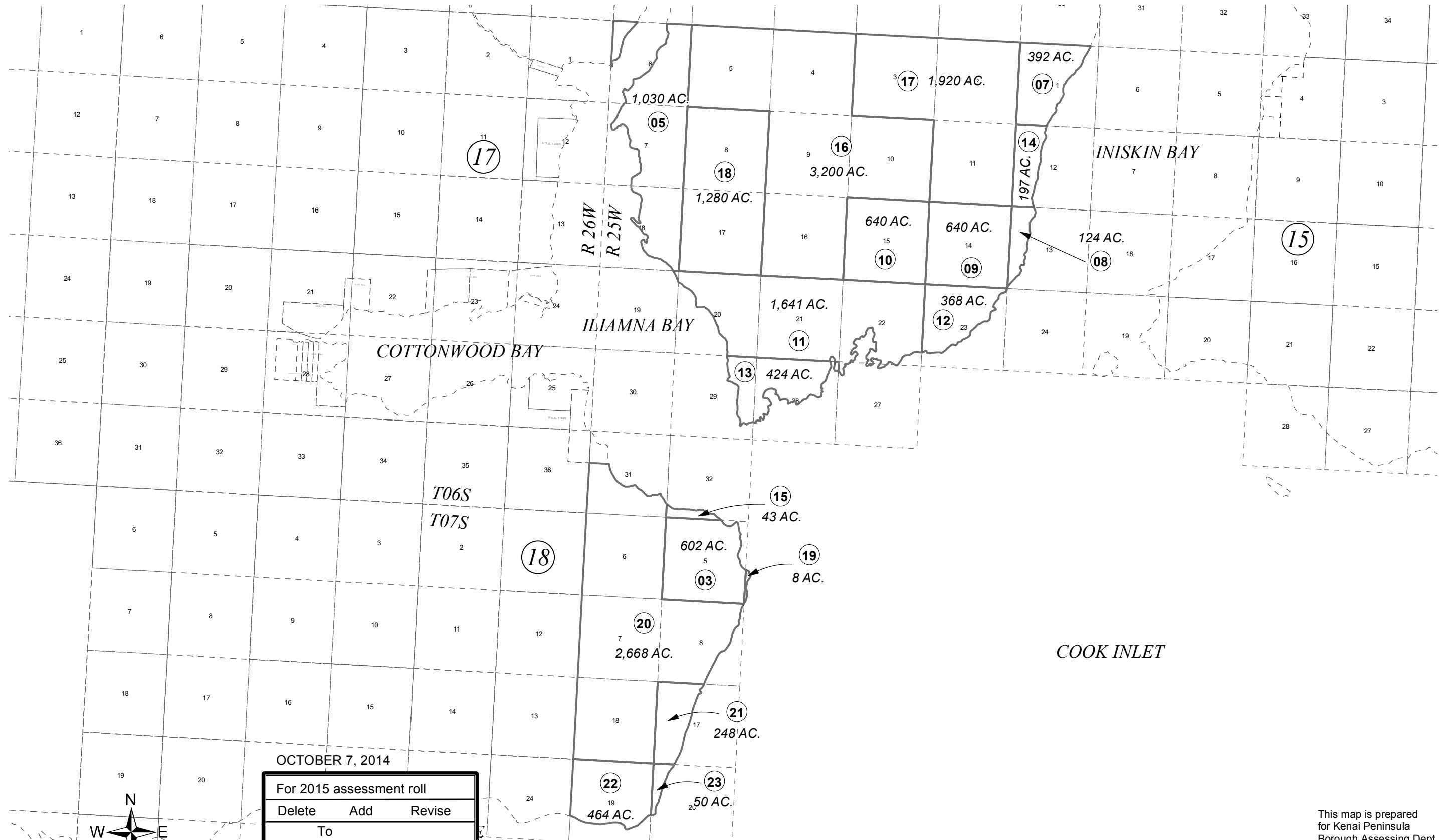

OCTOBER 7, 2014

For 2015 assessment roll		
Delete	Add	Revise
To		
11,13		
(ACREAGE CHANGE)		

Assessor's Map  
Kenai Peninsula Borough

This map is prepared for Kenai Peninsula Borough Assessing Dept. use only and is not intended for conveyance nor is it a survey.

Note- Assessor's block Numbers Shown in Ellipses  
Assessor's Parcel Numbers Shown in Circles