

T1N, R1W & T1N, R1E, SEWARD MERIDIAN

125-350

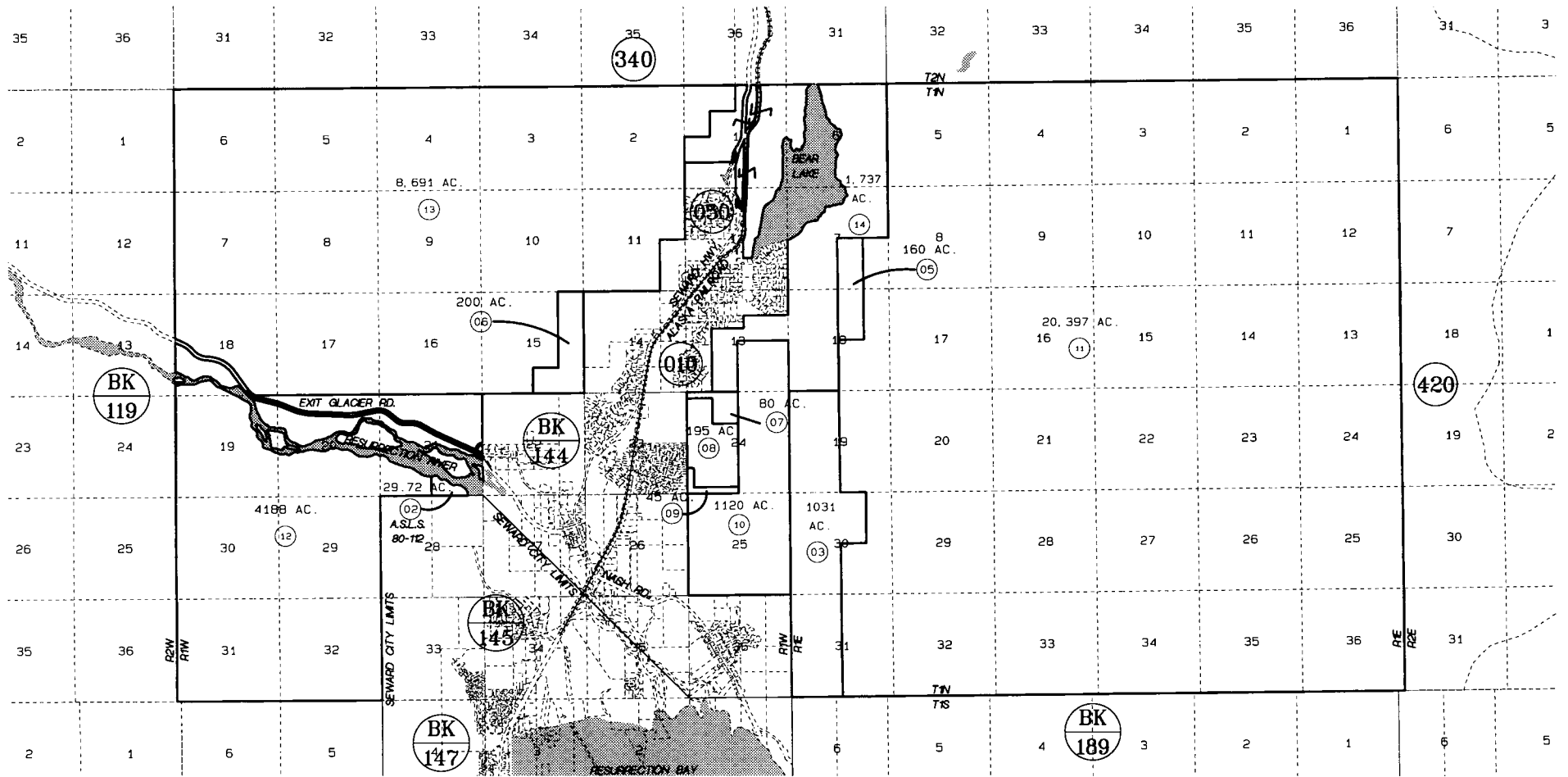

DATE: APRIL 21, 1995

FOR 1995 ASSESSMENT ROLL

DELETE ADD REVISED

10 TO
14
11,13

ALASKA STATE LAND SURVEY 80-112 SW820008

Assessor's Map
Kenai Peninsula Borough

THIS MAP IS PREPARED
FOR KENAI PENINSULA
BOROUGH ASSESSING DEPT.
USE ONLY AND IS NOT
INTENDED FOR ANY
OTHER USE OR REPRESENTATION

NOTE - Assessor's Block Numbers Shown In Ellipses
Assessor's Parcel Numbers Shown In Circles