

PERMITTED CABINS RESIDING ON PARCEL 18506036  
 SEC. 4,5,6, T2S, R11W, SEWARD MERIDIAN

185-061

1

509

510

06

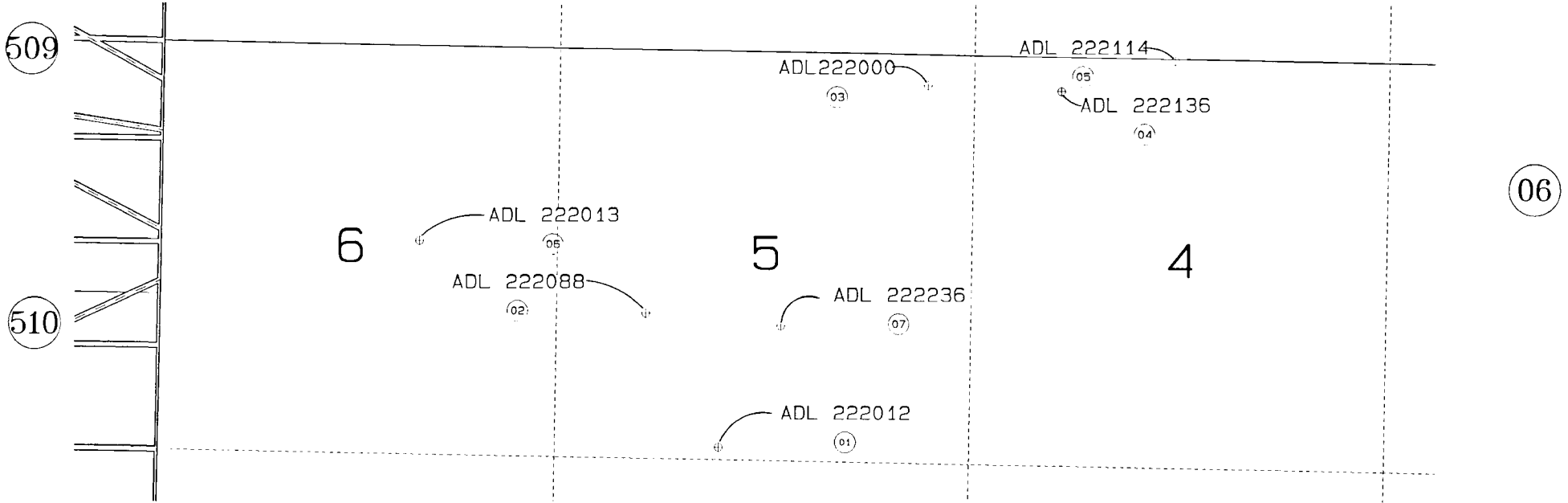

DATE, MARCH 22, 1995

FOR 1995 ASSESSMENT ROLL

DELETE	ADD	REVISED
--------	-----	---------

TO  
 NEW PAGE

Assessor's Map  
 Kenai Peninsula Borough

06

- 18506101 ADL 222012
- 18506102 ADL 222088
- 18506103 ADL 222000
- 18506104 ADL 222136
- 18506105 ADL 222114
- 18506106 ADL 222013
- 18506107 ADL 222236

THIS MAP IS PREPARED  
 FOR KENAI PENINSULA  
 BOROUGH ASSESSING DEPT.  
 USE ONLY AND IS NOT  
 INTENDED FOR ANY  
 OTHER USE OR REPRESENTATION

NOTE - Assessor's Block Numbers Shown In Ellipses  
 Assessor's Parcel Numbers Shown In Circles