

SEC. 34 & W 1/2 SEC. 35, T2S, R4E, SEWARD MERIDIAN

189-017

084

27 | 26
34 | 35

018

014

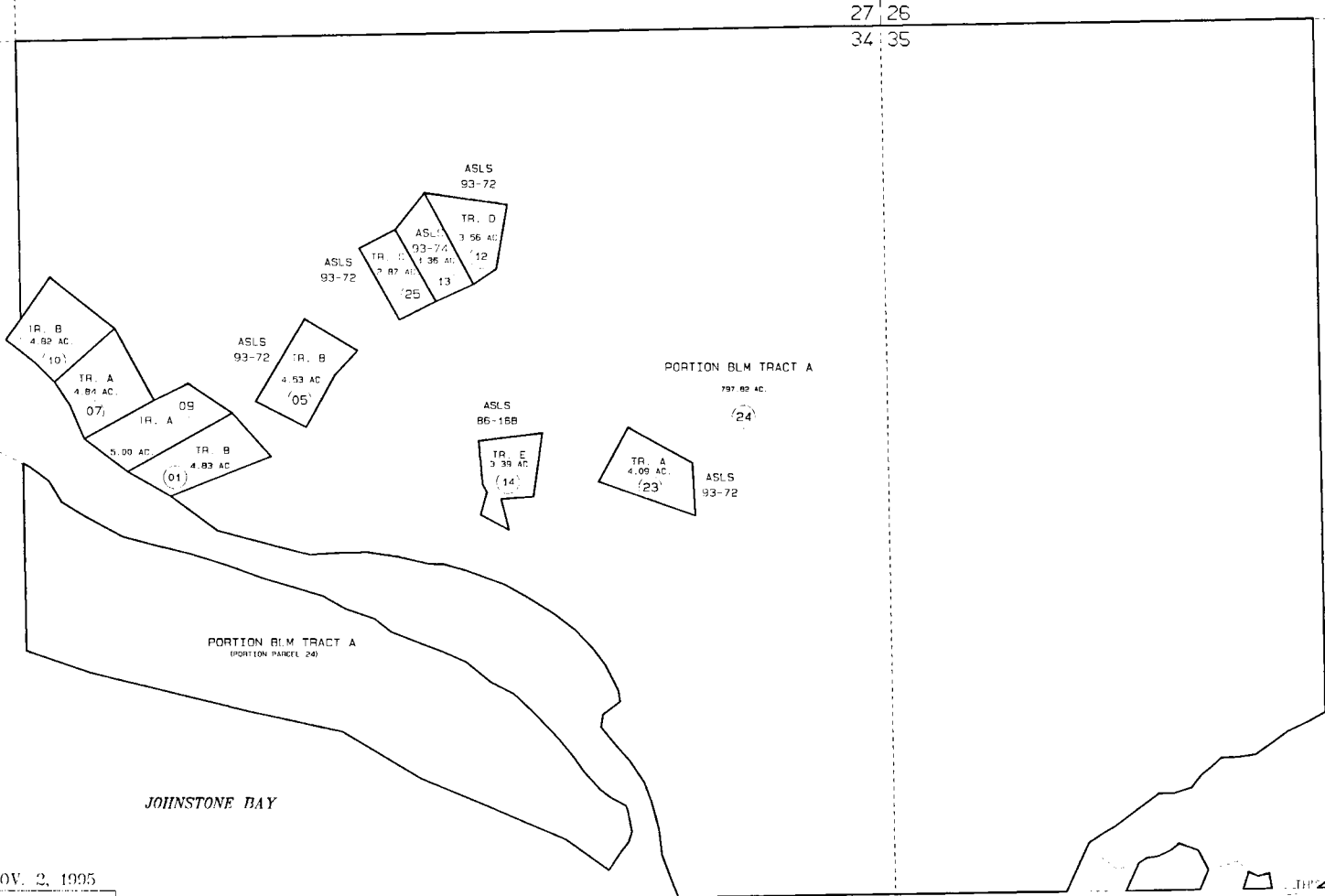

DATE: NOV. 2, 1995
 FOR 1996 ASSESSMENT ROLL
 DATE: ADD: REVISED:
 1.19 00

Assessor's Map
 Kenai Peninsula Borough

ALASKA STATE LAND SURVEY 86-160 SW920025
 ALASKA STATE LAND SURVEY 91-201 SW920010
 ALASKA STATE LAND SURVEY 93-054 SW930022
 ALASKA STATE LAND SURVEY 93-072 SW910021
 ALASKA STATE LAND SURVEY 93-071 SW910030

THIS MAP IS PREPARED FOR KENAI PENINSULA BOROUGH ASSESSING DEPT. USE ONLY AND IS NOT INTENDED FOR ANY OTHER USE OR REPRESENTATION

NOTE - Assessor's Block Numbers Shown In Ellipses
 Assessor's Parcel Numbers Shown In Circles