

T8S, R9W, R10W, S.M.

193-140

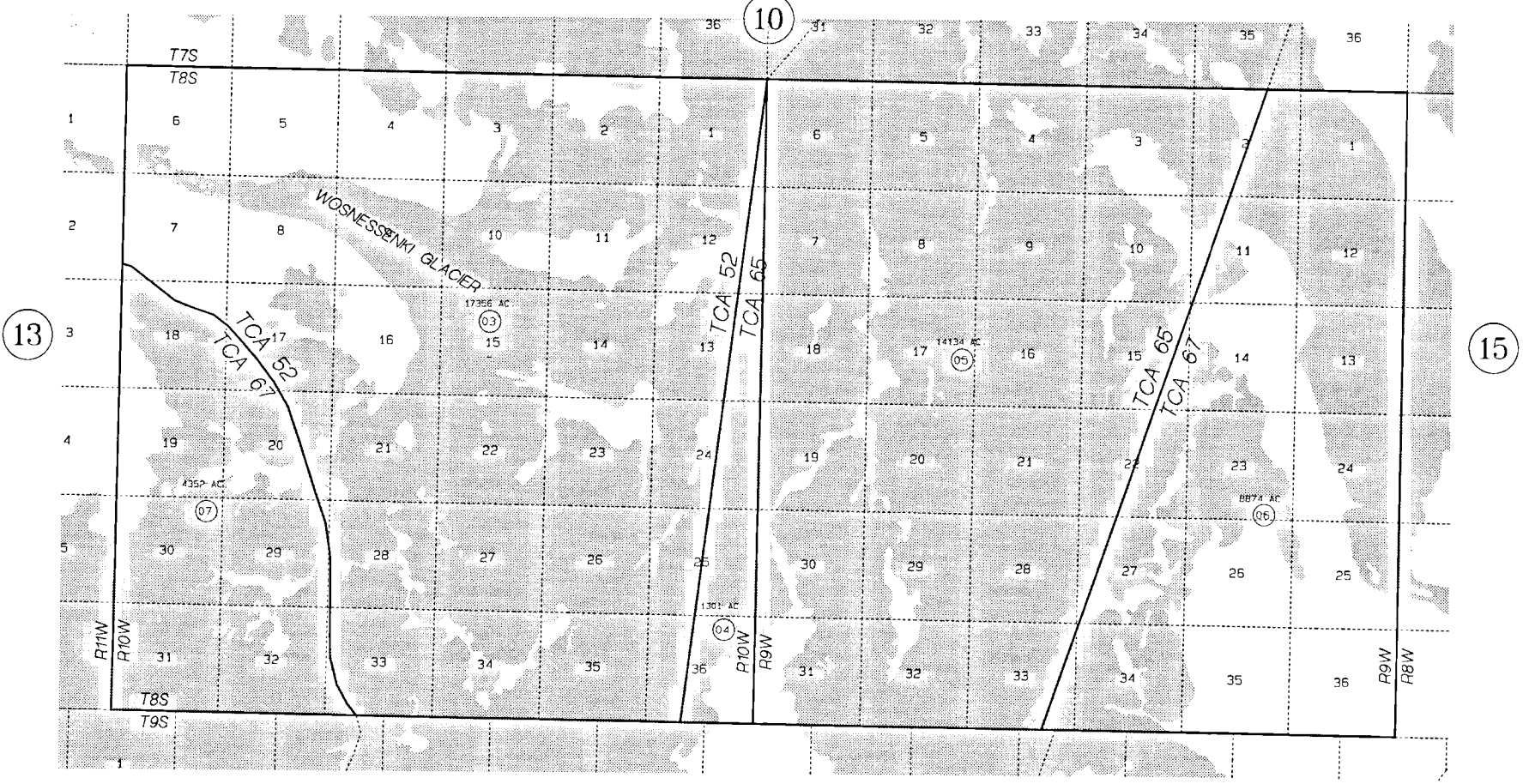

13

10

15

19



DATE: DEC. 29, 1999

FOR 2000 ASSESSMENT ROLL		
DELETE	ADD	REVISED
TO		
	7	

Assessor's Map
Kenai Peninsula Borough

THIS MAP IS PREPARED FOR KENAI PENINSULA BOROUGH ASSESSING DEPT. USE ONLY AND IS NOT INTENDED FOR CONVEYANCE NOR IS IT A SURVEY.
NOTE - Assessor's Block Numbers Shown in Ellipses. Assessor's Parcel Numbers Shown in Circles