

PTN. SEC. 31, T.6N. & SEC. 6,7,8, T.5 N., R.10W &
SEC. 1,2,11,12, T.5 N., R.11W., SM

BOOK 49
INDEX I

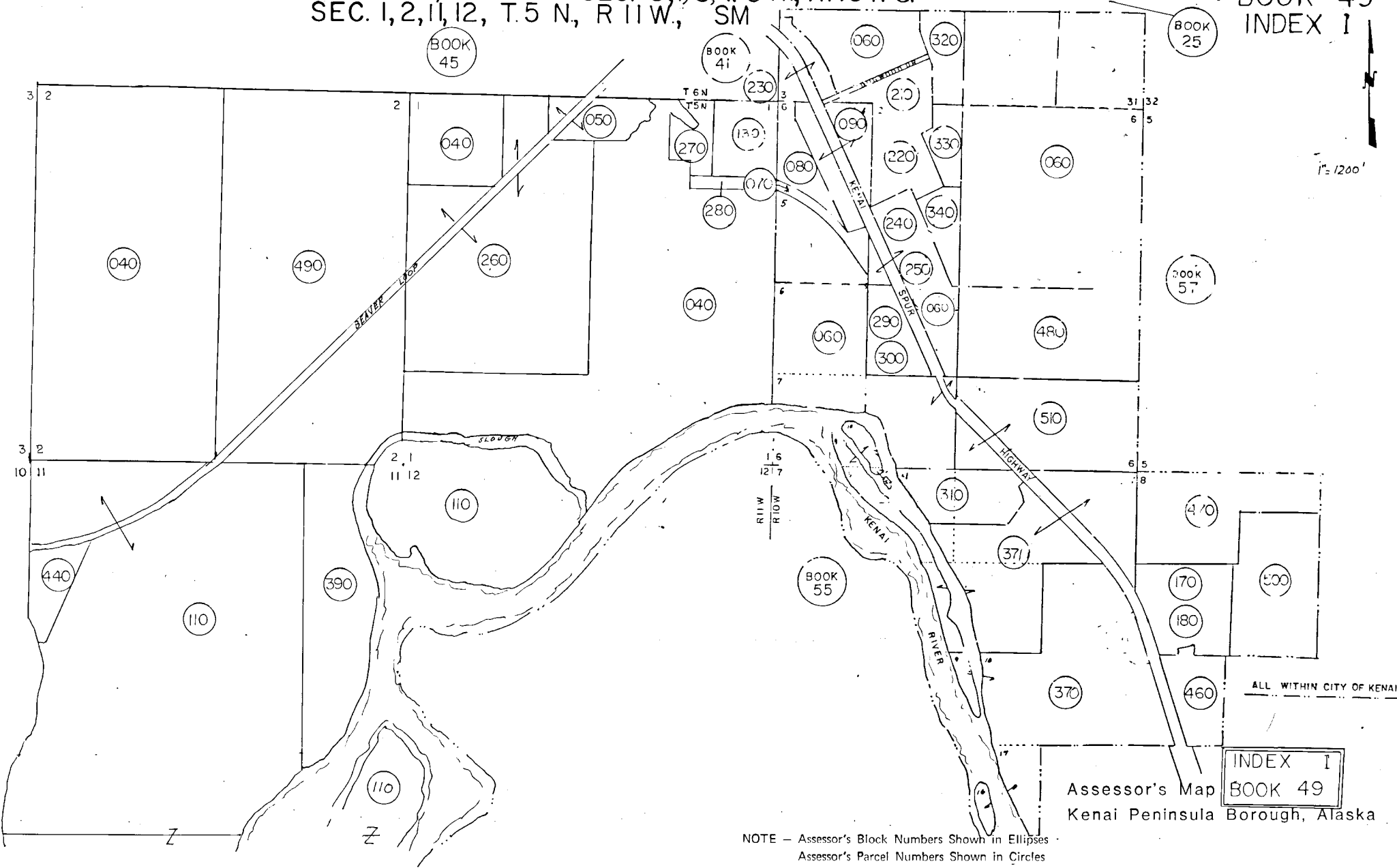

NOTE - Assessor's Block Numbers Shown in Ellipses
Assessor's Parcel Numbers Shown in Circles

Assessor's Map
Kenai Peninsula Borough, Alaska

INDEX I
BOOK 49

ALL WITHIN CITY OF KENAI