

POR. SEC. 13, 14, 23, 24, T6S, R14W, & POR. SEC. 18, 19, T6S, R13W, S. B. & M.

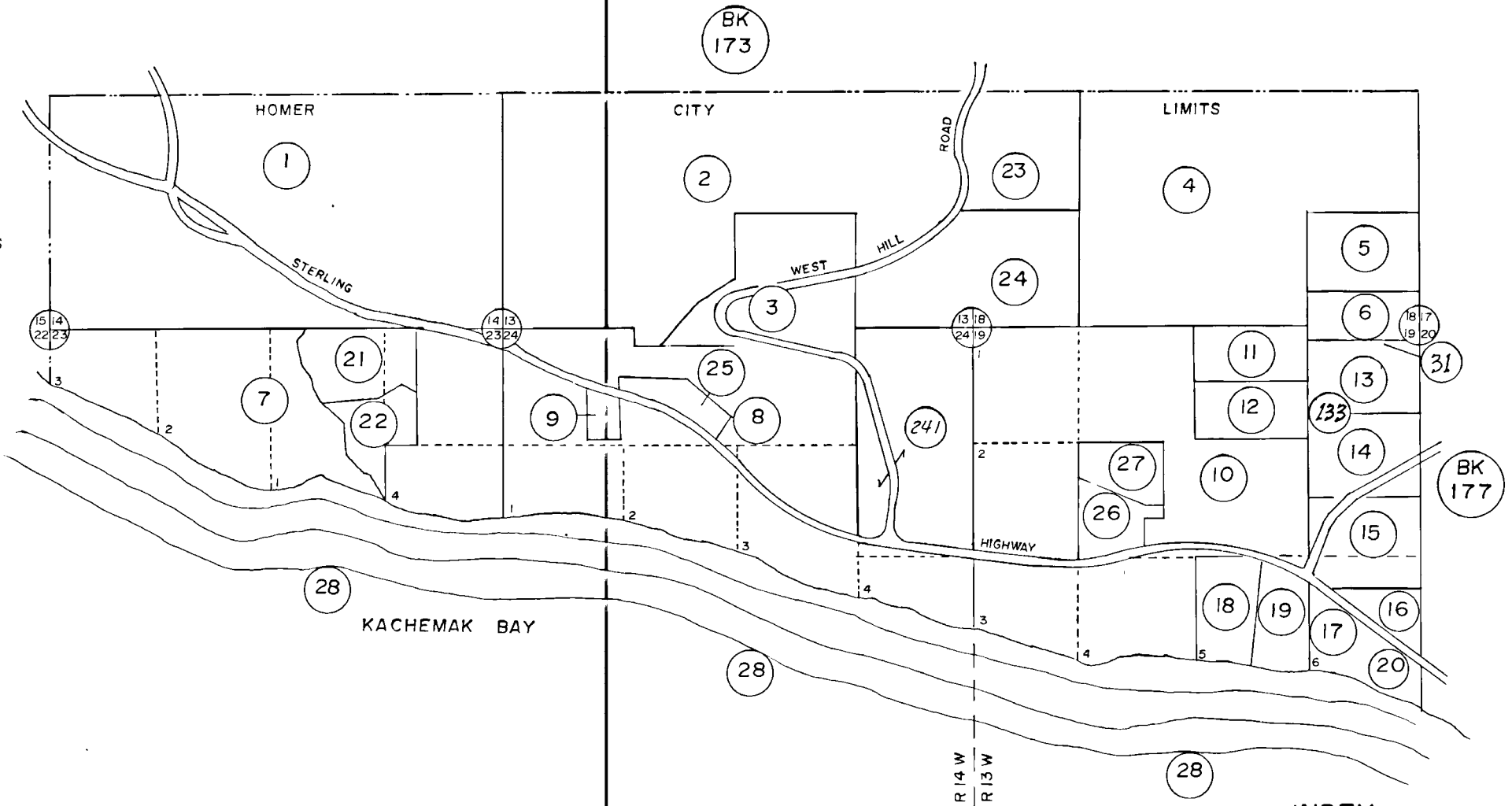

HOMER CITY REGR. REC. SUB.
87-37 R5

INDEX
BOOK 175

Assessor's Map
Kenai Peninsula Borough, Alaska

NOTE - Assessor's Block Numbers Shown in Ellipses
Assessor's Parcel Numbers Shown in Circles

NOTE: ALASKA TIDELANDS SURVEY
PG. 28