

KENAI PENINSULA BOROUGH
PLANNING COMMISSION RESOLUTION

RESOLUTION SN 2012-07

RENAMING CERTAIN PUBLIC RIGHTS-OF-WAY WITHIN SECTIONS 7, 12, 13, 14, & 27; T 5N, R 8W;
SEWARD MERIDIAN, AK; WITHIN EMERGENCY SERVICE NUMBER (ESN) 302

RENAMING CERTAIN PUBLIC RIGHTS-OF-WAY WITHIN SECTIONS 11, 12, 13, 15, 17, 21, 22, & 30; T
5N, R 9W; SEWARD MERIDIAN, AK; WITHIN EMERGENCY SERVICE NUMBER (ESN) 302

RENAMING CERTAIN PUBLIC RIGHTS-OF-WAY WITHIN SECTIONS 5, 8, 17, 19, 22, & 30; T 5N, R
10W; SEWARD MERIDIAN, AK; WITHIN EMERGENCY SERVICE NUMBER (ESN) 302

WHEREAS, a procedure has been developed to help implement the Enhanced 9-1-1 Street Naming and Addressing project; and

WHEREAS, eliminating duplicate and sound-alike street names will enable 9-1-1 Emergency Services to respond to emergencies in an efficient timely manner, thereby avoiding delays in providing necessary emergency services; and

WHEREAS, on September 10, 2012 public hearings were held by the Kenai Peninsula Borough Planning Commission to address all concerns about the proposed street name changes; and

WHEREAS, Chapter 14.10 of the Kenai Peninsula Borough Code of Ordinances authorizes the Planning Commission to accomplish street name changes by Resolution.

NOW, THEREFORE, BE IT RESOLVED BY THE PLANNING COMMISSION OF THE KENAI PENINSULA BOROUGH:

Section 1. That the rights-of-way listed below are renamed as follows:

DESCRIPTION	FROM	TO	BASE MAP
a. Morgan Rd/ Jet Dr originally named by KN0760129 Rolling Hills Subdivision (Jet Dr) & KN0780030 Salty Dog Heights Subdivision Part One (Morgan Rd); T 5N R 9W SECTIONS 15, 21 & 22; Seward Meridian, AK; off of Scout Lake Loop Rd in the Sterling Community; ESN 302	Morgan Rd / Jet Dr	Lou Morgan Rd	KR10 KR15 KR16
b. Ermine Way originally named by KN0760030 Naptowne Heights Subdivision; T 5N R 8W SECTION 7 Seward Meridian, AK; off of Otter Trail Rd in the Sterling Community; ESN 302	Ermine Way	Ermine Ave	KR11
c. Skilak St originally named by plat KN0001189 Panoramic Park Subdivision; T 5N R 9W SECTION 17 SEWARD MERIDIAN, AK; off of Tustumena St in the Sterling community; ESN 302	Skilak St	Skilak Ln	KR09
d. Alder St originally named by plat KN0730029 Greenacres Subdivision No 2; T 5N R 8W SECTION 27 SEWARD	Alder St	Alces Ave	KR13

MERIDIAN, AK; off of Feuding Ln in the Sterling Community; ESN 302			
e. Unnamed Rd (aka Gatten Rd) originally dedicated within KN0000995 Gatten Subdivision; T 5N R 8W SECTION 7; SEWARD MERIDIAN, AK; off of A Private Rd in the Sterling Community; ESN 302	Unnamed Rd	Mockingjay Ave	KR11
f. Unnamed Rd (aka Handley St) originally dedicated within KN0000858 Handley Subdivision No 1; T 5N R 9W SECTION 11; SEWARD MERIDIAN, AK; off of the Sterling Hwy in the Sterling Community; ESN 302	Unnamed Rd	Handley St	KR10
g. Ray St (aka Roy Ave) originally named by plat KN0000525 Sumpter Subdivision as Roy St; Certified by 1985 base map as Ray St; T 5N R 9W SECTIONS 12 & 13; SEWARD MERIDIAN, AK; off of Scout Lake Loop Rd and Great Land St in the Sterling Community; ESN 302	Ray St	Klondike Ave E Klondike Ave W	KR10
h. Karen Ln (aka Card Rd) originally named by plat KN0760176 Galliher Subdivision; T 5N R 8W SECTIONS 13 & 14; SEWARD MERIDIAN, AK; off of the Sterling Hwy in the Sterling Community; ESN 302	Karen Ln	Card St	KR12
i. Daughters Ave (aka Cooks Daughters Ave) originally named by plat KN0840082 Cook Estates as Cook Daughters Ave; Certified by 1985 base map as Daughters Ave; T 5N R 8W SECTION 12; SEWARD MERIDIAN, AK; off of Three Johns St in the Sterling community; ESN 302	Daughters Ave	Landess Ave	KR12
j. Hallelujah Dr (aka Hallelujah Trail Dr) originally named by plat KN0810114 Birch Hollow subdivision Part Two Mettille 1981 Addition as East Hallelujah Trail Dr; Certified by 1985 base map as Hallelujah Dr; T 5N R 9W SECTION 30; SEWARD MERIDIAN, AK; off of Dayspring St in the Sterling Community; ESN 302	Hallelujah Dr	<i>Retained</i>	KR16
k. 81 st Ave (aka N Strawberry Rd) originally named by plat KN0780011 Resubdivision No 2 of Tract 1 Matranga Subdivision; T 5N R 10W SECTION 5; SEWARD MERIDIAN, AK; off of Strawberry Rd in the Ridgeway community; ESN 302	81 st Ave	N Strawberry Rd	KR07
l. M St (aka Mink Ave) originally named by plat KN0770153 Rex W Eagle Homestead Tract B; T 5N R 10W SECTION 8; SEWARD MERIDIAN, AK; off of Chisik St in the Ridgeway community; ESN 302	M St	Mink Ave	KR07
m. Jakes Ct originally named by plat KN2001039 Young Estates; T 05N R 10W SECTION 22; SEWARD MERIDIAN, AK; off of Riggs Ave in the Ridgeway community; ESN 302	Jakes Ct	Jakes Cir	KR17

n. Unnamed Public Street (aka Marshall Dr) dedicated by plat KN0001059 Sunset Park Subdivision; T 05N R 10W SECTION 30; SEWARD MERIDIAN, AK; off of Knight Dr in the Ridgeway community; ESN 302	Unnamed Rd	Marshall St	KR18
o. Unnamed Right of Way (aka Old Kenai Spur) portion of the old alignment of the Kenai Spur Hwy commencing at Lancashire Dr and traveling southwest, concluding at the south section line for; T 05N R 10W SECTION 17; SEWARD MERIDIAN, AK; off of Lancashire Dr in the Ridgeway community; ESN 302	Unnamed Rd	Nicholas View Ln	KR07
p. Unnamed Right of Way (aka Poachers Cove St) dedicated by plat KN0001453 Rainbow Subdivision; T 5N R 10W SECTION 19; SEWARD MERIDIAN, AK; off of Big Eddy Rd in the Ridgeway community; ESN 302	Unnamed Rd	Poachers Cove St	KR18
q. Unnamed Right of Way (aka Sabaca Ln) dedicated within KN0001382 Hodgson Subdivision; T 05N R 10W SECTION 30; off of Spruce Ave in the Ridgeway Community; ESN 302	Unnamed Rd	Sabaca Rd	KR18

Section 2. That according to Kenai Peninsula Borough Code of Ordinance 14.10.030, the official street name map, 1:500 scale series base maps, Kenai River 7, 9, 10, 11, 12, 13, 15, 16, 17, & 18 are hereby amended to reflect these changes.

Section 3. That the map showing the location of the renamed rights-of-way be attached to, and made a permanent part of this resolution.

Section 4. That this Resolution takes effect immediately upon adoption.

ADOPTED BY THE PLANNING COMMISSION OF THE KENAI PENINSULA BOROUGH THIS

24 DAY OF September 2012.

Philip Bryson, Chairperson
Planning Commission

State of Alaska
Kenai Peninsula Borough

Signed and sworn to (or affirmed) in my presence this 24 day of September 2012 by
Philip Bryson

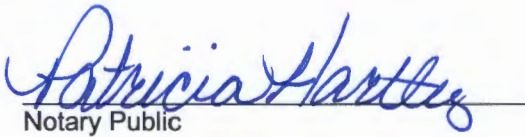
Notary Public

My Commission expires 3-7-13



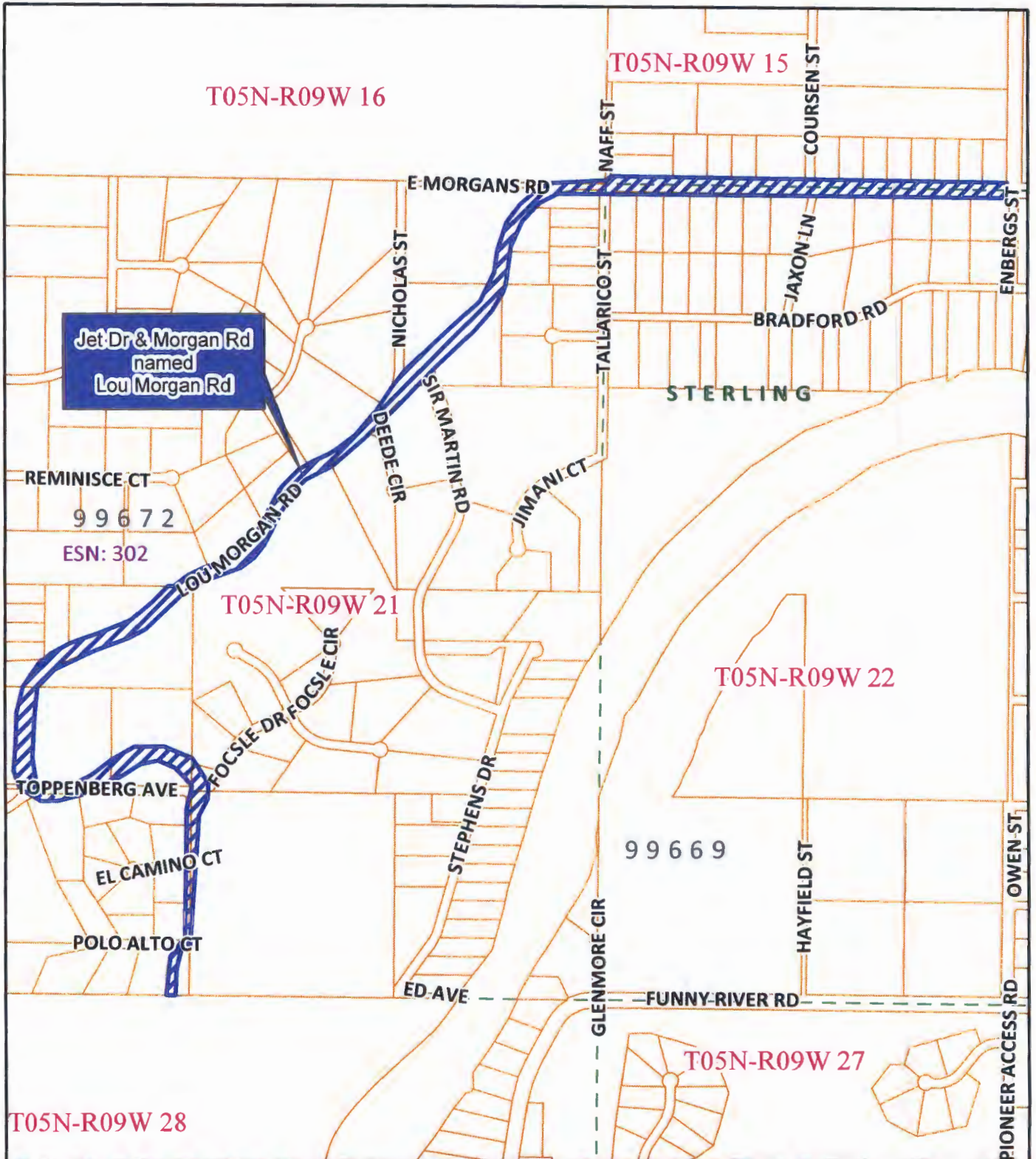

Jet Dr & Morgan Rd
named
Lou Morgan Rd

REMINISCE CT
99672
ESN: 302

T05N-R09W 21

T05N-R09W 22

99669

T05N-R09W 27

T05N-R09W 28



The information depicted hereon is for a graphical representation only of best available sources. The Kenai Peninsula Borough assumes no responsibility for any errors on this map.

09/11/2012

Kenai Peninsula Borough Planning Commission

Street Name Resolution 2012-07

Jet Dr/ Morgan Rd to Lou Morgan Rd

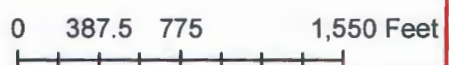

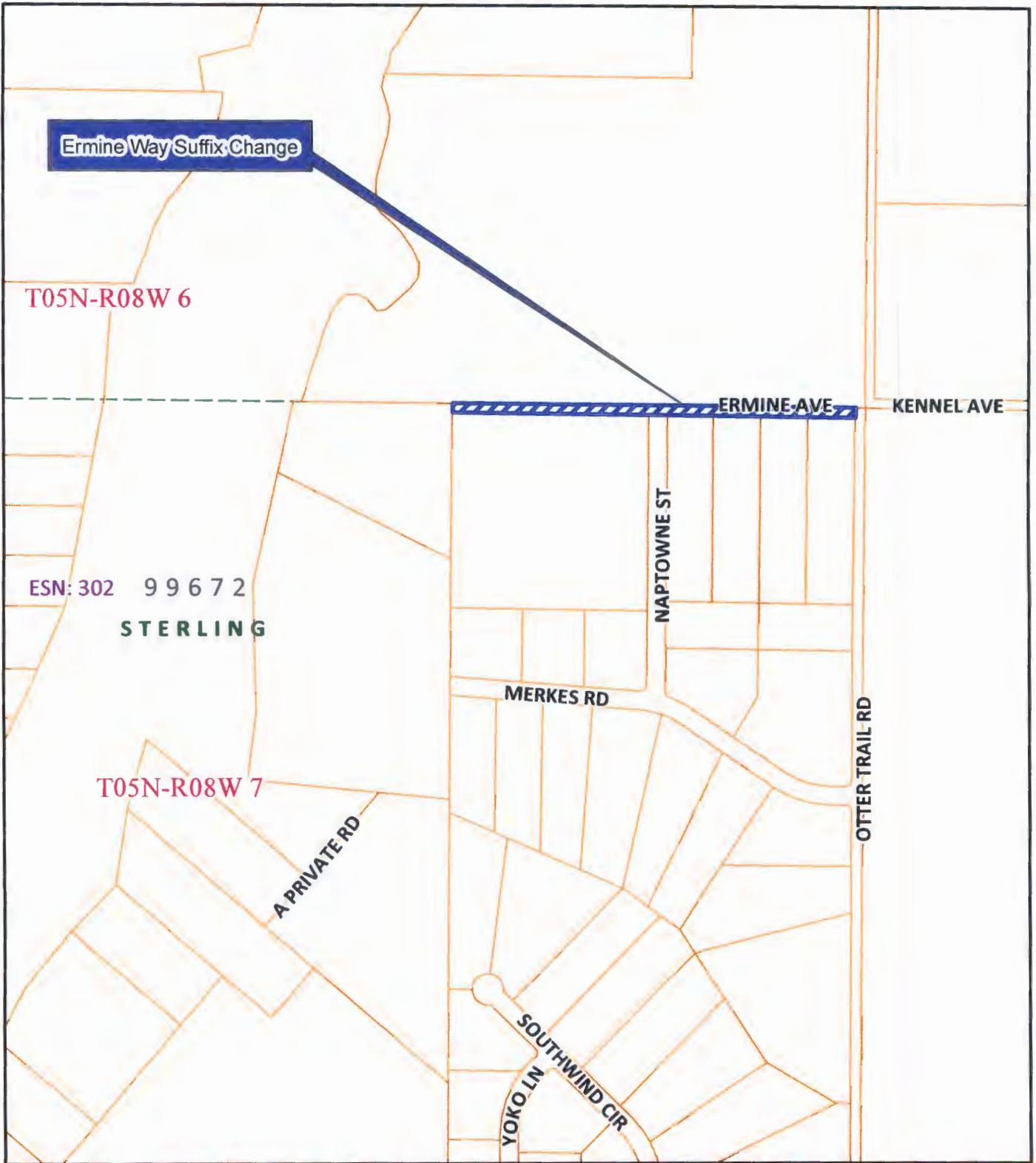

The information depicted hereon is for a graphical representation only of best available sources. The Kenai Peninsula Borough assumes no responsibility for any errors on this map.

09/11/2012

Kenai Peninsula Borough Planning Commission

Street Name Resolution 2012-07

Ermine Way to Ermine Ave

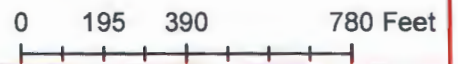

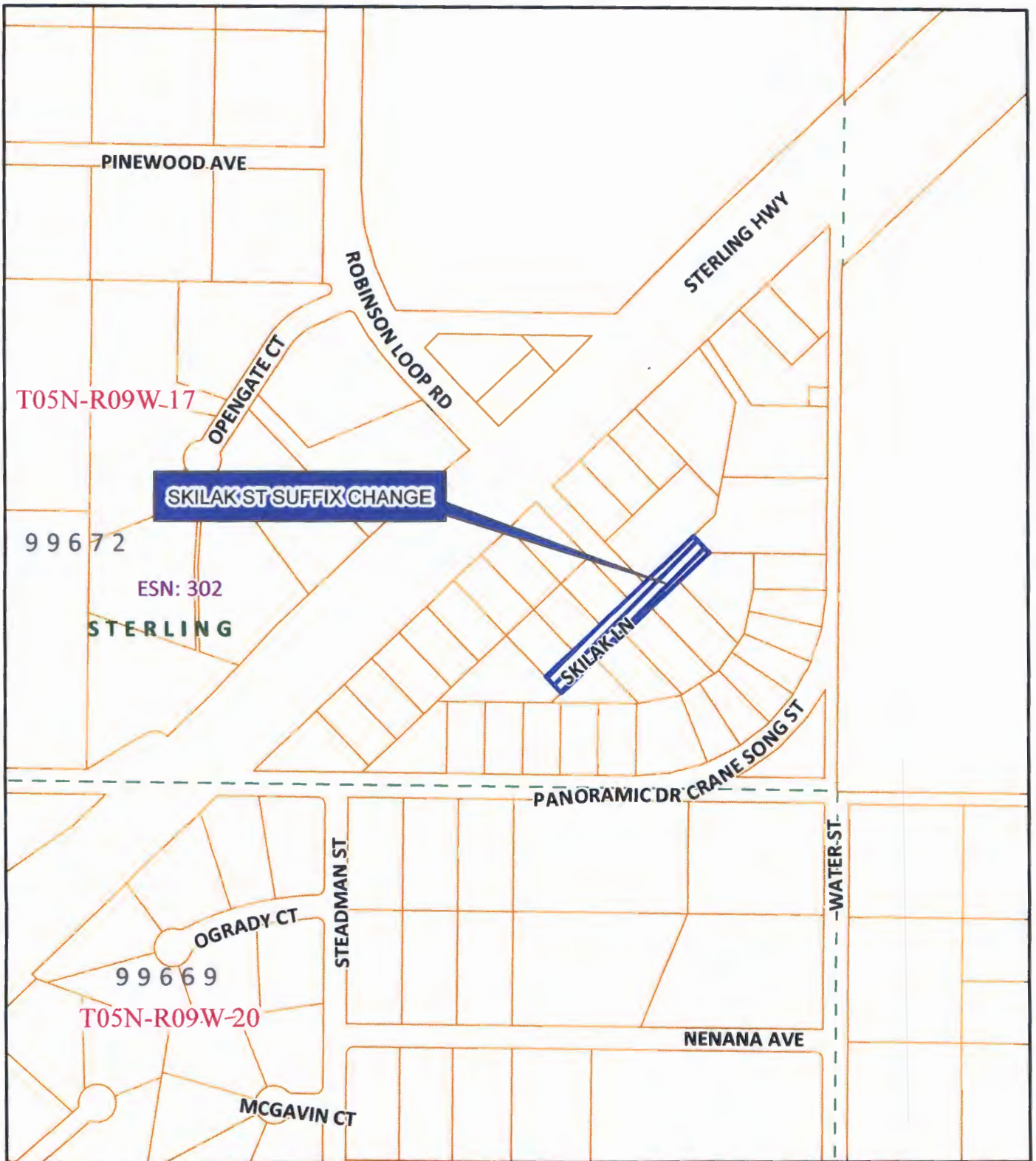

The information depicted hereon is for a graphical representation only of best available sources. The Kenai Peninsula Borough assumes no responsibility for any errors on this map.

09/11/2012

Kenai Peninsula Borough Planning Commission

Street Name Resolution 2012-07

SKILAK ST TO SKILAK LN

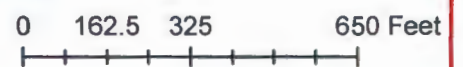

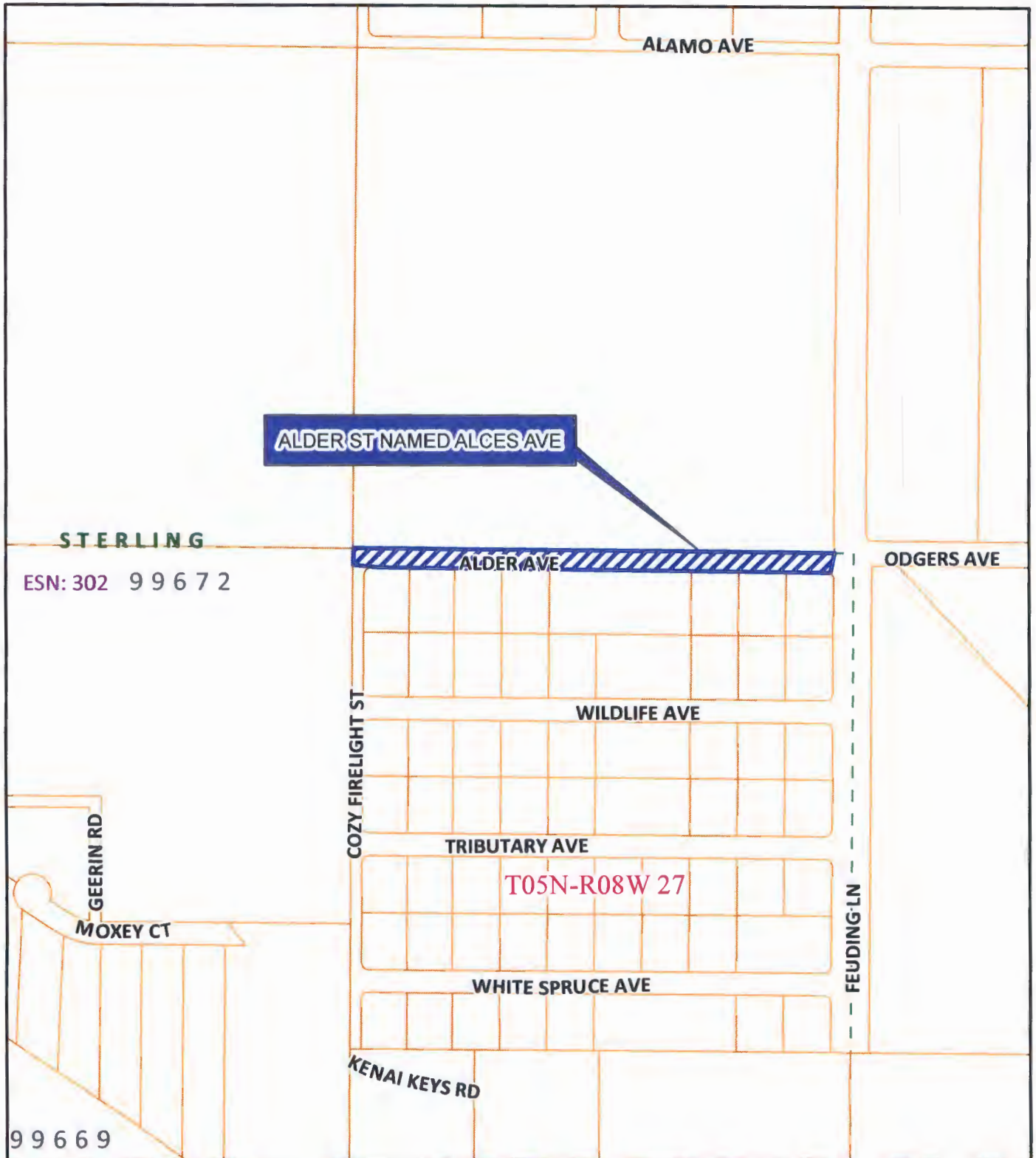

The information depicted hereon is for a graphical representation only of best available sources. The Kenai Peninsula Borough assumes no responsibility for any errors on this map.

09/11/2012

Kenai Peninsula Borough Planning Commission

Street Name Resolution 2012-07

Alder St to Alces Ave

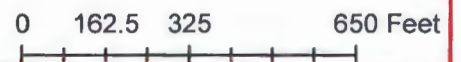

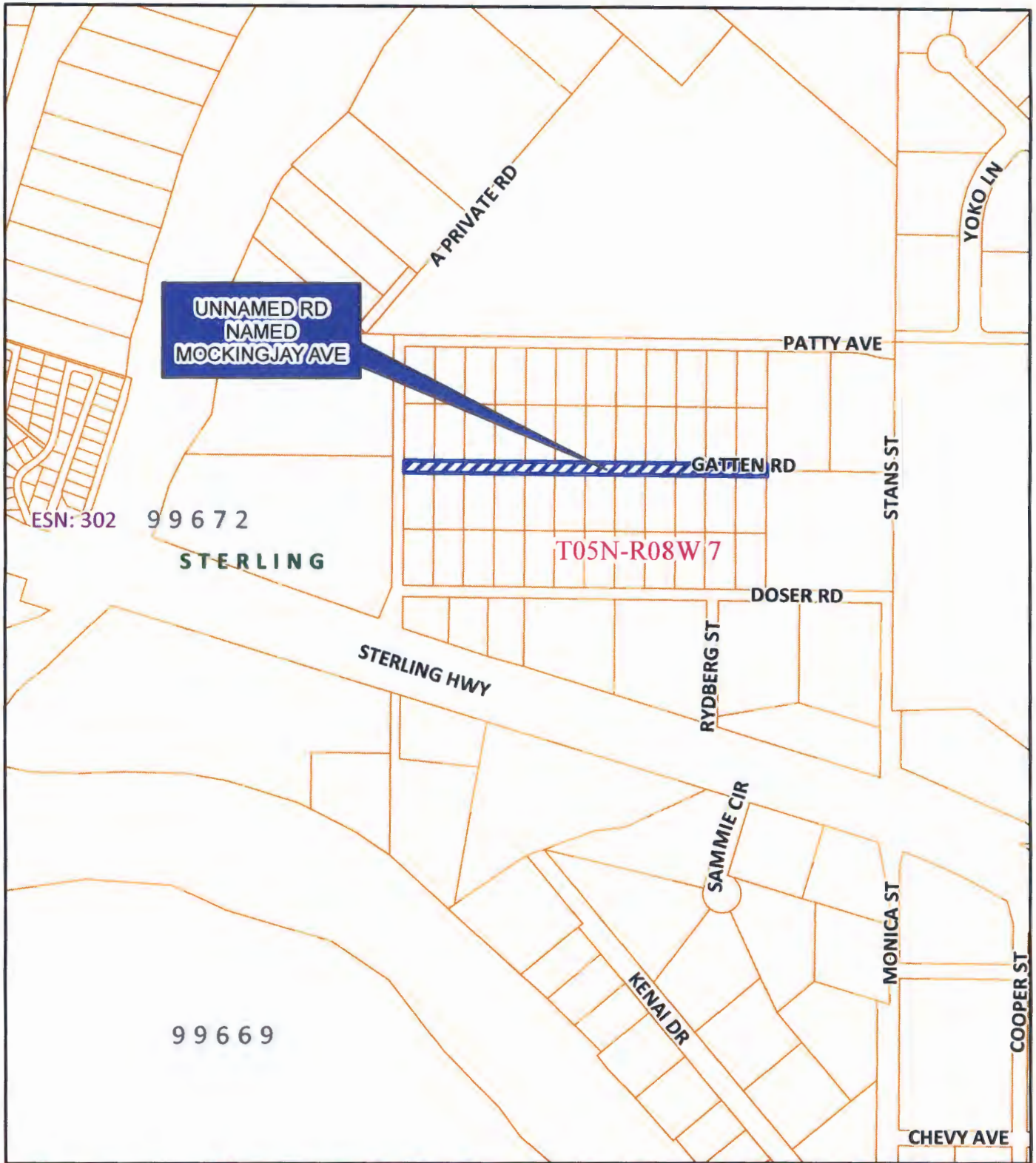

The information depicted hereon is for a graphical representation only of best available sources. The Kenai Peninsula Borough assumes no responsibility for any errors on this map.

09/11/2012

Kenai Peninsula Borough Planning Commission

Street Name Resolution 2012-07



UNNAMED RD (AKA GATTEN RD) TO MOCKINGJAY AVE

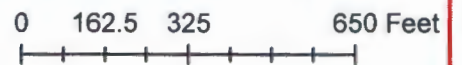

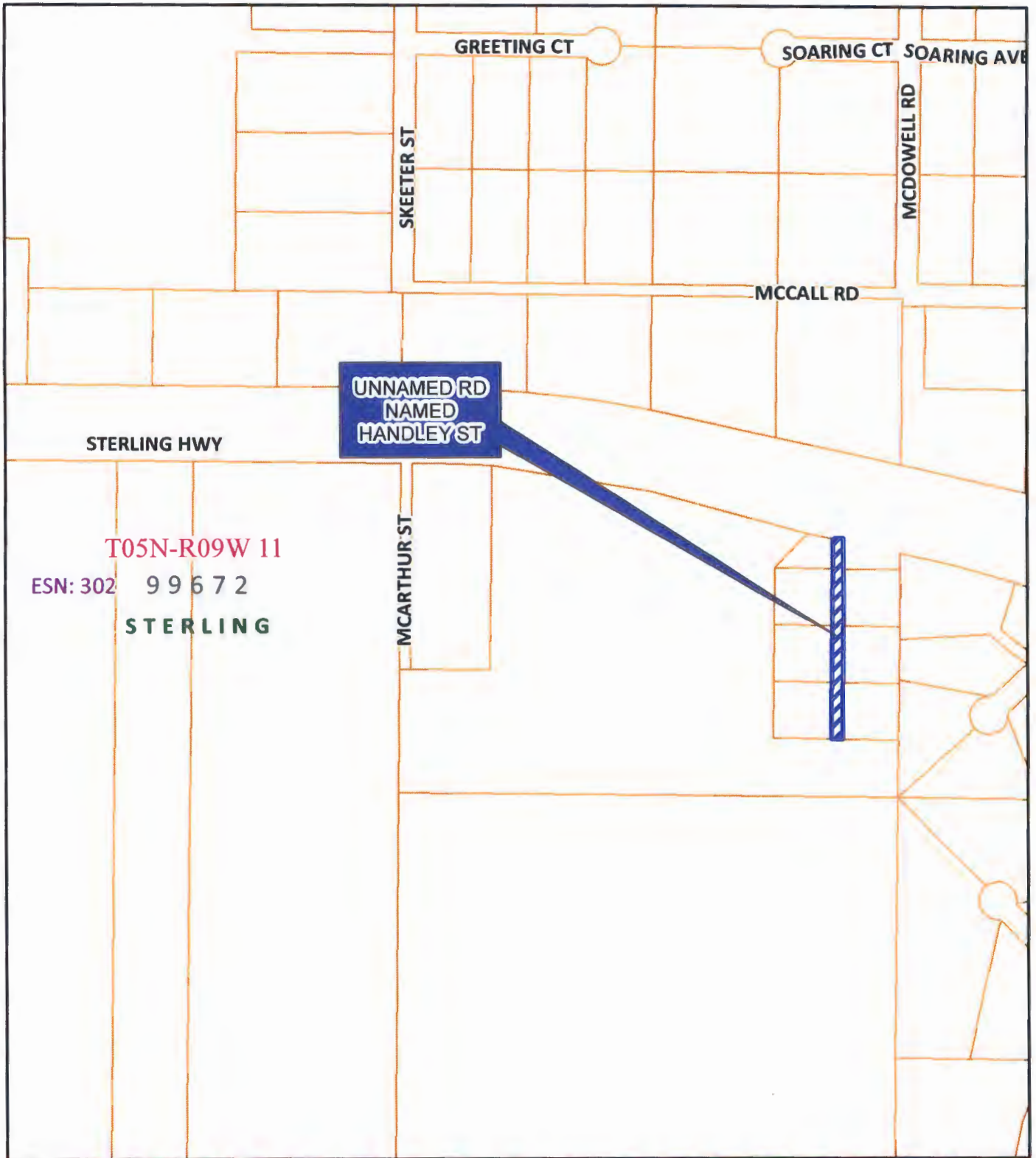

The information depicted hereon is for a graphical representation only of best available sources. The Kenai Peninsula Borough assumes no responsibility for any errors on this map.

09/11/2012

Kenai Peninsula Borough Planning Commission

Street Name Resolution 2012-07

UNNAMED RD TO HANDLEY ST

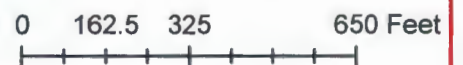

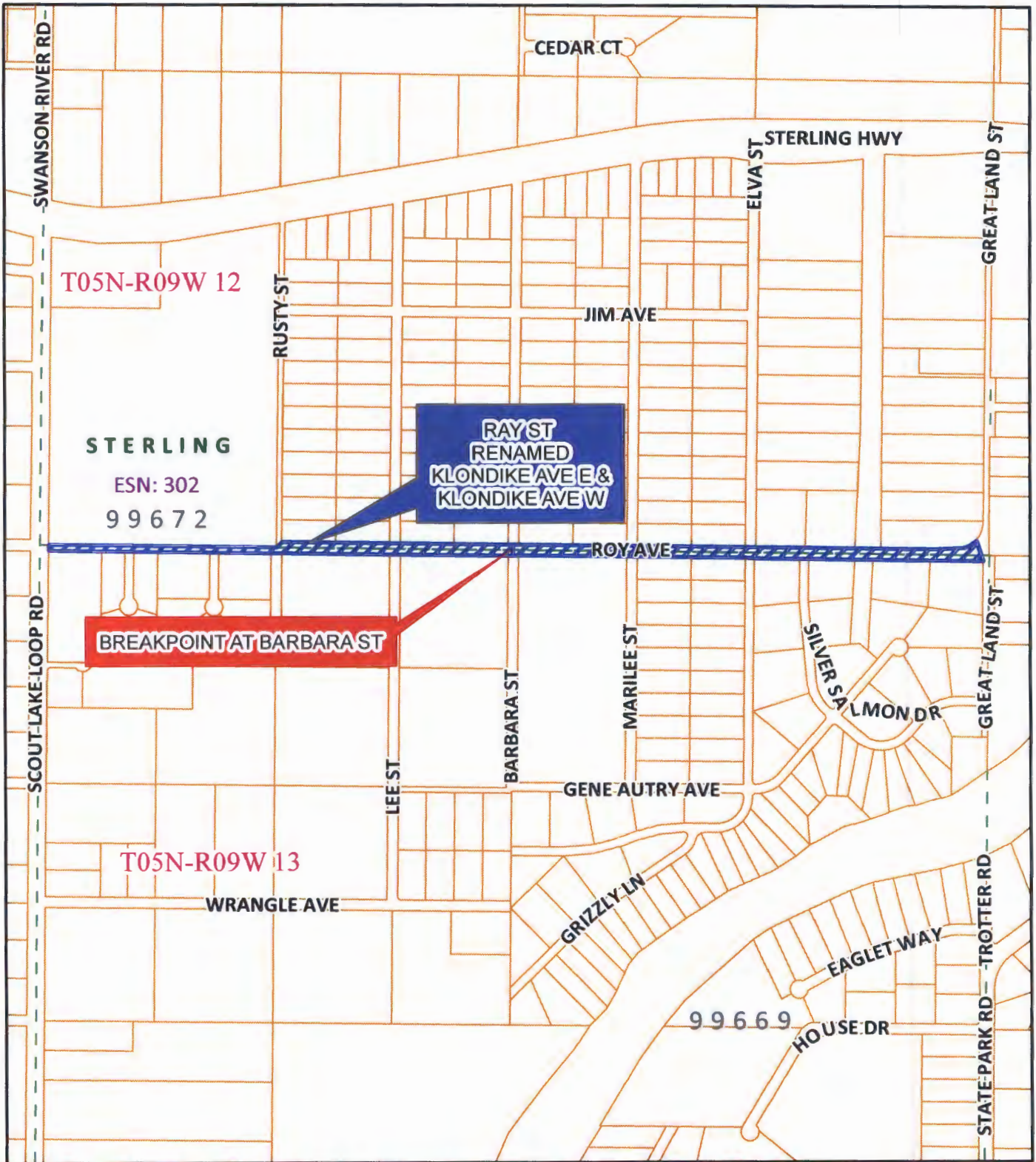

The information depicted hereon is for a graphical representation only of best available sources. The Kenai Peninsula Borough assumes no responsibility for any errors on this map.

09/11/2012

Kenai Peninsula Borough Planning Commission

Street Name Resolution 2012-07



RAY ST (AKA ROY AVE) TO KLONDIKE AVE E
 RAY ST (AKA ROY AVE) TO KLONDIKE AVE W



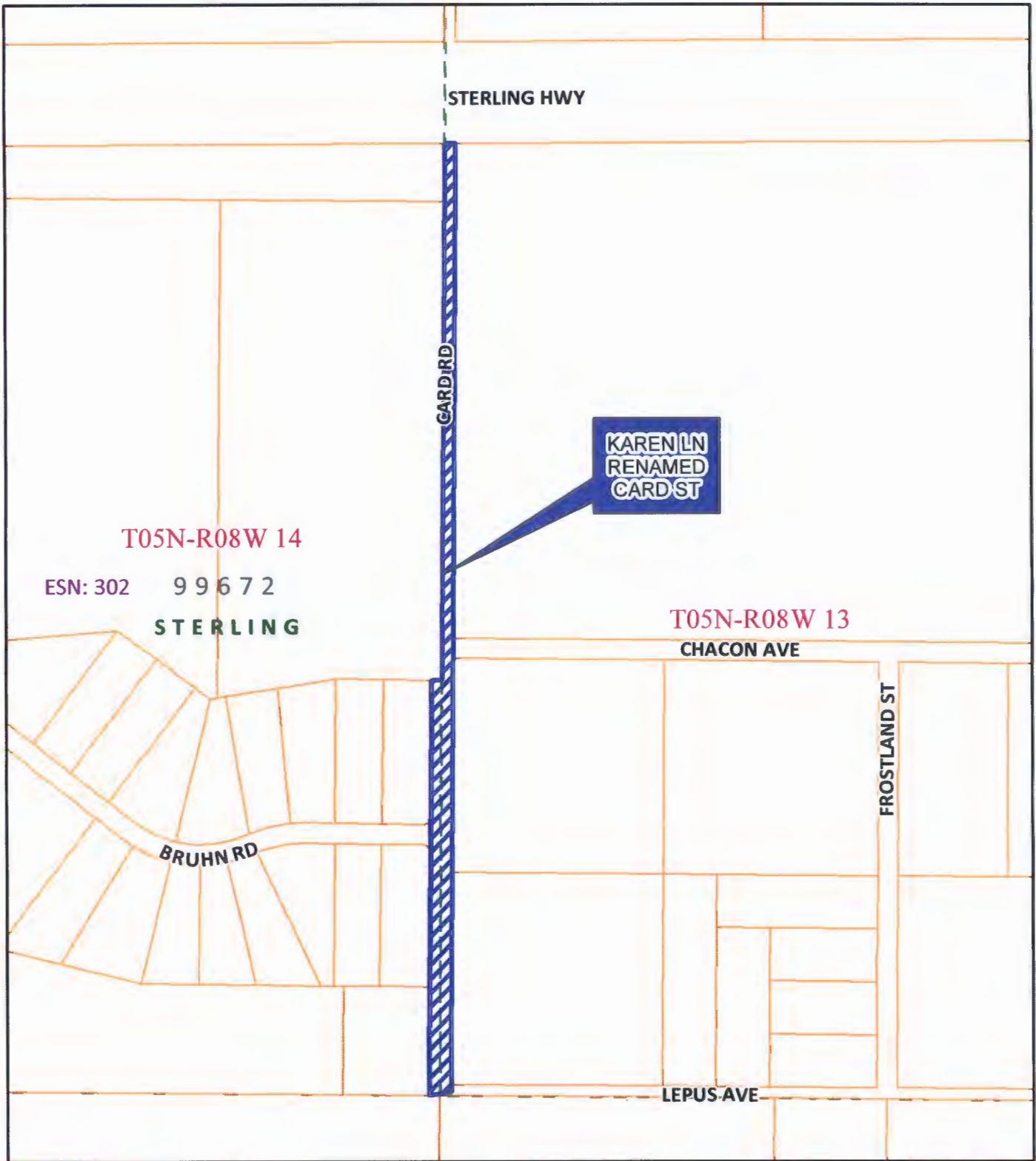

The information depicted hereon is for a graphical representation only of best available sources. The Kenai Peninsula Borough assumes no responsibility for any errors on this map.

09/11/2012

Kenai Peninsula Borough Planning Commission

Street Name Resolution 2012-07

KAREN LN (AKA CARD RD) TO CARD ST

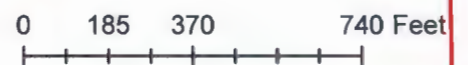

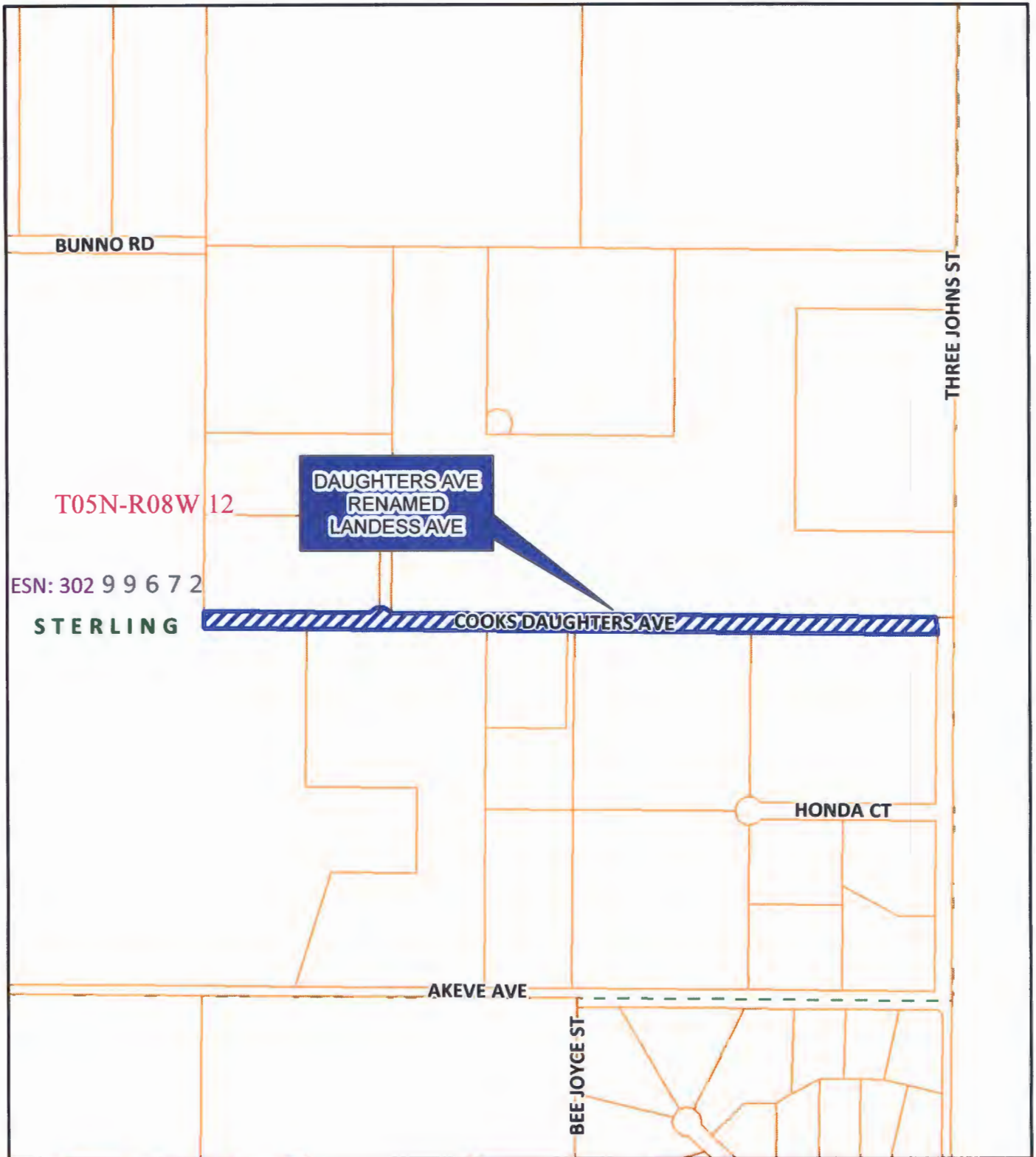

The information depicted hereon is for a graphical representation only of best available sources. The Kenai Peninsula Borough assumes no responsibility for any errors on this map.

09/11/2012

Kenai Peninsula Borough Planning Commission

Street Name Resolution 2012-07

**DAUGHTERS AVE (AKA COOKS DAUGHTERS AVE)
TO LANDESS AVE**





The information depicted hereon is for a graphical representation only of best available sources. The Kenai Peninsula Borough assumes no responsibility for any errors on this map.

09/11/2012

Kenai Peninsula Borough Planning Commission

Street Name Resolution 2012-07

HALLELUJAH DR (AKA HALLELUJAH TRAIL DR)
 HALLELUJAH DR (RETAINED)

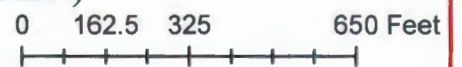

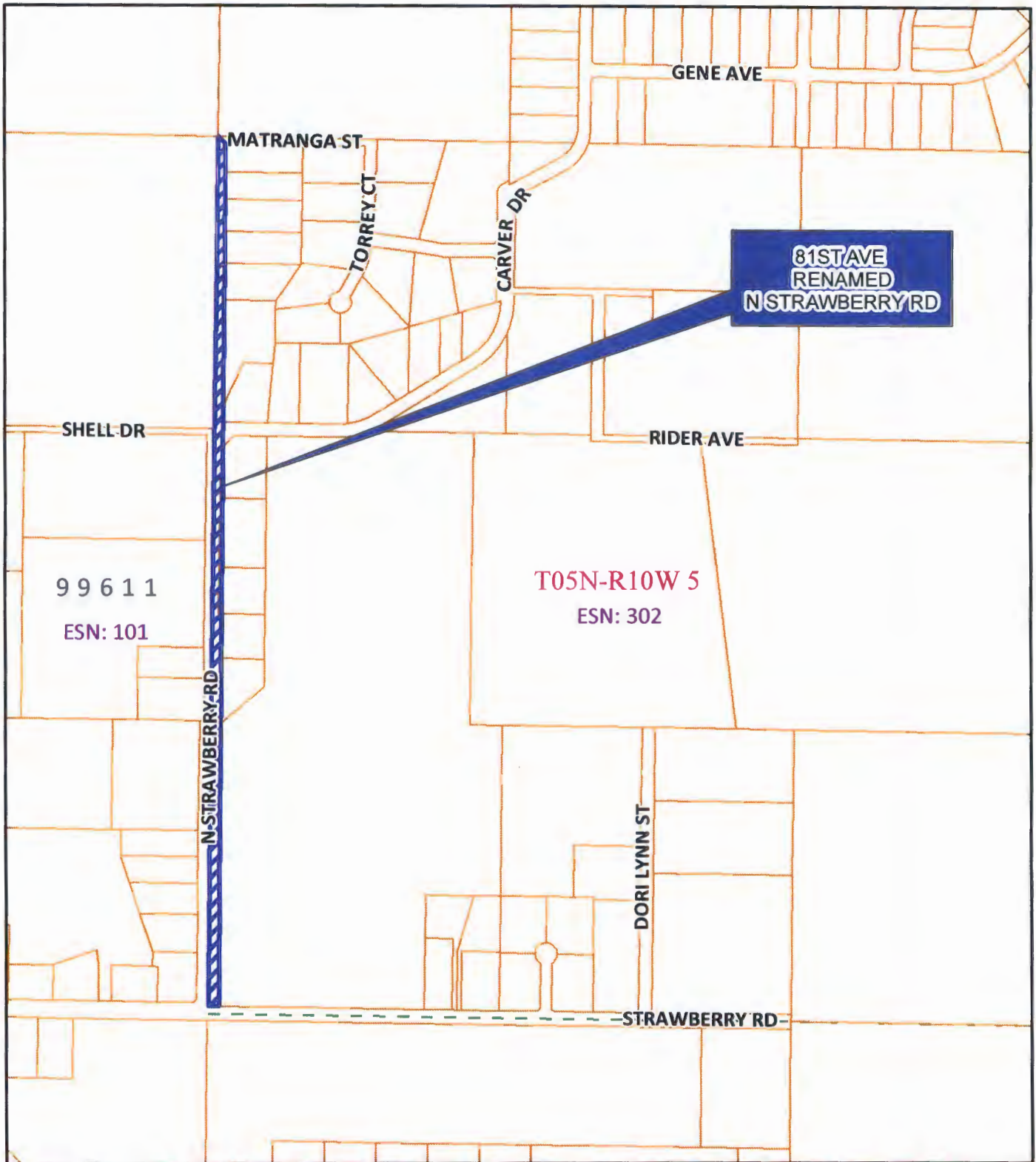

The information depicted hereon is for a graphical representation only of best available sources. The Kenai Peninsula Borough assumes no responsibility for any errors on this map.

09/11/2012

Kenai Peninsula Borough Planning Commission

Street Name Resolution 2012-07

81ST AVE TO N STRAWBERRY RD

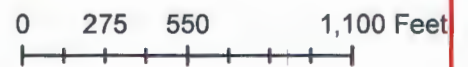



The information depicted hereon is for a graphical representation only of best available sources. The Kenai Peninsula Borough assumes no responsibility for any errors on this map.

09/11/2012

Kenai Peninsula Borough Planning Commission

Street Name Resolution 2012-07

M ST TO MINK AVE

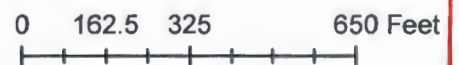

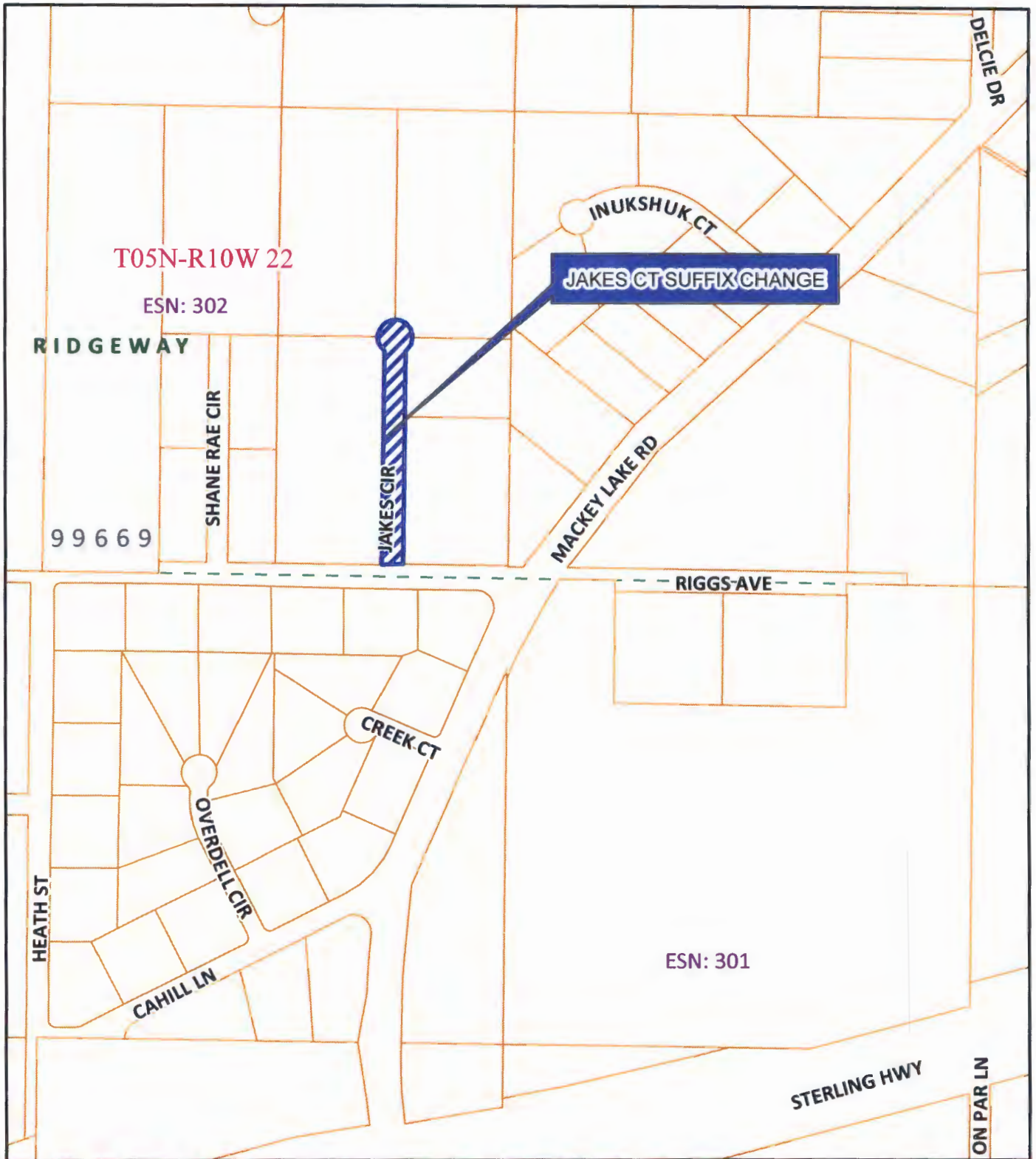

The information depicted hereon is for a graphical representation only of best available sources. The Kenai Peninsula Borough assumes no responsibility for any errors on this map.

09/11/2012

Kenai Peninsula Borough Planning Commission

Street Name Resolution 2012-07

JAKES CT TO JAKES CIR



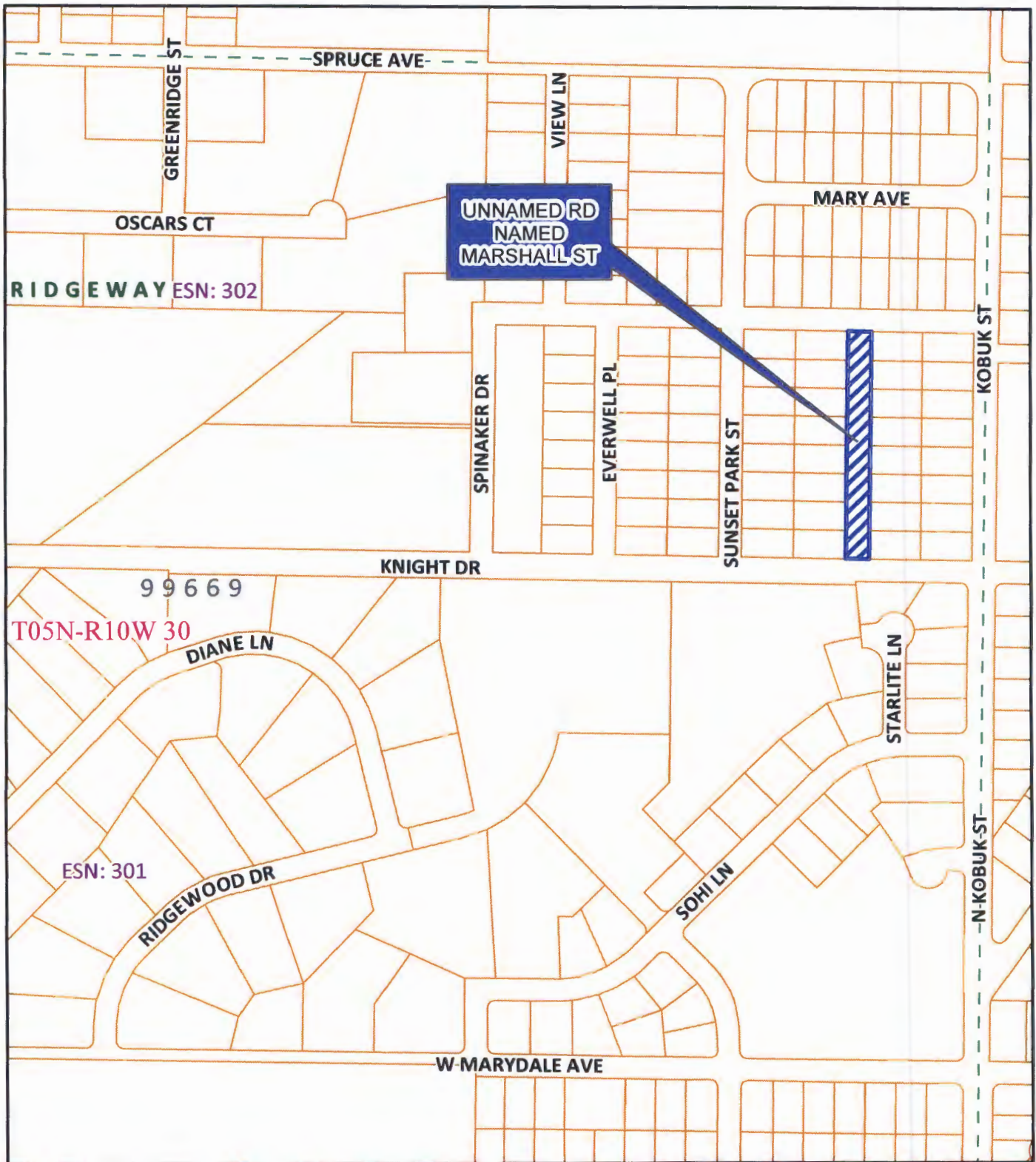

The information depicted hereon is for a graphical representation only of best available sources. The Kenai Peninsula Borough assumes no responsibility for any errors on this map.

09/11/2012

Kenai Peninsula Borough Planning Commission

Street Name Resolution 2012-07

UNNAMED RD (AKA MARSHALL DR)
TO MARSHALL ST

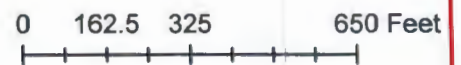

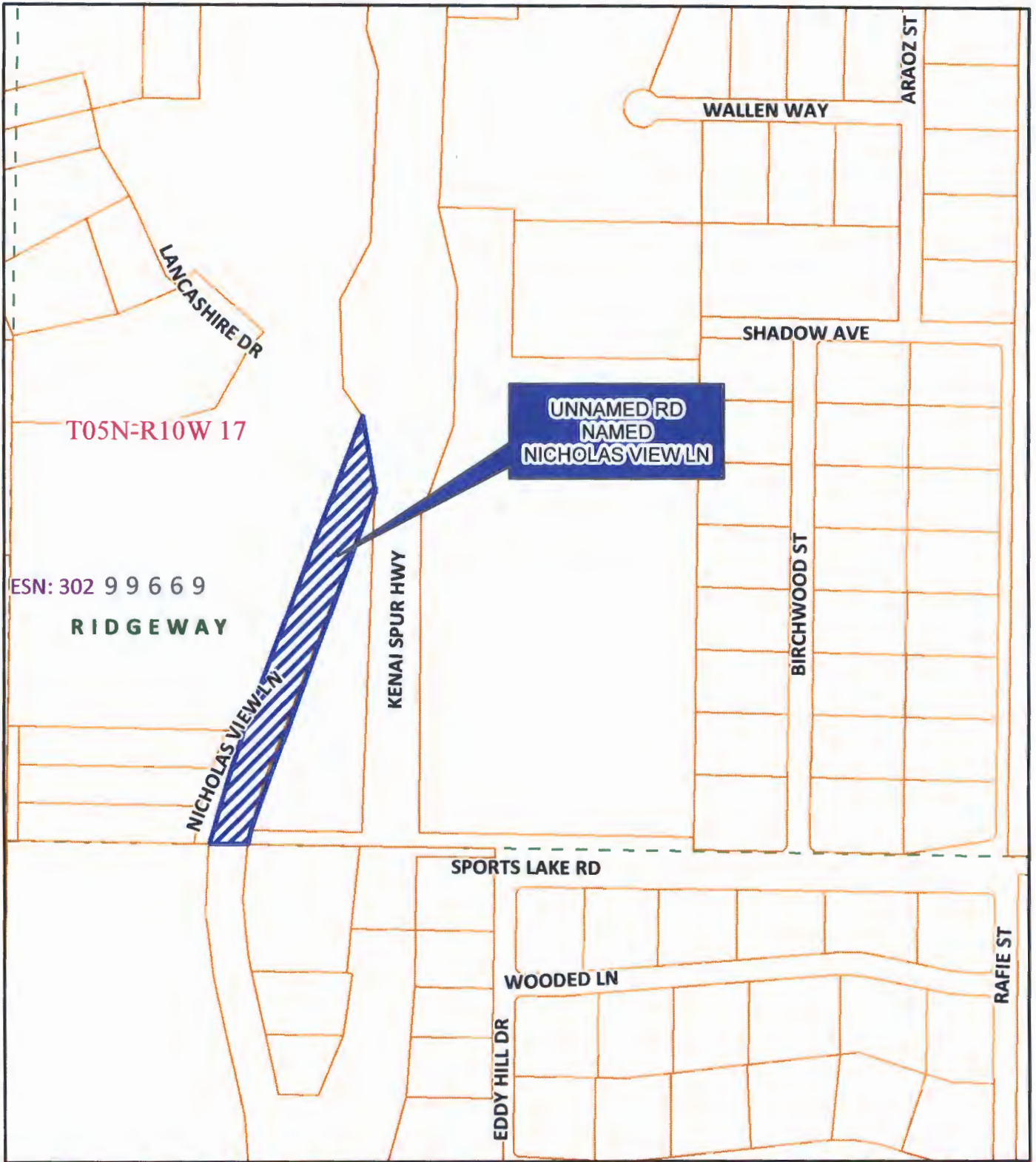

The information depicted hereon is for a graphical representation only of best available sources. The Kenai Peninsula Borough assumes no responsibility for any errors on this map.

09/11/2012

Kenai Peninsula Borough Planning Commission

Street Name Resolution 2012-07

UNNAMED RD (AKA OLD KENAI SPUR)
TO NICHOLAS VIEW LN

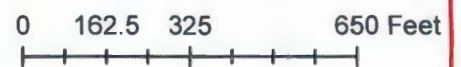

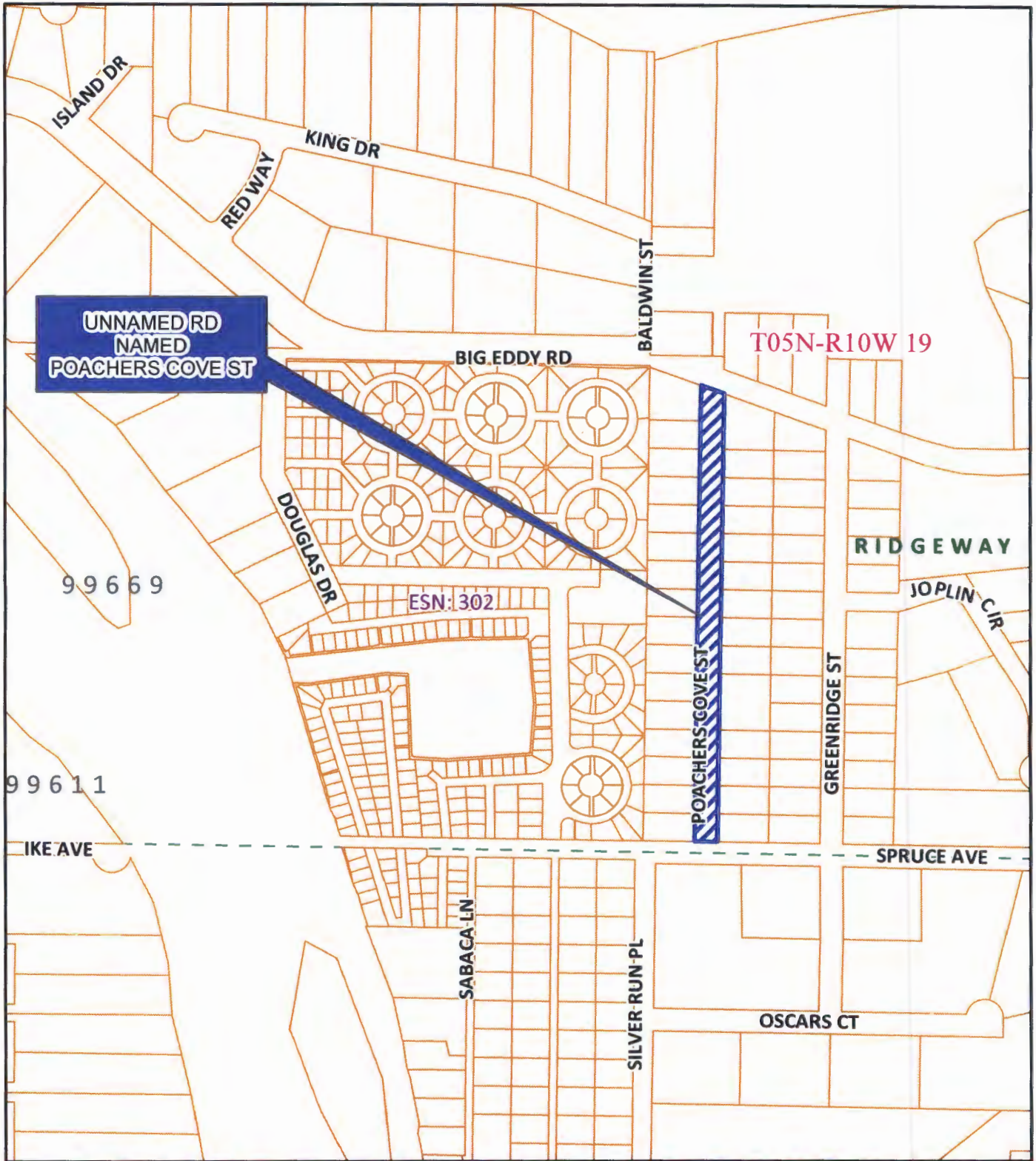

The information depicted hereon is for a graphical representation only of best available sources. The Kenai Peninsula Borough assumes no responsibility for any errors on this map.

09/11/2012

Kenai Peninsula Borough Planning Commission

Street Name Resolution 2012-07

UNNAMED RD TO POACHERS COVE ST



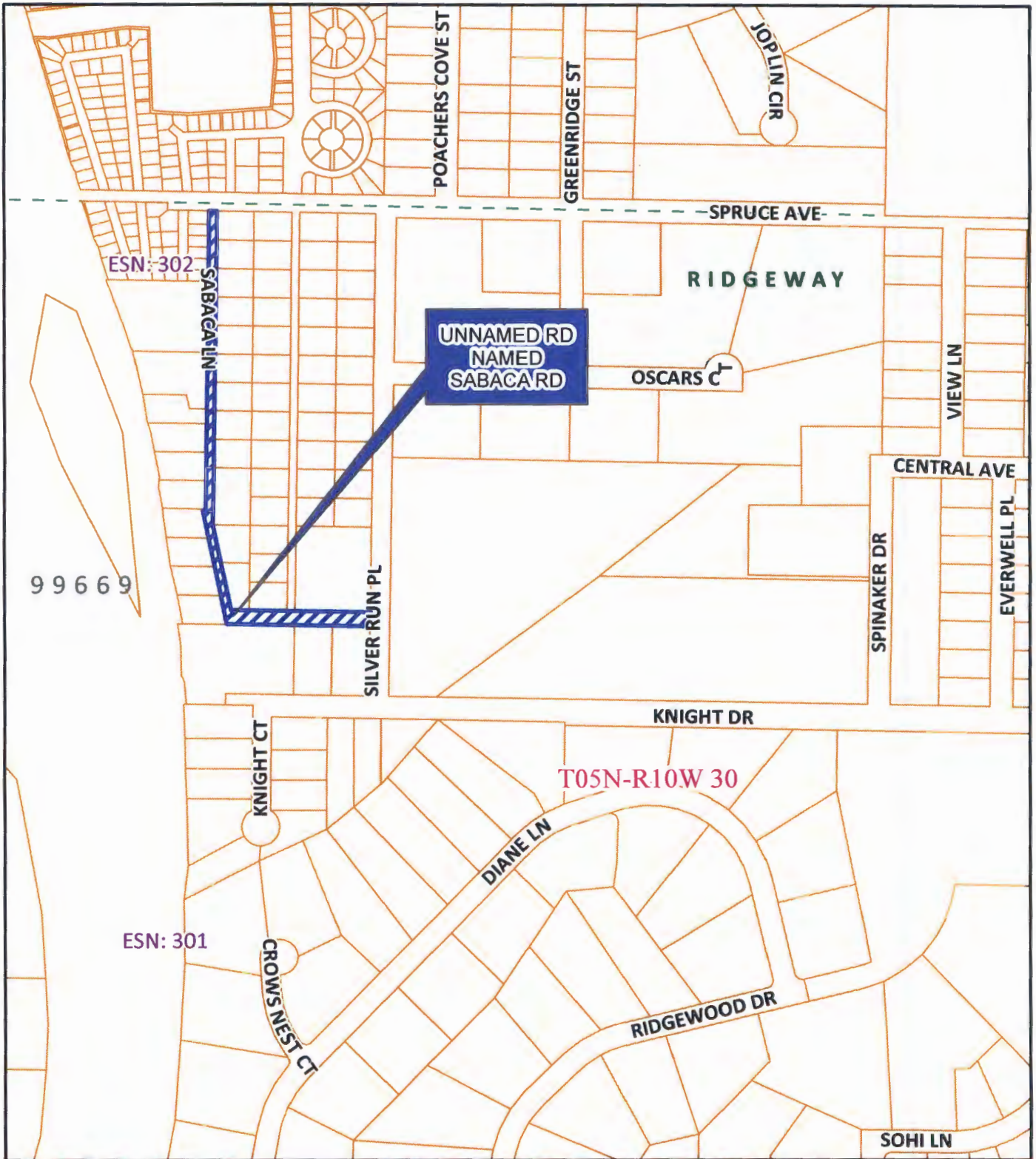

The information depicted hereon is for a graphical representation only of best available sources. The Kenai Peninsula Borough assumes no responsibility for any errors on this map.

09/11/2012

Kenai Peninsula Borough Planning Commission

Street Name Resolution 2012-07

UNNAMED RD (AKA SABACA LN) TO SABACA RD

