

KENAI PENINSULA BOROUGH
PLANNING COMMISSION RESOLUTION

RESOLUTION SN 2012-04

RENAMING CERTAIN PUBLIC RIGHTS-OF-WAY WITHIN SECTION 36, T 4S, R 11W;
SEWARD MERIDIAN, AK; WITHIN EMERGENCY SERVICE NUMBER (ESN) 202

RENAMING CERTAIN PUBLIC RIGHTS-OF-WAY WITHIN SECTIONS 6 & 7, T 5S, R 11W;
SEWARD MERIDIAN, AK; WITHIN EMERGENCY SERVICE NUMBER (ESN) 202

RENAMING CERTAIN PUBLIC RIGHTS-OF-WAY WITHIN SECTIONS 6, 13, 27, 28 & 31, T
5S, R 12W; SEWARD MERIDIAN, AK; WITHIN EMERGENCY SERVICE NUMBER (ESN) 202

RENAMING CERTAIN PUBLIC RIGHTS-OF-WAY WITHIN SECTION 6, T 6S, R 12W;
SEWARD MERIDIAN, AK; WITHIN EMERGENCY SERVICE NUMBER (ESN) 202

RENAMING CERTAIN PUBLIC RIGHTS-OF-WAY WITHIN SECTION 1, T 6S, R 13W;
SEWARD MERIDIAN, AK; WITHIN EMERGENCY SERVICE NUMBER (ESN) 202

RENAMING CERTAIN PUBLIC RIGHTS-OF-WAY WITHIN SECTION 12, T 6S, R 14W;
SEWARD MERIDIAN, AK; WITHIN EMERGENCY SERVICE NUMBER (ESN) 202

WHEREAS, a procedure has been developed to help implement the Enhanced 9-1-1 Street Naming and Addressing project; and

WHEREAS, eliminating duplicate and sound-alike street names will enable 9-1-1 Emergency Services to respond to emergencies in an efficient timely manner, thereby avoiding delays in providing necessary emergency services; and

WHEREAS, on August 13, 2012 public hearings were held by the Kenai Peninsula Borough Planning Commission to address all concerns about the proposed street name changes; and

WHEREAS, Chapter 14.10 of the Kenai Peninsula Borough Code of Ordinances authorizes the Planning Commission to accomplish street name changes by Resolution.

NOW, THEREFORE, BE IT RESOLVED BY THE PLANNING COMMISSION OF THE KENAI PENINSULA BOROUGH:

Section 1. That the rights-of-way listed below are renamed as follows:

DESCRIPTION	FROM	TO	BASE MAP
a. Glen Erin Ct within HM0880028 Glen Erin Subdivision originally named Kelly Ct; renamed by SN 2004-08; T 6S R 12W SECTION 6 SEWARD MERIDIAN, AK; off of Kaleen St in the Fritz Creek community; ESN 202	Glen Erin Ct	Cline Ct	AR71

b. Voznesenka Rd within HM0850031 Voznesenka Subdivision; T 4S R 11W SECTION 36 SEWARD MERIDIAN, AK; off of East End Rd within the Fox River community; ESN 202	Voznesenka Rd	Voznesenka Loop	AR21
c. Hanging Cir within HM0810032 Skipper's View originally named Strawberry St; renamed by SN 2003-10; T06S R13W SECTION 1 SEWARD MERIDIAN, AK; off of Waterman Rd within the Fritz Creek community; ESN 202	Hanging Cir	Waterman Rd	AR70
d. Langhus Dr within HM0720202 Lind – Urch- Langhus Subdivision; T 05S R 12 W SECTION 13 SEWARD MERIDIAN, AK; off of Wyoh Way and Wild Haven Rd within the Fritz Creek Community; ESN 202	Langhus Dr	Langhus St N Langhus St S	AR38 AR39
e. Glacier View Rd within HM0770017 Fernwood Subdivision Unit 3 & HM0800023 C & H Estates; T05S R 12W SECTIONS 6 & 31 SEWARD MERIDIAN, AK; off of Fernwood Dr and Taku Ave within the Fritz Creek community; ESN 202	Glacier View Rd	Glacier View Rd N Glacier View Rd S	AR59 AR70 AR71
f. Taku Ave within HM0760076 Fernwood Subdivision Unit 2 & HM0800023 C & H Estates originally named Clove Ave; renamed by SN 2005-06; T 06S R 12W SECTION 6 SEWARD MERIDIAN, AK; off of Fernwood Dr and Portlock Dr; ESN 202	Taku Ave	Taku Ave E Taku Ave W	AR71
g. Saber Ave originally named by HM0690338 Spruce Woods Subdivision 1969 Addition as Saber St; renamed by SN 2011-18; T 05S R 12W SECTION 28 SEWARD MERIDIAN, AK; off of Greer Rd and Yukon St within the Fritz Creek community; ESN 202	Saber Ave	Saber Ave E Saber Ave W	AR59
h. Hill Ave originally named by HM0740012 Wilshire Acres Subdivision as Westland Dr; renamed by SN 1997-02 to Hill St; suffix change to Ave by Planning Commission Action 4/27/1998; T 05S R 12W SECTIONS 27 & 28 SEWARD MERIDIAN, AK; off of Greer Rd & Chelsey St within the Fritz Creek community; ESN 202	Hill Ave (west of Greer Rd) Hill Ave (east of Greer Rd)	Hill Ave (retained) Finn Ave E Finn Ave W	AR59 AR58
i. Upland St within HM0760016 Glacierview Farm & HM0820004 Mountain Glacier Estates Part Three; T	Upland St	Upland St N Upland St S	AR39

05S R 11W SECTIONS 6 & 7 SEWARD MERIDIAN, AK; off of East End Rd & Mossberry Ave within the Fritz Creek community; ESN 202			
j. Pitzman Ave (East of Diamond Ridge Rd) within HM0750004 Ridgewood Estates Subdivision Unit 1; T 06S R 14W SECTION 12 SEWARD MERIDIAN, AK; off of Diamond Ridge Rd within the Diamond Ridge community; ESN 202	Pitzman Ave (east of Diamond Ridge Rd)	Bidarki Dr	AR68

Section 2. That according to Kenai Peninsula Borough Code of Ordinance 14.10.030, the official street name map, 1:500 scale series base maps, Anchor River 21, 38, 39, 58, 59, 68, 70, & 71 are hereby amended to reflect these changes.

Section 3. That the map showing the location of the renamed rights-of-way be attached to, and made a permanent part of this resolution.

Section 4. That this Resolution takes effect immediately upon adoption.

ADOPTED BY THE PLANNING COMMISSION OF THE KENAI PENINSULA BOROUGH THIS 27 DAY OF August 2012.

 Blair Martin, Vice Chairperson
 Planning Commission

State of Alaska
 Kenai Peninsula Borough

Signed and sworn to (or affirmed) in my presence this 27 day of August 2012 by Blair Martin.

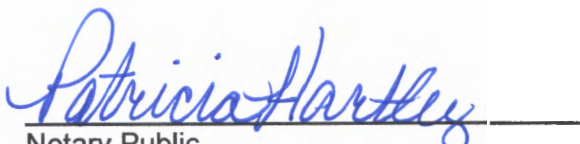
 Notary Public

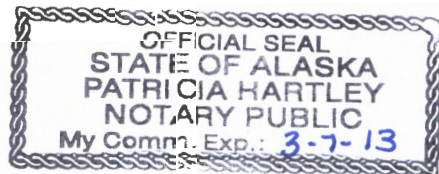

My Commission expires 3-7-13

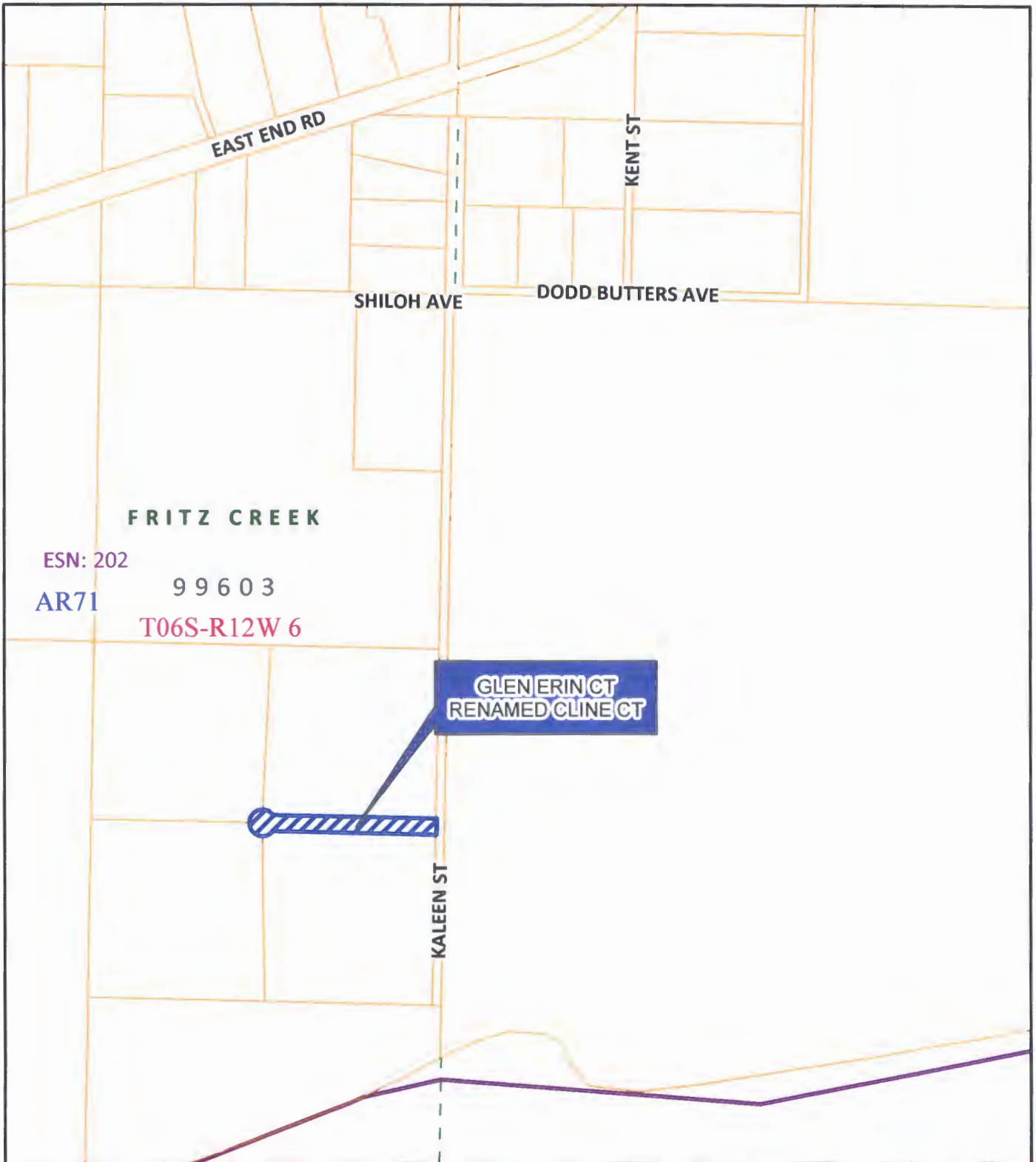

ESN: 202

AR71

99603

T06S-R12W 6

GLEN ERIN CT
RENAMED CLINE CT

KALEEN ST



The information depicted hereon is for a graphical representation only of best available sources. The Kenai Peninsula Borough assumes no responsibility for any errors on this map.

08/14/2012

KENAI PENINSULA BOROUGH PLANNING COMMISSION

STREET NAME RESOLUITON 2012-04

GLEN ERIN CT TO CLINE CT



0 225 450 900 Feet



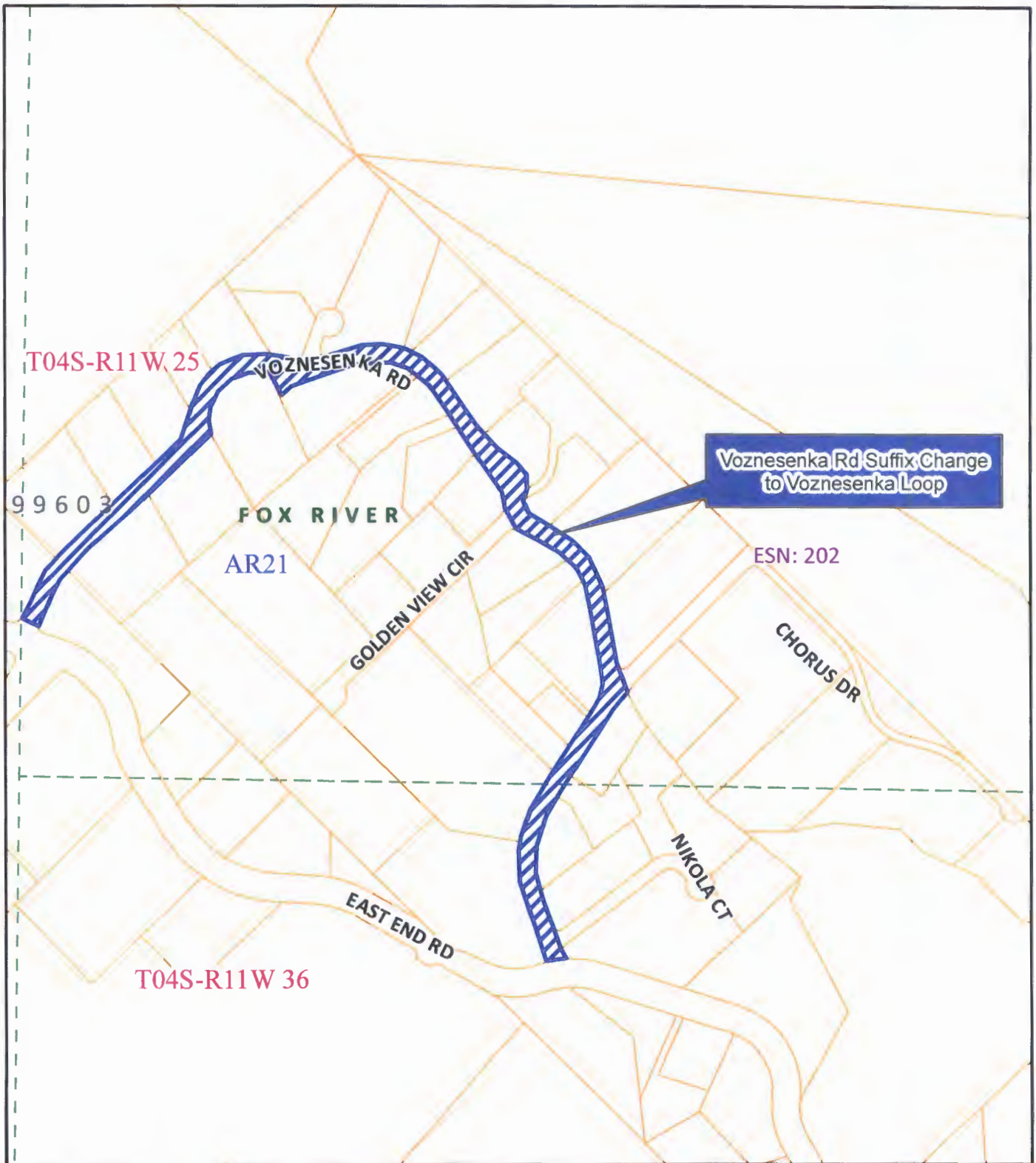

The information depicted hereon is for a graphical representation only of best available sources. The Kenai Peninsula Borough assumes no responsibility for any errors on this map.

08/14/2012

KENAI PENINSULA BOROUGH PLANNING COMMISSION

STREET NAME RESOLUTION 2012-04

VOZNESENKA RD TO VOZNESENKA LOOP

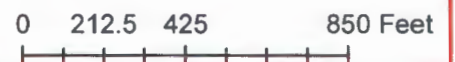

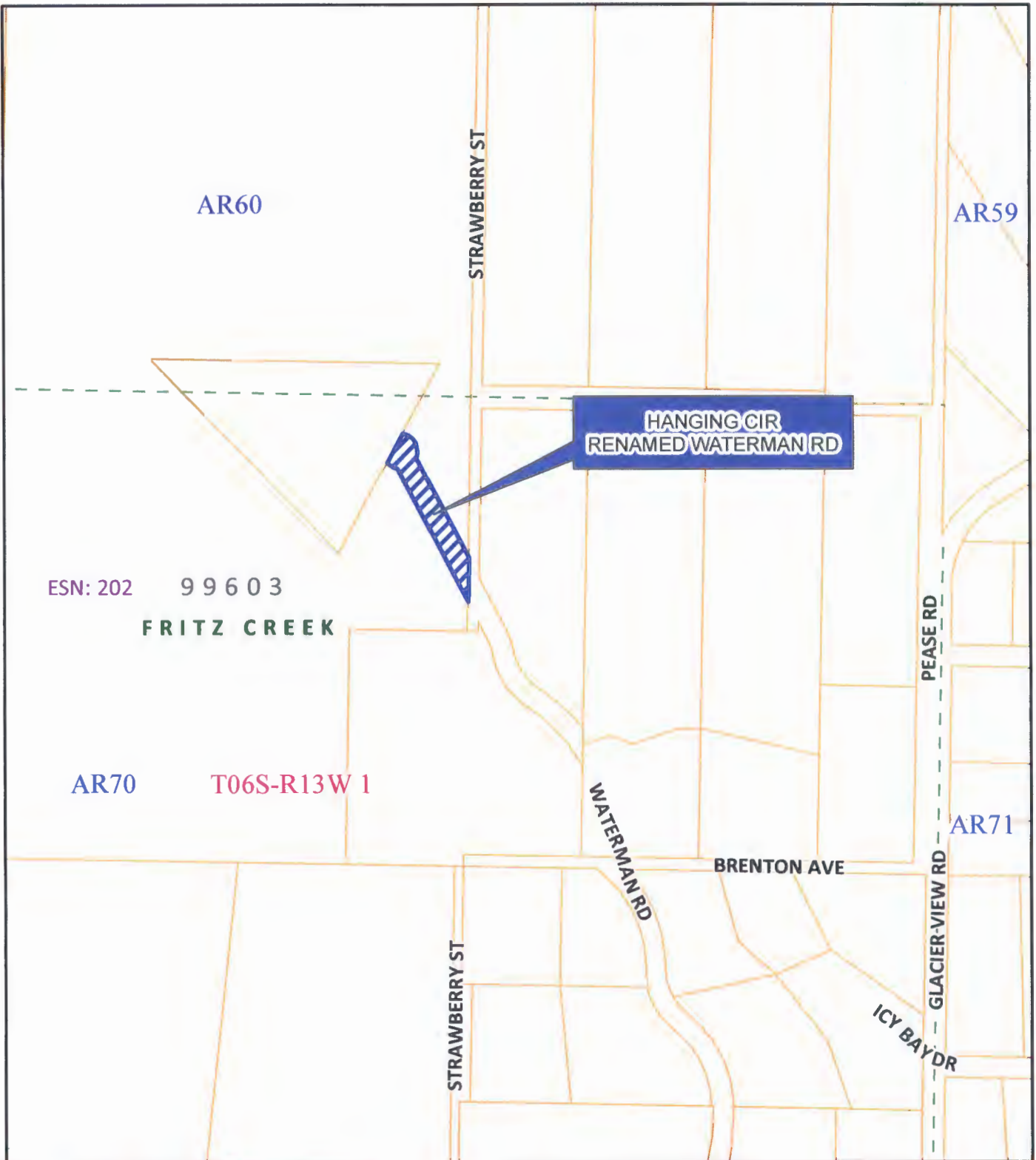

The information depicted hereon is for a graphical representation only of best available sources. The Kenai Peninsula Borough assumes no responsibility for any errors on this map.

08/14/2012

KENAI PENINSULA BOROUGH PLANNING COMMISSION

STREET NAME RESOLUTION 2012-04

HANGING CIR TO WATERMAN RD



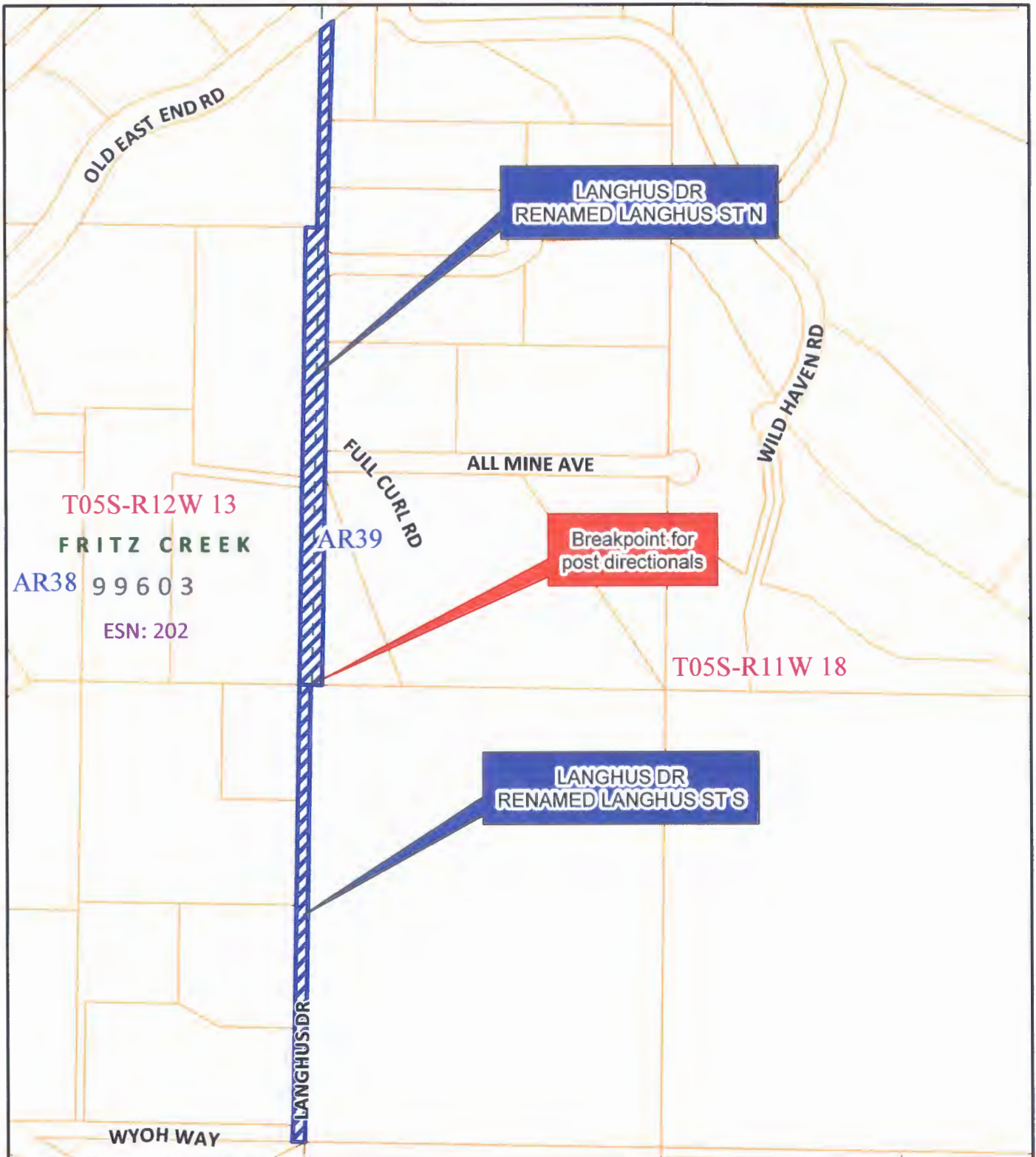

T05S-R12W 13
 FRITZ CREEK
 AR38 99603
 ESN: 202

AR39

T05S-R11W 18



The information depicted hereon is for a graphical representation only of best available sources. The Kenai Peninsula Borough assumes no responsibility for any errors on this map.

08/14/2012

KENAI PENINSULA BOROUGH PLANNING COMMISSION

STREET NAME RESOLUTION 2012-04

LANGHUS DR TO LANGHUS ST N & LANGHUS ST S



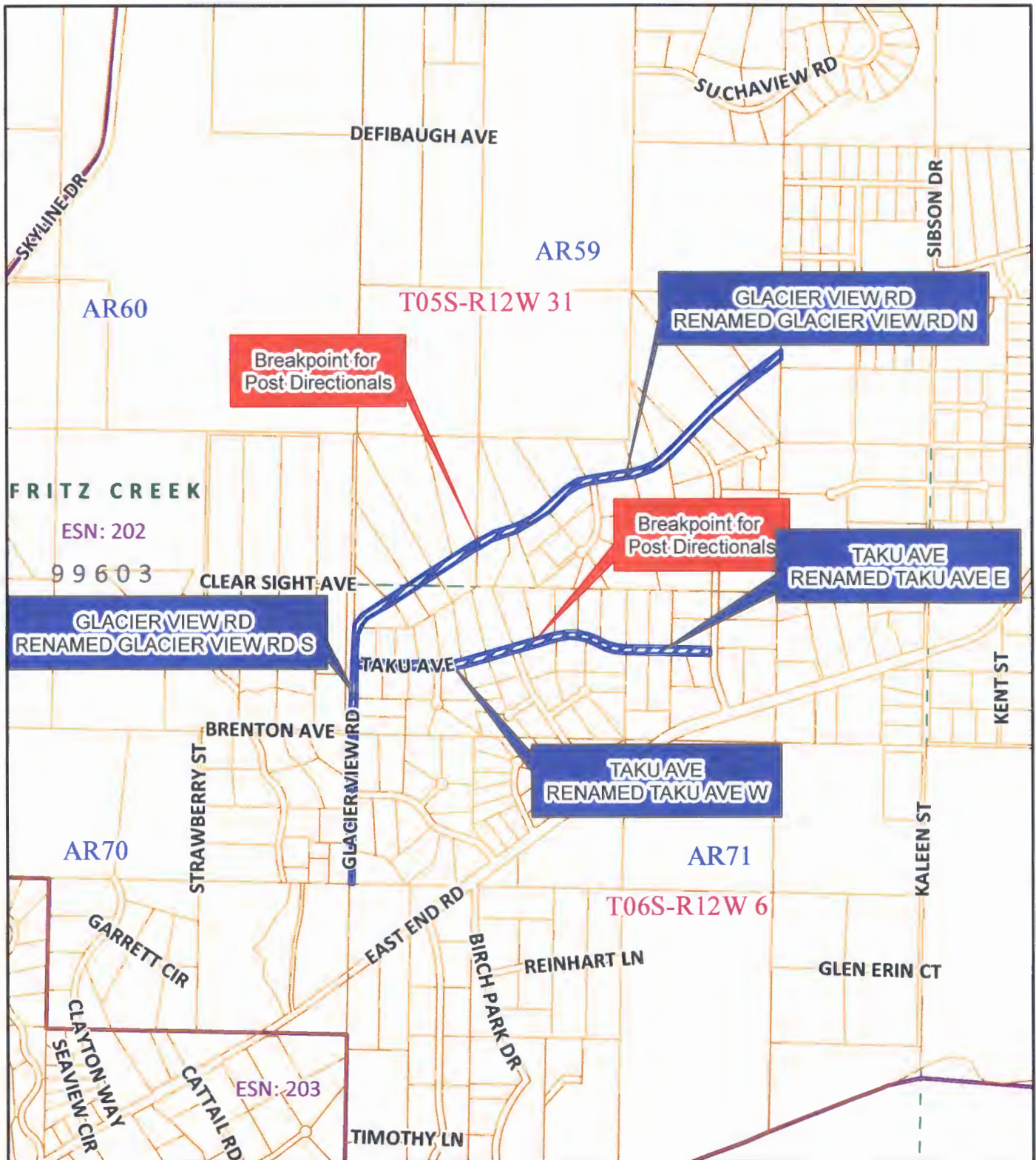

The information depicted hereon is for a graphical representation only of best available sources. The Kenai Peninsula Borough assumes no responsibility for any errors on this map.

08/14/2012

KENAI PENINSULA BOROUGH PLANNING COMMISSION

STREET NAME RESOLUTION 2012-04

GLACIER VIEW RD TO GLACIER VIEW RD N & GLACIER VIEW RD S
TAKU AVE TO TAKU AVE E & TAKU AVE W



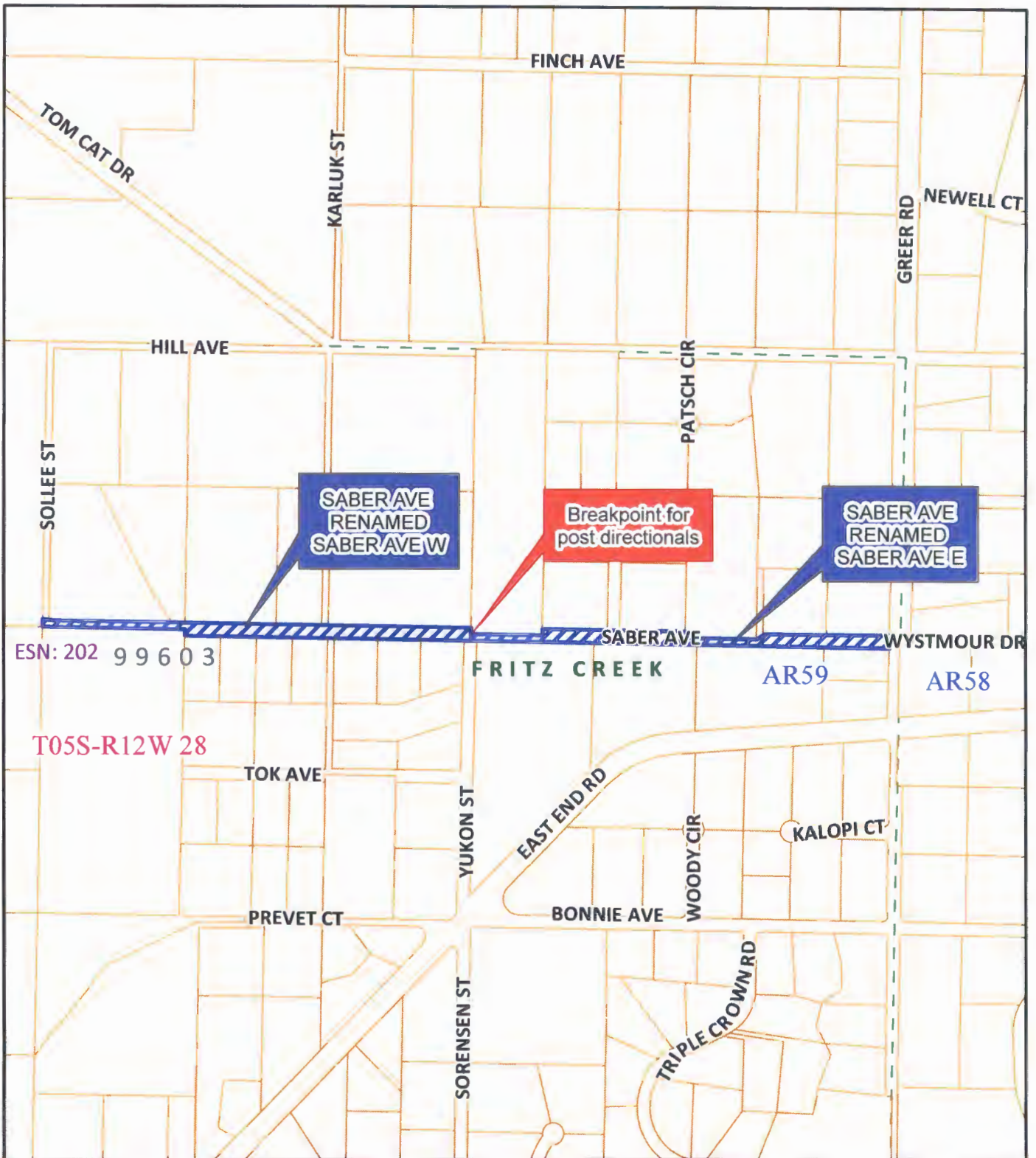

The information depicted hereon is for a graphical representation only of best available sources. The Kenai Peninsula Borough assumes no responsibility for any errors on this map.

08/14/2012

KENAI PENINSULA BOROUGH PLANNING COMMISSION

STREET NAME RESOLUTION 2012-04

SABER AVE TO SABER AVE E & SABER AVE W



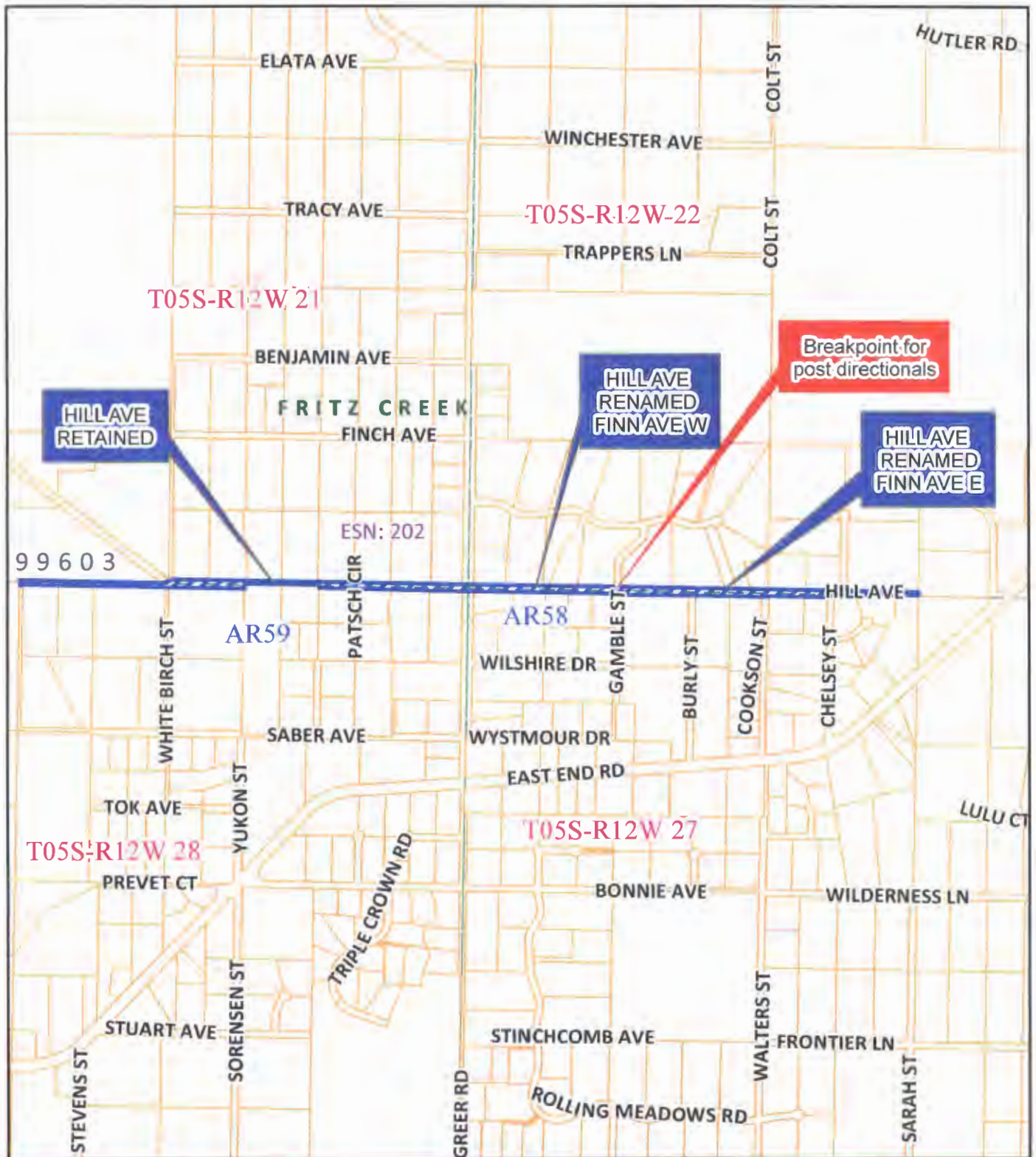

The information depicted hereon is for a graphical representation only of best available sources. The Kenai Peninsula Borough assumes no responsibility for any errors on this map.

08/14/2012

KENAI PENINSULA BOROUGH PLANNING COMMISSION

STREET NAME RESOLUTION 2012-04

HILL AVE (WEST OF GREER RD) RETAINED
 HILL AVE (EAST OF GREER RD) TO FINN AVE E & FINN AVE W

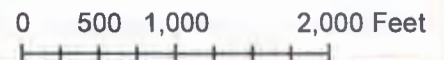

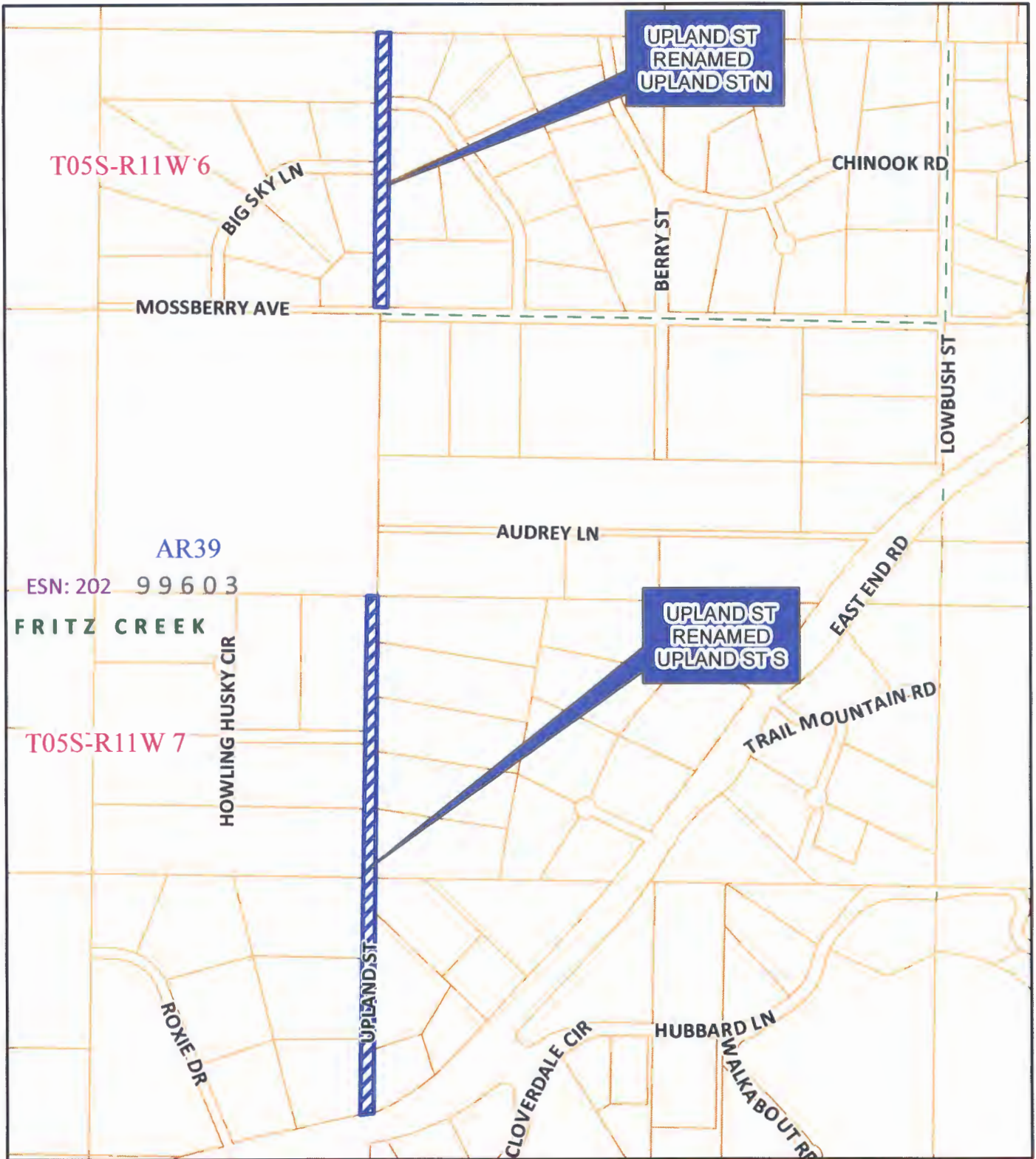

The information depicted hereon is for a graphical representation only of best available sources. The Kenai Peninsula Borough assumes no responsibility for any errors on this map.

08/14/2012

KENAI PENINSULA BOROUGH PLANNING COMMISSION

STREET NAME RESOLUTION 2012-04

UPLAND ST TO UPLAND ST N & UPLAND ST S





The information depicted hereon is for a graphical representation only of best available sources. The Kenai Peninsula Borough assumes no responsibility for any errors on this map.

08/14/2012

KENAI PENINSULA BOROUGH PLANNING COMMISSION

STREET NAME RESOLUTION 2012-04

PITZMAN AVE (EAST OF DIAMOND RIDGE RD) TO BIDARKI DR

0 140 280 560 Feet