

**KENAI PENINSULA BOROUGH
PLANNING COMMISSION RESOLUTION**

RESOLUTION SN 2010-10

**RENAMING CERTAIN PUBLIC RIGHTS-OF-WAY WITHIN SECTION 11, T4S, R15W; WITHIN
EMERGENCY SERVICE NUMBER (ESN) 401**

**RENAMING CERTAIN PUBLIC RIGHTS-OF-WAY WITHIN SECTION 23, T4S, R15W; WITHIN
EMERGENCY SERVICE NUMBER (ESN) 401**

**RENAMING CERTAIN PUBLIC RIGHTS-OF-WAY WITHIN SECTION 1, T7N, R12W; WITHIN
EMERGENCY SERVICE NUMBER (ESN) 501**

**RENAMING CERTAIN PUBLIC RIGHTS-OF-WAY WITHIN SECTION 23, T6N, R12W; WITHIN
EMERGENCY SERVICE NUMBER (ESN) 501**

**RENAMING CERTAIN PUBLIC RIGHTS-OF-WAY WITHIN SECTIONS 27 & 38, T5N, R9W
WITHIN EMERGENCY SERVICE NUMBER (ESN) 302**

WHEREAS, a procedure has been developed to help implement the Enhanced 9-1-1 Street Naming and Addressing project; and

WHEREAS, eliminating duplicate and sound-alike street names will enable 9-1-1 Emergency Services to respond to emergencies in an efficient timely manner, thereby avoiding delays in providing necessary emergency services; and

WHEREAS, on July 19, 2010 public hearings were held by the Kenai Peninsula Borough Planning Commission to address all concerns about the proposed street name changes; and

WHEREAS, Chapter 14.10 of the Kenai Peninsula Borough Code of Ordinances authorizes the Planning Commission to accomplish street name changes by Resolution.

NOW, THEREFORE, BE IT RESOLVED BY THE PLANNING COMMISSION OF THE KENAI PENINSULA BOROUGH:

Section 1. That the rights-of-way listed below is renamed as follows:

| DESCRIPTION | FROM | TO | BASE MAP |
|--|------------------|----------------|-------------|
| a. Old Sterling Hwy partially shown on plats HM74-1067 Stariski Park 1974 Addition & HM79-134 Stariski Park 1979 Addition; T 4S R 15W SECTION 11, Seward Meridian, AK; Off of the Sterling Hwy in the Anchor Point Community; ESN 401 | OLD STERLING HWY | ALTA LOOP | AR01 |
| b. Sunshine Pl dedicated within HM 82-66 Old Pioneer & HM 83-131 Old Pioneer No 2; T 4S R 15W SECTION 23, Seward Meridian, AK; off of Cape | SUNSHINE PL | JODYS BLISS RD | AR29 |

| | | | |
|--|--------------------|------------|--------------|
| Ninilichik Ave in the community of Anchor Point; ESN 401 | | | |
| c. Curry Ln dedicated within KN1406 Nikishka Subdivision No 3 as an unnamed rd; Named Curry Ln by Street Name Resolution 1997-05; T 7N R 12W SECTION 1 Seward Meridian, AK: Off of Kenai Spur Hwy in the Nikiski Community; ESN 501 | CURRY LN | CURRY CIR | NK20 |
| d. Curry Ln dedicated within KN1437 Nikishka Subdivision No 5 as an unnamed rd; Named Curry Ln by Street Name Resolution 1997-05; T 7N R 12W SECTION 1 Seward Meridian, AK: Off of Halliburton Dr in the Nikiski Community; ESN 501 | CURRY LN | BASIL LN | NK20 |
| e. Bird St dedicated as Byrd Dr within KN 77-25 Resubdivision of Tract 4 Heistand Subdivision & KN 2002-33 Bird Homestead Subdivision; Renamed Bird St by SN 2005-05; Partially vacated by KN 2008-138 Bird Homestead Subdivision Part 3; T 5N R9W SECTIONS 27 & 28 Seward Meridian AK: Off of Kanak Ave within the Funny River Community; ESN 302 | BIRD ST | BIRD CIR | KR15 KR16 |
| f. Estelle Ave (West) dedicated within KN 77-25 Resubdivision of Tract 4 Heistand Subdivision & KN 98-50 Pilot's Bend Subdivision Part Four, T 5N R9W SECTION 28 Seward Meridian AK: Off of Funny River Rd within the Funny River Community; ESN 302 | ESTELLE AVE (WEST) | FORE CIR | KR16 |
| g. Birdie Cir dedicated within KN 2002-33 Bird Homestead Subdivision; T 5N R9W SECTION 27 Seward Meridian AK: Off of Estelle Ave within the Funny River Community; ESN 302 | BIRDIE CIR | FORE CIR | KR15 |
| h. Estelle Ave (East) dedicated within KN 2002-33 Bird Homestead Subdivision & KN 2009-97 Bird Homestead Subdivision Part 4; T 5N R9W SECTION 27 Seward Meridian AK: Off of Pioneer Access Rd within the Funny River Community; ESN 302 | ESTELLE AVE (EAST) | ESTELLE CT | KR15 |
| i. Banta St surrounded by Government Lots 56-61 & 72-77; Officially named Banta St by Ordinance 85-35 establishing the first official street name base maps; T 6N R 12W SECTION 23 Seward Meridian, AK; Off of Henley Ave in the Salamatof Community; ESN 501 | BANTA ST | JOBBER ST | KR01 |

Section 2. That according to Kenai Peninsula Borough Code of Ordinance 14.10.030, the official street name map, 1:500 scale series base maps, Anchor River 01 & 29, Nikiski 20, and Kenai River 01, 15, & 16 is hereby amended to reflect these changes.

Section 3. That the map showing the location of the renamed rights-of-way be attached to, and made a permanent part of this resolution.

Section 4. That this Resolution takes effect immediately upon adoption.

ADOPTED BY THE PLANNING COMMISSION OF THE KENAI PENINSULA BOROUGH
THIS 9 DAY OF August 2010.



Phil Bryson, Chairperson
Planning Commission

State of Alaska
Kenai Peninsula Borough

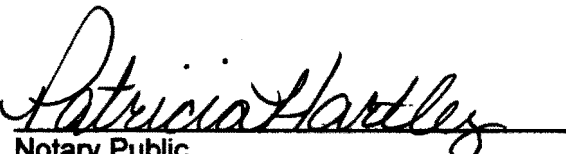
Signed and sworn to (or affirmed) in my presence this 9 day of August
2010 by Phil Bryson

Notary Public

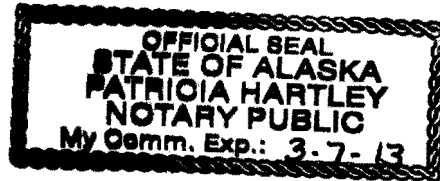
My Commission expires 3-7-13



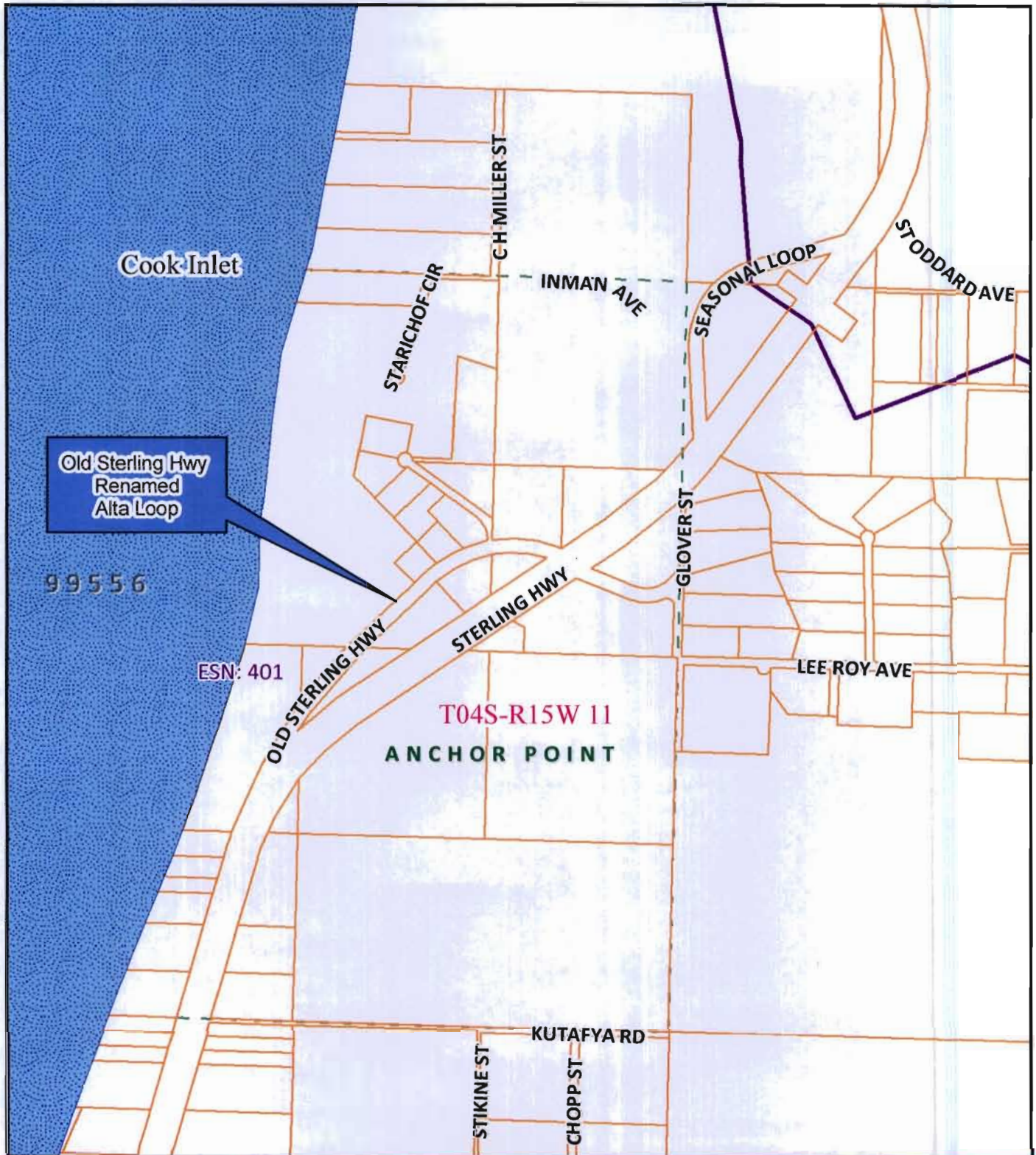

Old Sterling Hwy
Renamed
Alta Loop

99556

ESN: 401

T04S-R15W 11
ANCHOR POINT



The information depicted hereon is for a graphical representation only of best available sources. The Kenai Peninsula Borough assumes no responsibility for any errors on this map.

07/28/2010

Kenai Peninsula Borough Planning Commission

Street Name Resolution 2010-10

Old Sterling Hwy to Alta Loop

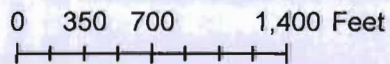



The information depicted hereon is for a graphical representation only of best available sources. The Kenai Peninsula Borough assumes no responsibility for any errors on this map.

07/28/2010

Kenai Peninsula Borough Planning Commission

Street Name Resolution 2010-10

Sunshine Pl to Jody's Bliss Rd



0 185 370 740 Feet

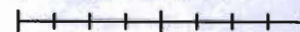

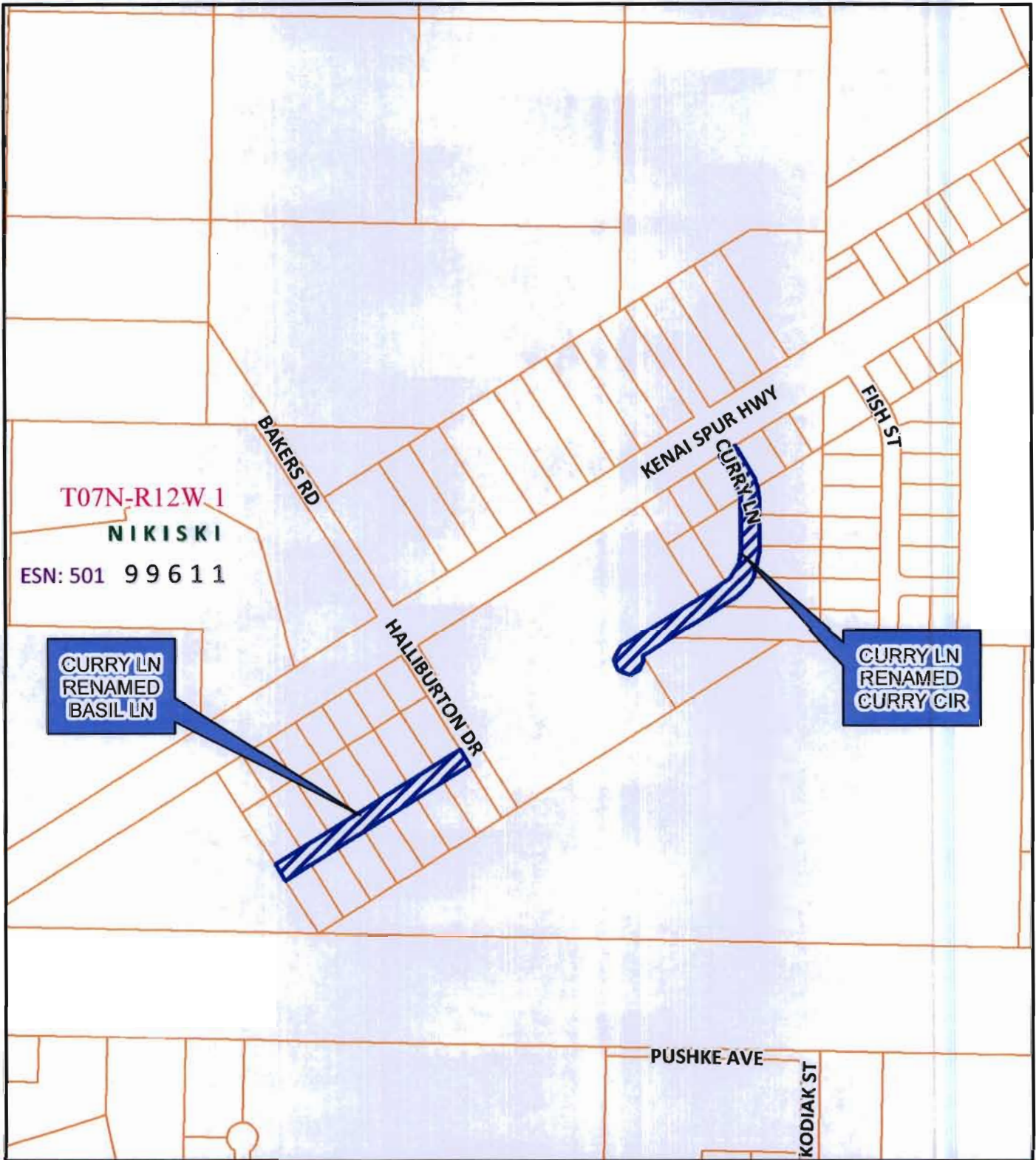

The information depicted hereon is for a graphical representation only of best available sources. The Kenai Peninsula Borough assumes no responsibility for any errors on this map.

07/28/2010

Kenai Peninsula Borough Planning Commission

Street Name Resolution 2010-10



Curry Ln to Basil Ln
Curry Ln to Curry Cir

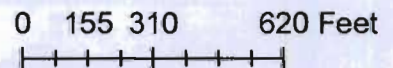

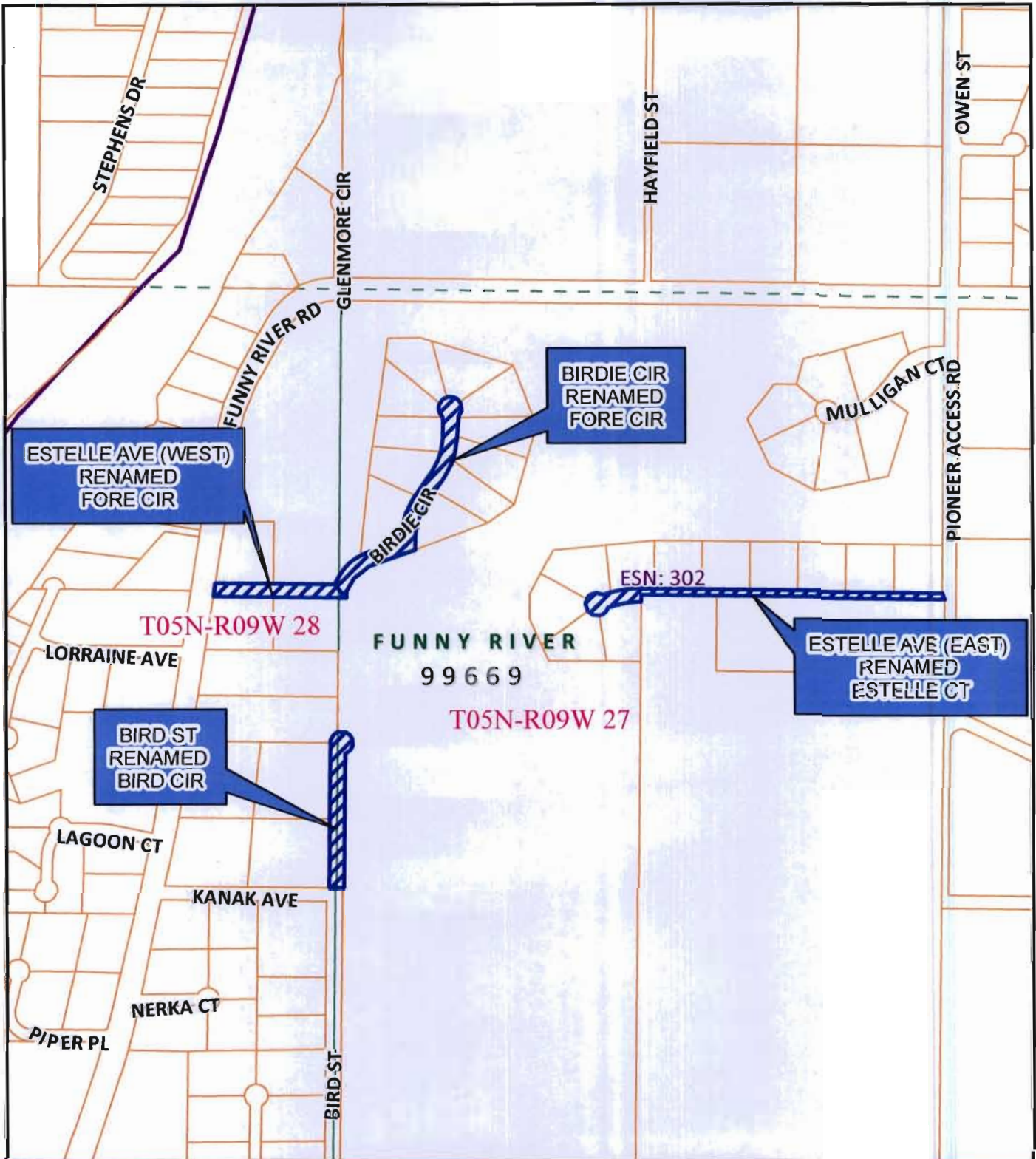

The information depicted hereon is for a graphical representation only of best available sources. The Kenai Peninsula Borough assumes no responsibility for any errors on this map.

07/28/2010

Kenai Peninsula Borough Planning Commission

Street Name Resolution 2010-10

- Bird St to Bird Cir
- Estelle Ave (West) to Fore Cir
- Birdie Cir to Fore Cir
- Estelle Ave (East) to Estelle Ct

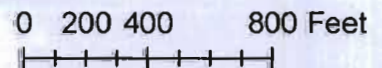

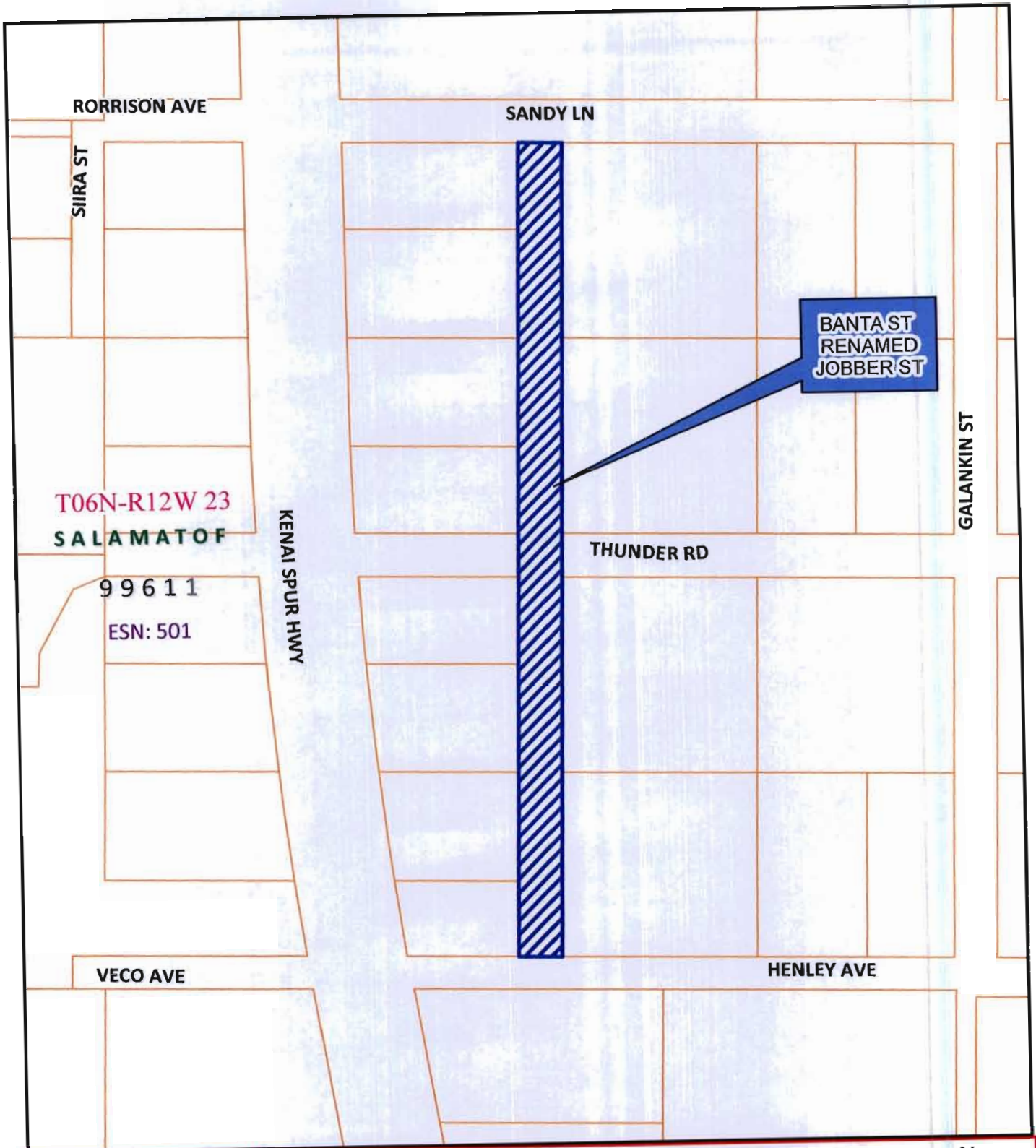

The information depicted hereon is for a graphical representation only of best available sources. The Kenai Peninsula Borough assumes no responsibility for any errors on this map.

07/28/2010

Kenai Peninsula Borough Planning Commission



Street Name Resolution 2010-10

Banta St to Jobber St 0 70 140 280 Feet